

COVERSHEET

Planned document changes:

Briefly:

No planned changes.

Document changes:

Date:	Change:	Rev. after change:
2026-06-08	Details for Extra added.	B
2025-08-11	Photo added.	A
2025-04-14	New document.	-

Readers note:

 Indicates instruction.

 Represents Hose.

Dashed lines for overview, mounts
on other pages/assemblies.

EC204B - Hitch CW05GP GR05

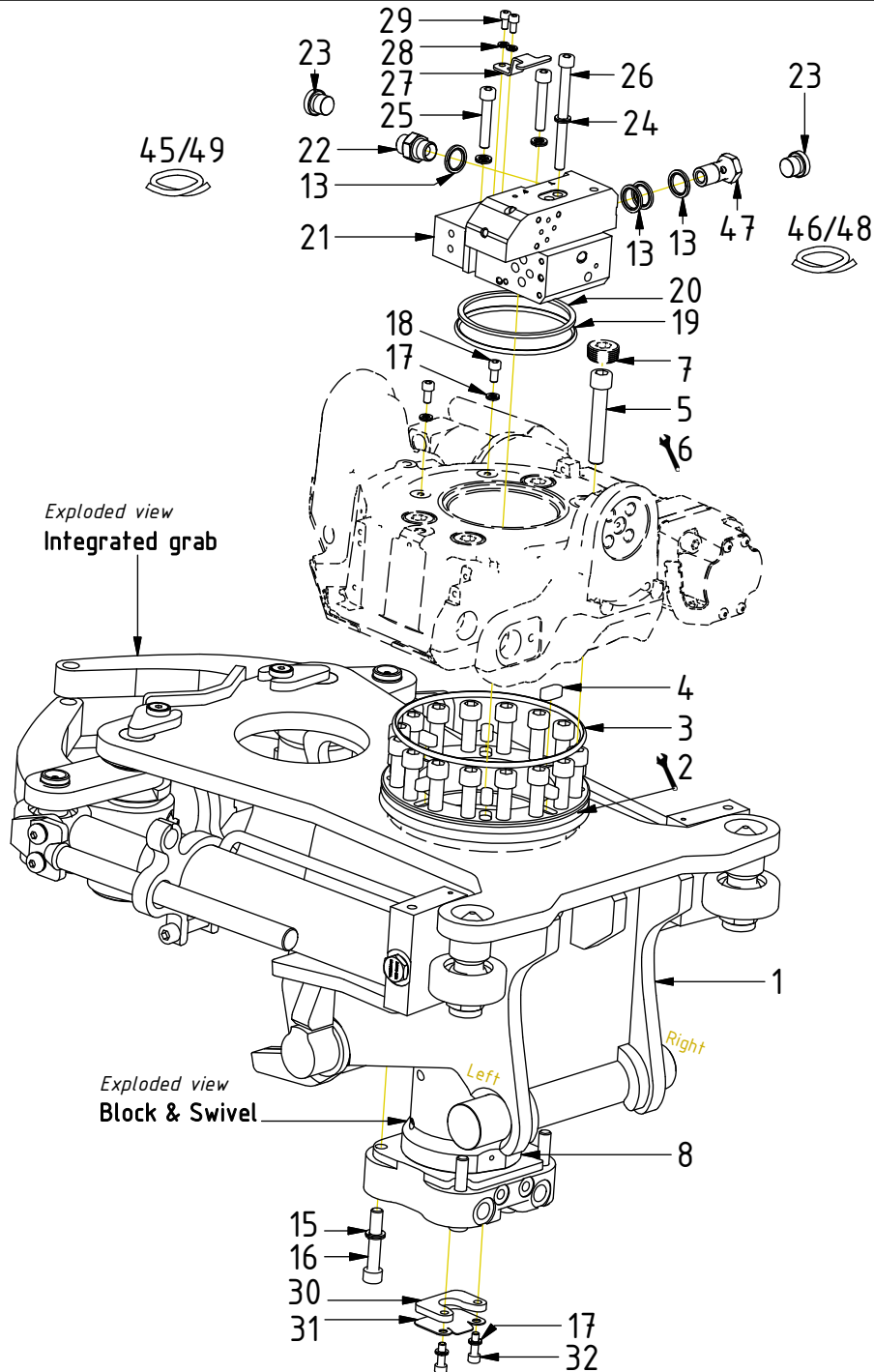

POS	DESCRIPTION	PART	QTY	COMMENTS
1	Quick hitch CW05GP GR05 EC204B	1078752	1	
2	Grease the ring			
3	O-ring 155x5,0	7001935	1	
4	Feather key 10x8x22	6000416	8	
5	Screw MC6S M12x70 12.9 ZFSHL	611517	16	Torque: 136Nm
6	Torque tighten rotator frame to hitch. Rotate to access all holes			
7	Pipe plug DIN 906 M22x1,5	7000457	4	Part of rotator frame
8	Connection block & swivel CW Compl.	1080474	1	
9	O-ring 5,28x1,78	7001568	2	
10	O-ring 7,66x1,78	7001939	2	
11	O-ring 12,42x1,78	710973	2	
13	Washer GBR06 3/8	710703	10	QTY depends on config. (6-10)
15	Washer NL 10mm	611041	4	
16	Screw MC6S M10x55 12.9 ZFSHL	612022	4	
17	Washer NL 6mm	611039	4	
18	Screw MC6S M6x12 12.9 ZFSHL	6000352	2	
19	O-ring 96x4,0	7001941	1	
20	Ring o-ring protection 91x100/3	1075886	1	
21	Valve block EC204B	1078622	1	Part of control system assy.
22	Adapter 136-06-06 (3/8")	710106	1	For DC2
23	Plug 70125-06 (3/8")	711504	2	For ss9, ss0
24	Washer NL 8mm	611040	6	
25	Screw MC6S M8x45 12.9	610438	5	
26	Screw MC6S M8x95 12.9	610446	1	
27	Cover plate valve block	1077615	1	
28	Washer NL 5mm	611038	2	
29	Screw MC6S M5x10 12.9	610594	2	
30	Plate cable steering QSM	1066142	1	
31	Plate Steering cable Slip ring	1066144	1	
32	Screw MC6S M6x20 8,8 FZB	610310	2	
45	Hose hydraulic motor a (DC2)	7001988	1	
46	Hose hydraulic motor b (DC2)	7001987	1	
47	Banjo bolt 4451-06 (3/8")	710272	1	For DC2
48	Hose Rotation a (ss9, ss0)	7002025	1	
49	Hose Rotation b (ss9, ss0)	7002026	1	

Between swivel & valve block:

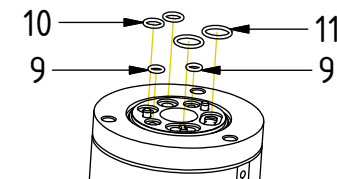

EC204B - Hitch CW05GP GR05

POS	DESCRIPTION	PART	QTY	COMMENTS
12	Adapter 401-02-02 90° (1/8")	710293	3	
13	Washer GBR06 3/8	710703	10	QTY depends on config. (6-10)
14	Adapter 135-04-06 (1/4"-3/8")	710118	2	
33	Hose Lock	7002069	2	
34	Washer GBR04 1/4	710702	5	QTY: 4 part of Integrated grab
35	Adapter 234-04-02	710236	1	
36	Adapter 401-02-04 90° (1/8"-1/4")	7001096	1	
37	Hose Grab Internal	7002066	2	
38	Adapter 853-04-99 (1/4")	710184	2	
39	Hose Grab Long	7002067	2	
40	Hose Grab Short	7002068	2	
41	Adapter 138-04-29 (1/4")	710135	4	Part of Integrated grab
42	Adapter extension 3/8"	1058386	2	
43	Quick coupling 3/8"	790113	2	
44	Dust protection 3/8"	790120	2	

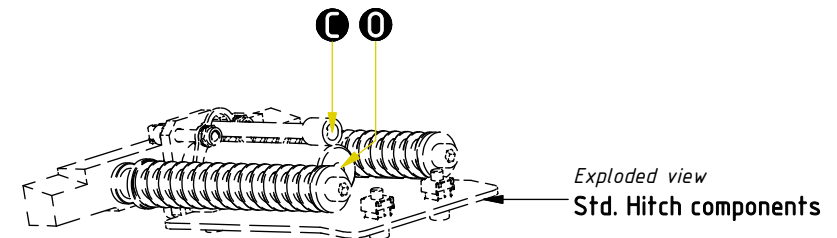
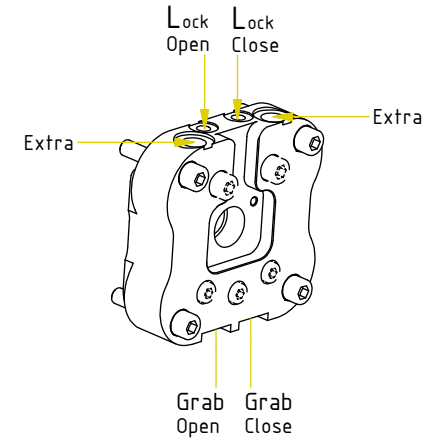
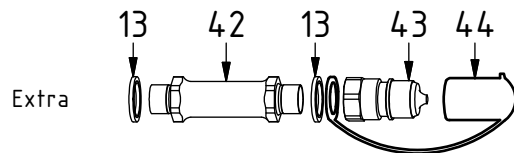
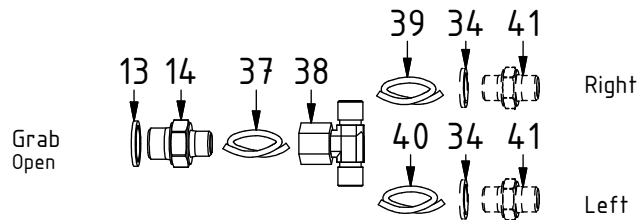
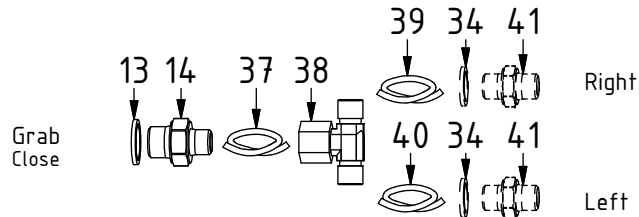
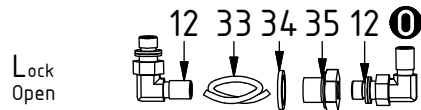
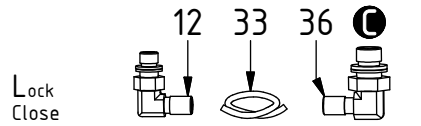

POS in order of assembly

POS	DESCRIPTION	PART	QTY	COMMENTS
33	Hose Lock	7002069	2	
37	Hose Grab Internal	7002066	2	
39	Hose Grab Long	7002067	2	
40	Hose Grab Short	7002068	2	
45	Hose hydraulic motor a (DC2)	7001988	1	
46	Hose hydraulic motor b (DC2)	7001987	1	
48	Hose Rotation a (ss9, ss0)	7002025	1	
49	Hose Rotation b (ss9, ss0)	7002026	1	

Photo needed: without cyl.

DC2

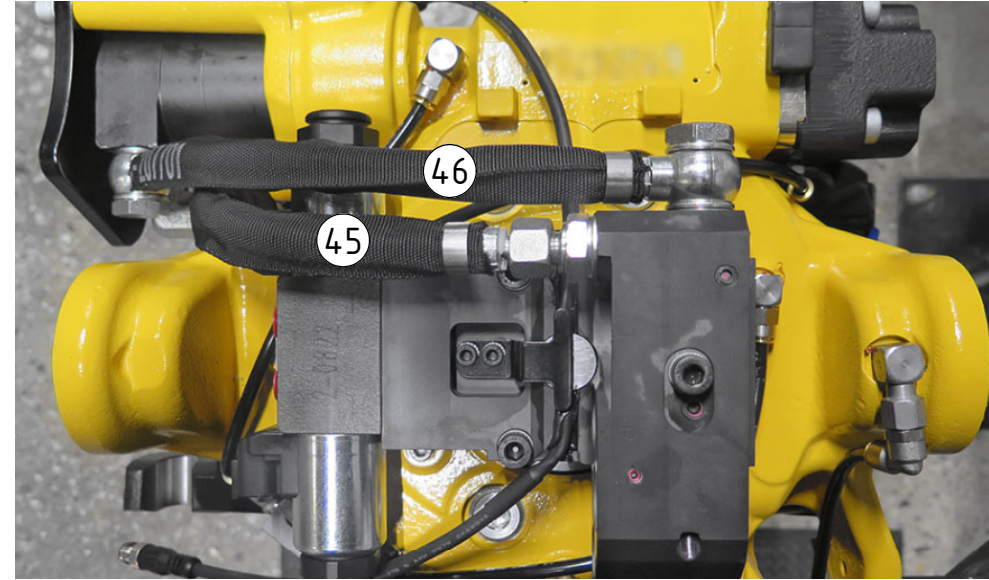

Photo needed: with cyl.

ss9, ss0

