

## Planned document changes:

**Briefly:**

No planned changes.

## Document changes:

Date:	Change:	Rev. after change:
2026-04-22	Photos added.	H
2026-04-01	EC314 added.	G
2025-12-16	EC333 added.	F
2025-11-21	Photos added.	E
2025-11-13	EC326 added.	D
2025-08-26	EC309 added.	C
2024-03-12	Photos updated.	B
2024-03-01	Photos added.	A
2023-06-30	New document.	-

*Readers note:*

Indicates instruction.



Represents Hose.

Dashed lines for overview, mounts  
on other pages/assemblies.

8-9  
11

EC309-EC333

POS	DESCRIPTION	PART	QTY	COMMENTS
1	Magnet screw - Rot./Tilt sensor	8001547	2	Loxeal 83-52. Torque: 10Nm
2	Rotation sensor	8001543	1	White side towards magnet
3	Tilt angle sensor	8001544	1	White side towards magnet
4	K6S M4x16 10.9 FZB	6000368	4	Loxeal 55-02
5	Connection cable tilt sensor 600mm	8001610	1	For EC309
6	Connection cable tilt sensor 1200mm	8001611	1	For EC314-EC333
7	Y-split M12 EVC614	1069559	1	
8	Rubber steel clamp $\varnothing 6$	6000027	1	For EC326-EC333
9	Rubber steel clamp $\varnothing 14$	613009	1	For EC326-EC333
10	Screw MC6S M5x10 12.9	610594	2	For EC326-EC333

POS in order of assembly

Exploded view  
Std. Top components

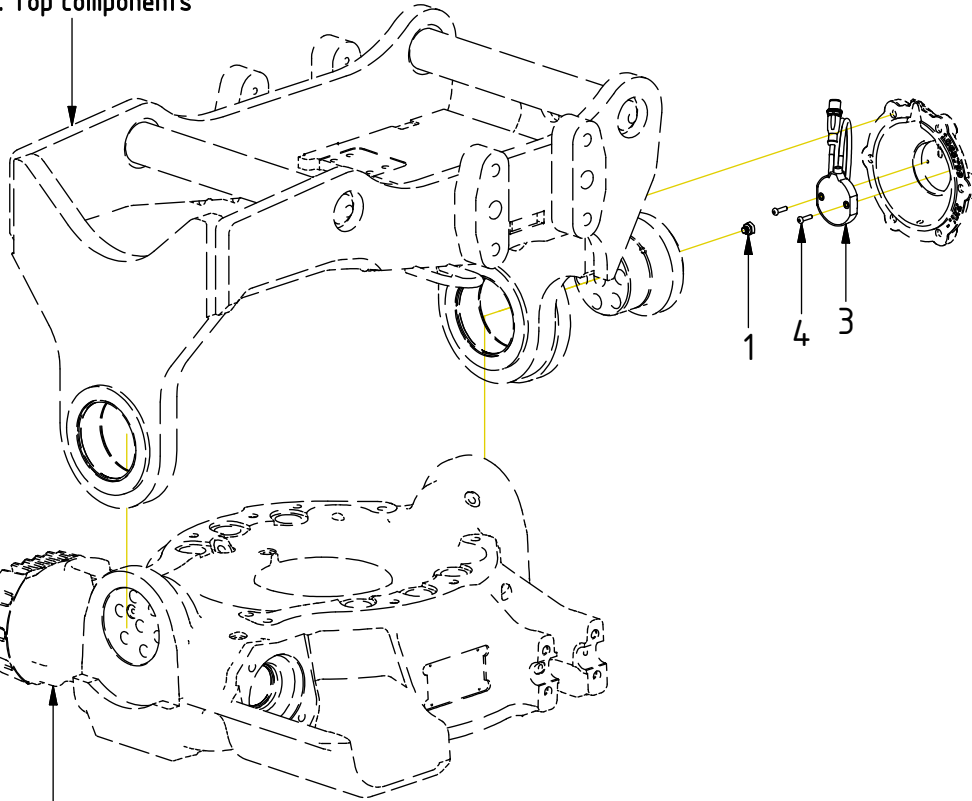

DC3:

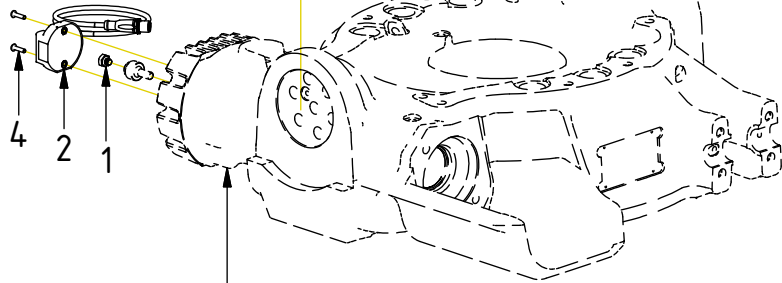
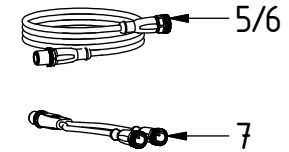

Exploded view  
Rotator frame

EC309

POS	DESCRIPTION	PART	QTY	COMMENTS
2	Rotation sensor	8001543	1	White side towards magnet
3	Tilt angle sensor	8001544	1	White side towards magnet
5	Connection cable tilt sensor 600mm	8001610	1	For EC309
7	Y-split M12 EVC614	1069559	1	
●	Use cable ties			

POS in order of assembly

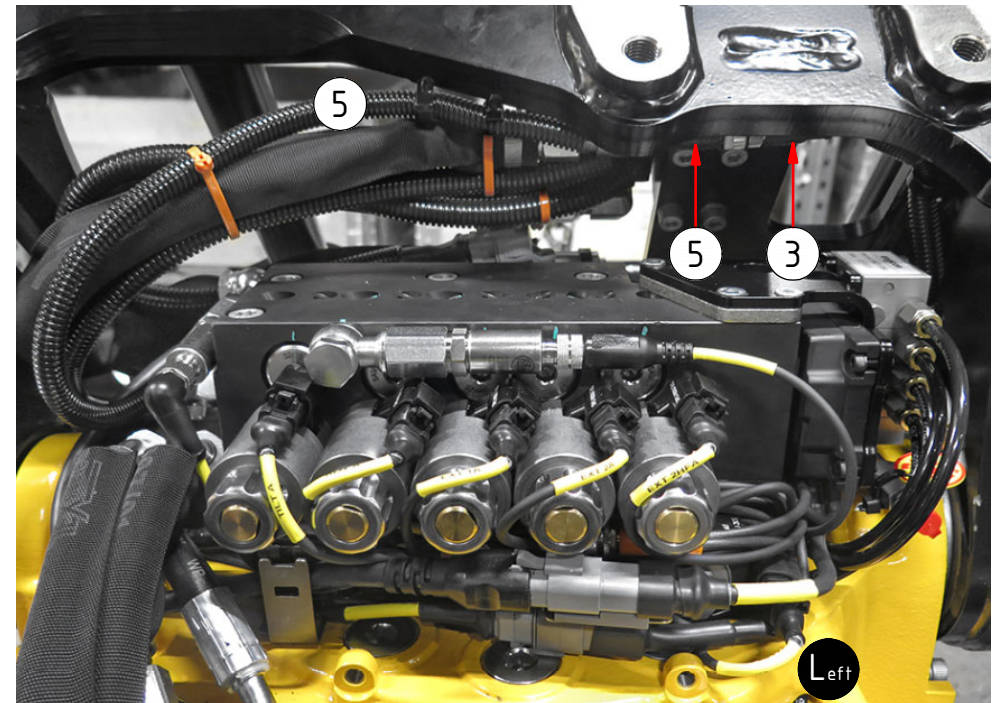
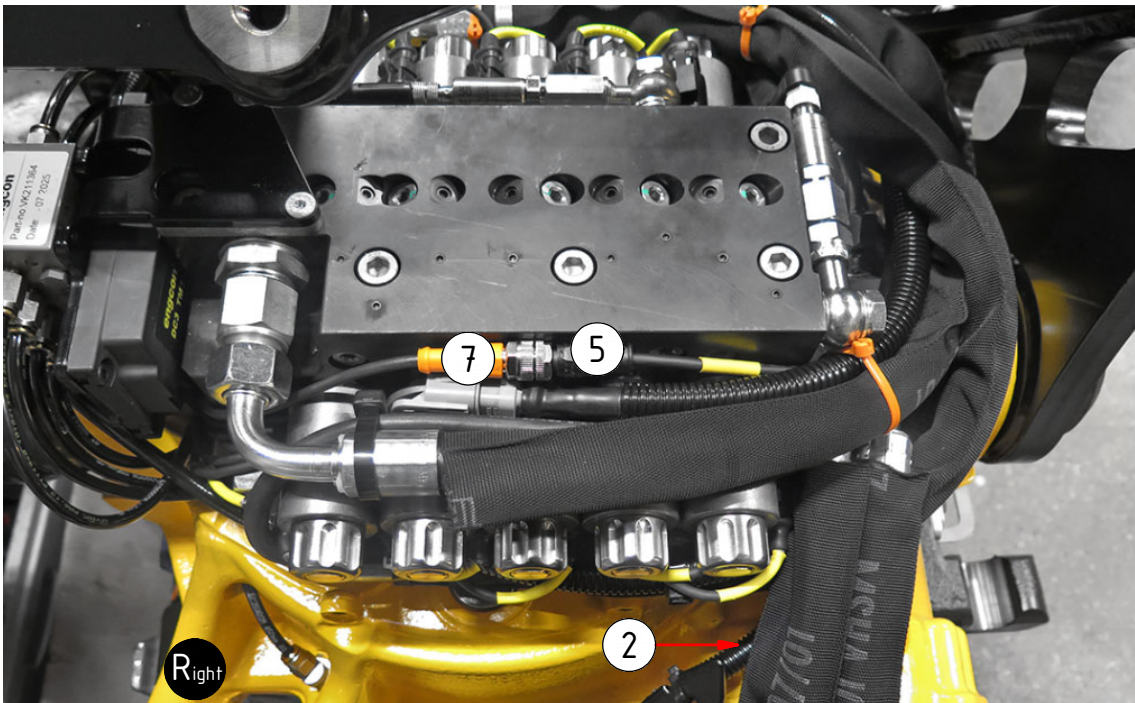
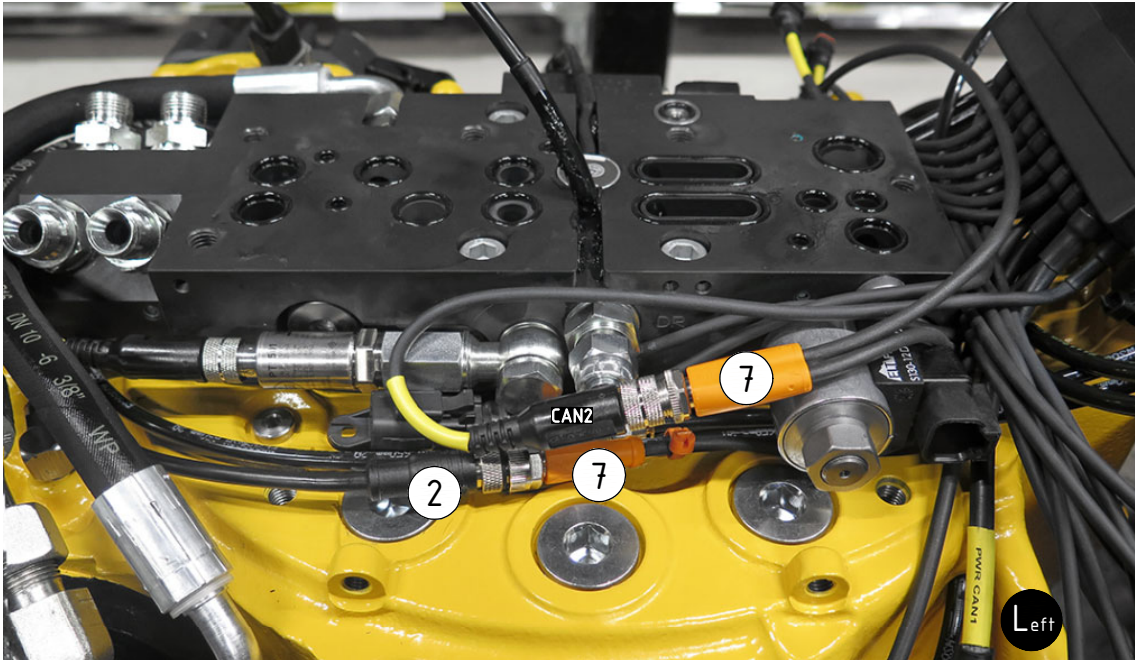

EC314

POS	DESCRIPTION	PART	QTY	COMMENTS
2	Rotation sensor	8001543	1	White side towards magnet
3	Tilt angle sensor	8001544	1	White side towards magnet
6	Connection cable tilt sensor 1200mm	8001611	1	For EC314-EC333
7	Y-split M12 EVC614	1069559	1	
●	Use cable ties			

POS in order of assembly

Photo needed: (left side)  
 POS.2 connects to POS.7 connects  
 to TM module from ss, to sensors

Photo needed: (right side)  
 POS.7 connects to POS.6  
 (if possible also POS.6 to POS.3)

Photo needed:  
 POS.3 connects to POS.6 on top part

EC319

POS	DESCRIPTION	PART	QTY	COMMENTS
2	Rotation sensor	8001543	1	White side towards magnet
3	Tilt angle sensor	8001544	1	White side towards magnet
6	Connection cable tilt sensor 1200mm	8001611	1	For EC314-EC333
7	Y-split M12 EVC614	1069559	1	
●	Use cable ties			

POS in order of assembly

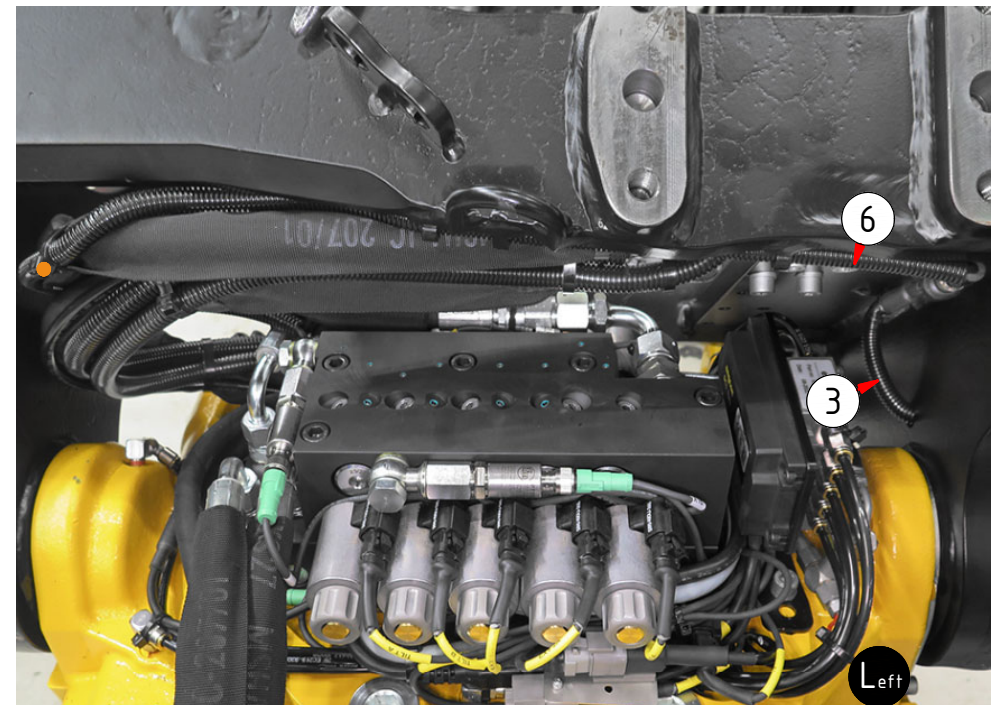
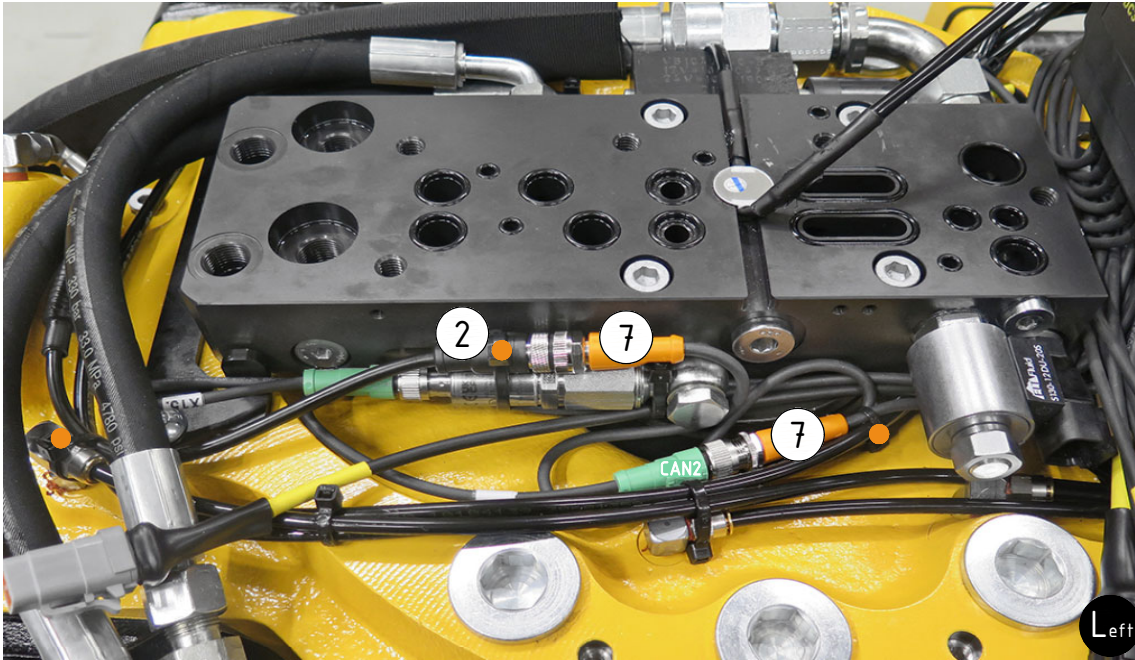

EC326-EC333

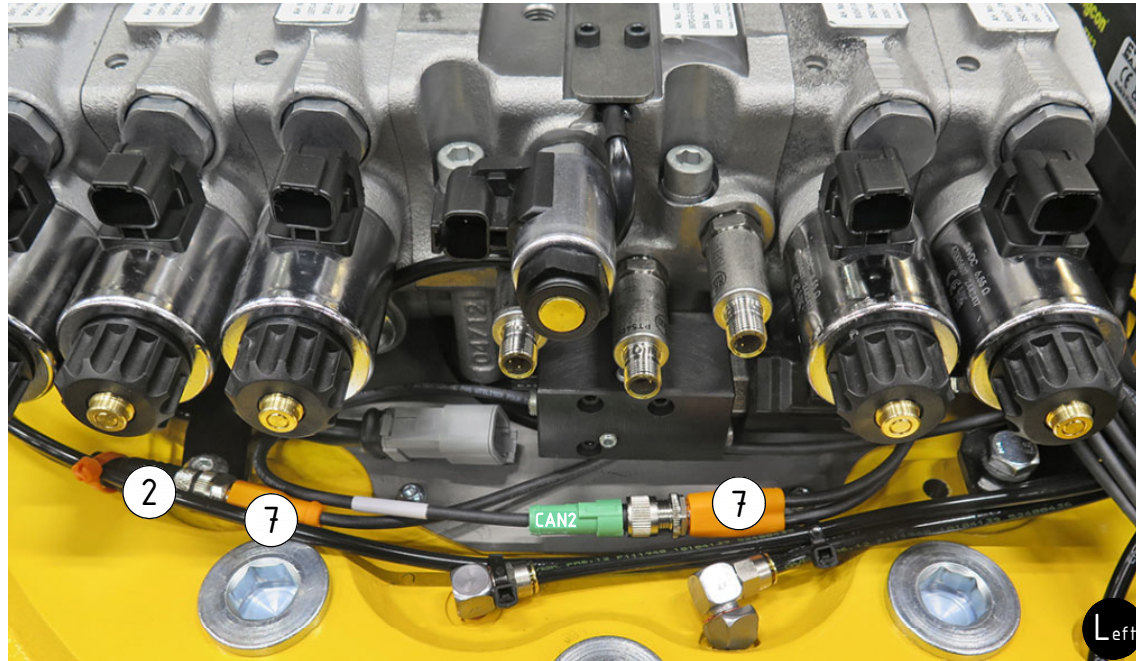

POS	DESCRIPTION	PART	QTY	COMMENTS
2	Rotation sensor	8001543	1	White side towards magnet
3	Tilt angle sensor	8001544	1	White side towards magnet
6	Connection cable tilt sensor 1200mm	8001611	1	For EC314-EC333
7	Y-split M12 EVC614	1069559	1	
8	Rubber steel clamp ø6	6000027	1	For EC326-EC333
9	Rubber steel clamp ø14	613009	1	For EC326-EC333
●	Use cable ties			

POS in order of assembly

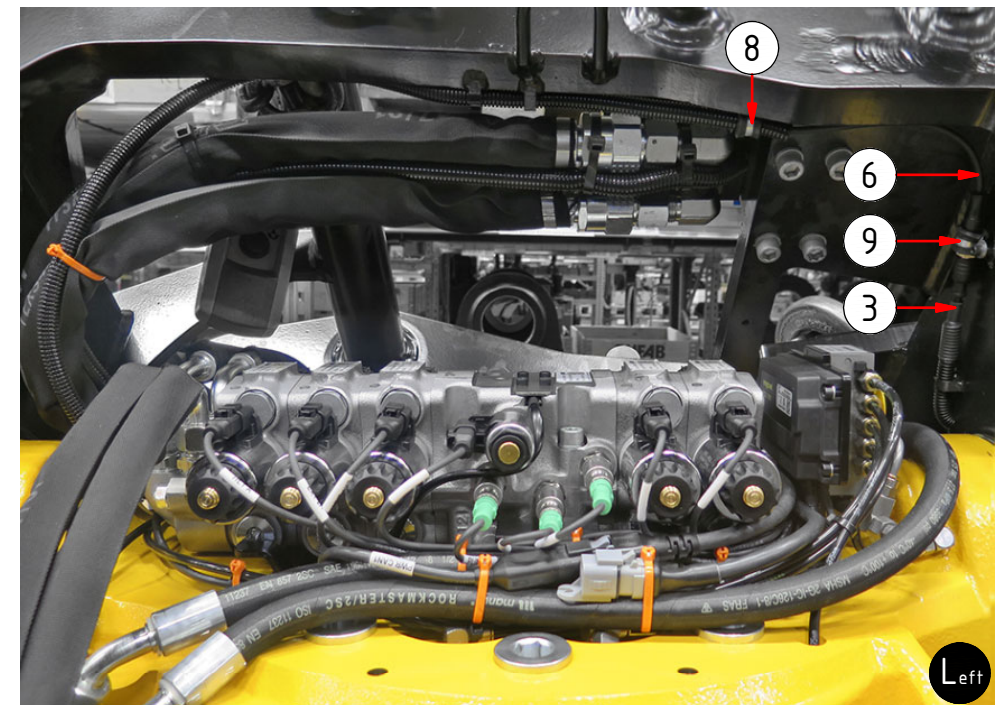
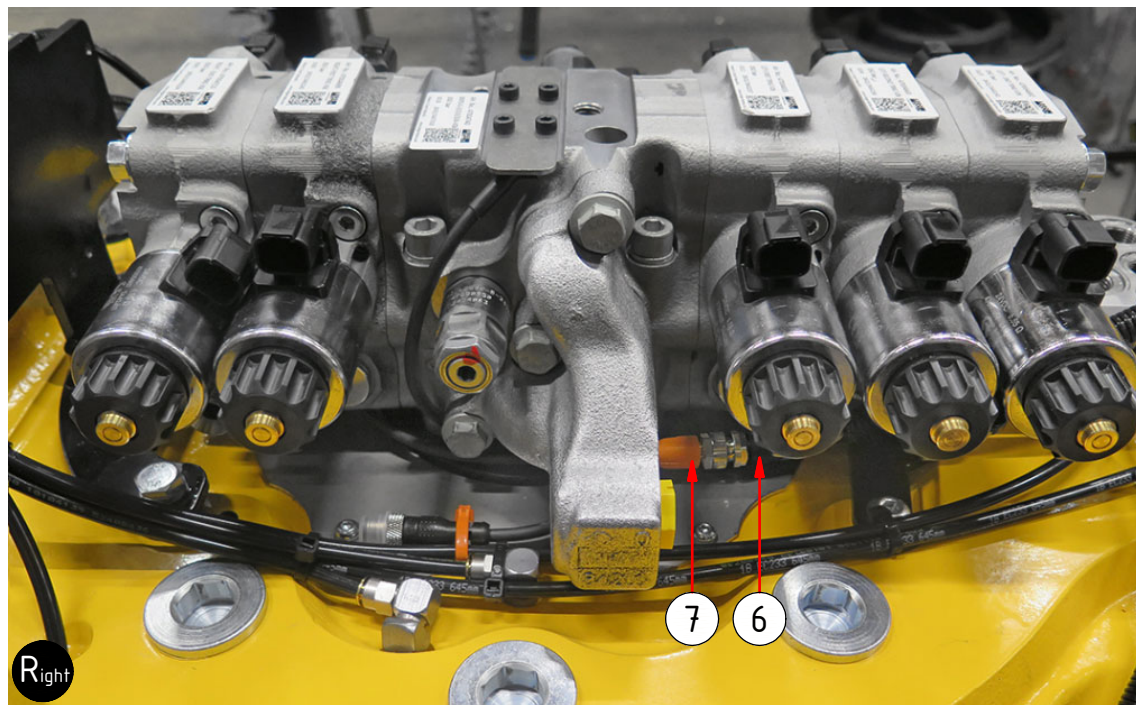

Right

Left