

EC219 ECHF - UNI Top part

COVERSHEET

Planned document changes:

Breifly:

Swap description for POS.2 & 3.
Move main feed 1/2" to correct hole size on terminal overview.
Add photos for option feed 1/2", same as QS60 Top part.

Document changes:

Date:	Change:	Rev. after change:
2020-01-27	Photos added.	D
2018-07-31	Layout/irrelevant.	C
2018-05-21	Layout/irrelevant.	B
2018-04-16	Layout/irrelevant.	A
2017-09-01	New instruction.	-

EC219 ECHF - UNI Top part

POS	DESCRIPTION	PART	QTY	COMMENTS
1	Top part UNI is selected via engcon		1	
2	Axle rotator leg	1024491	2	For EC219R
3	Rotator support EC219R S1	1011553	2	For EC219R

POS in order of assembly

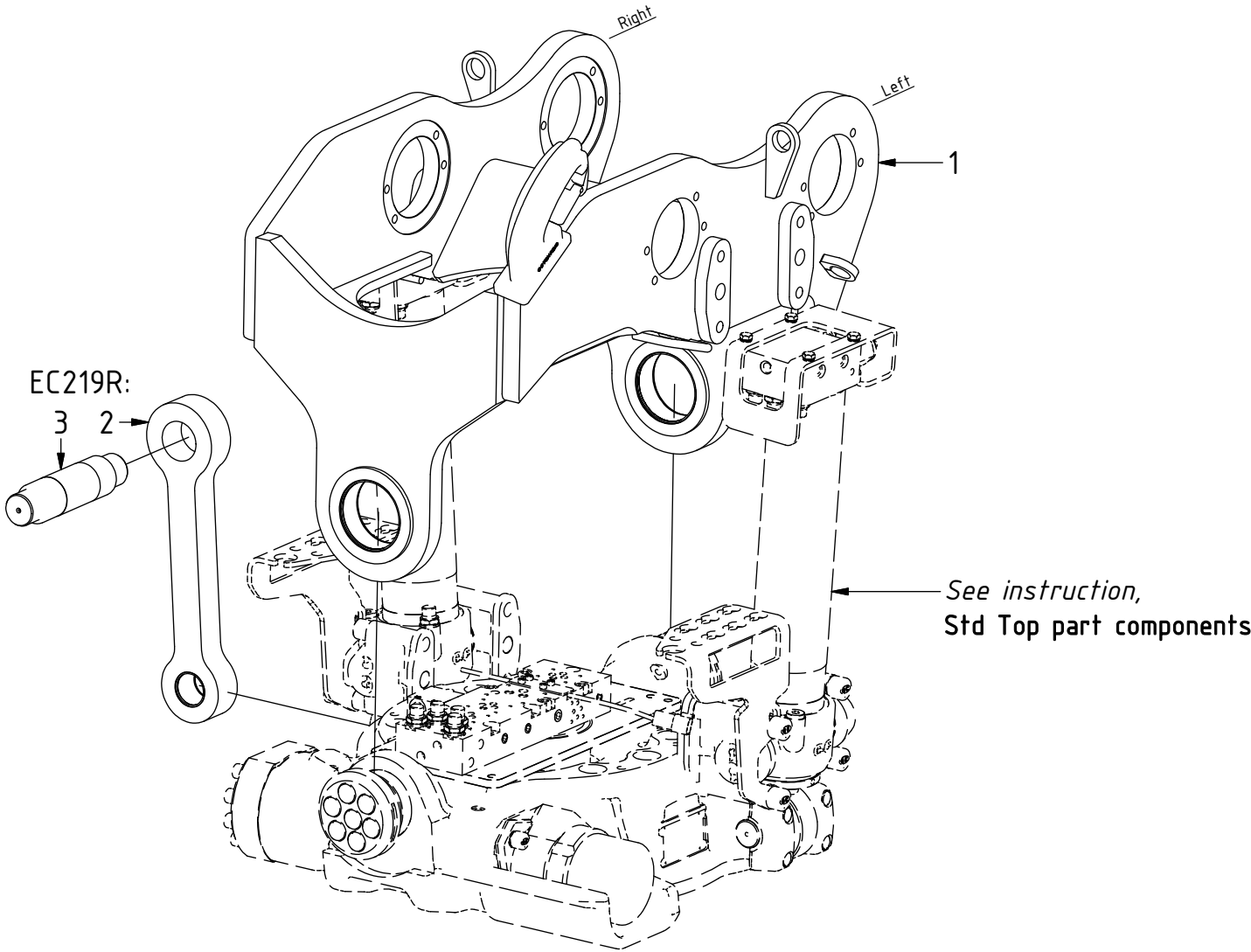

EC219 ECHF - UNI Top part

P = 4
T = 4

FEED
3/4" (Std)

Main Feed

POS	DESCRIPTION	PART	QTY	COMMENTS
4	Use washer, adapter, nut: POS.5, 6, 7			
5	Washer NL 1"	611095	2	
6	Adapter 1260-12-12 (3/4")	712210	2	
7	Bulkhead adapter nut 1270-12	712211	2	
8	Adapter 407-12-12 90° (3/4")	7000010	1	Applies only to Feed Right/Left
9	Hose Bridge Feed Right	7000144	1	
10	Hose Bridge Feed Left	7000143	1	
	Attach feed hoses from control system			(a & b represents channels on feed block)

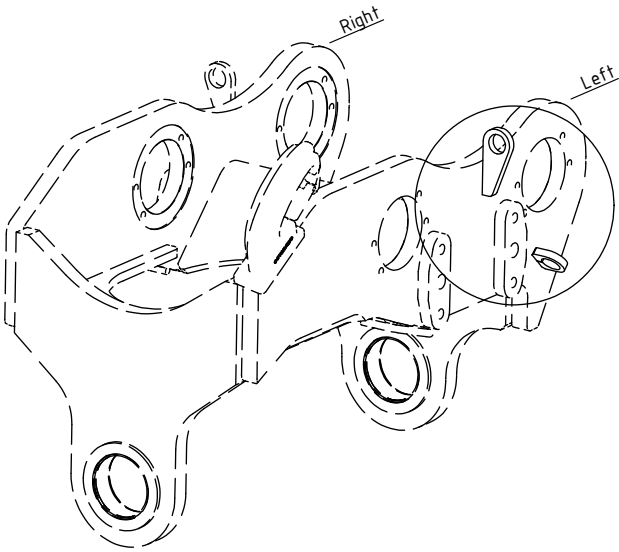
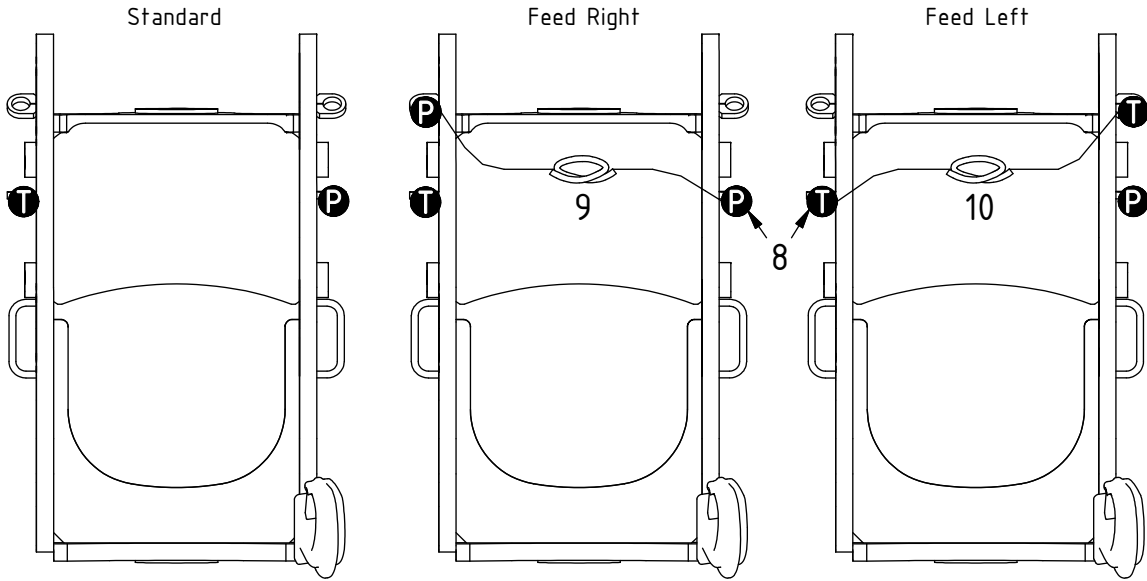

EC219 ECHF - UNI Top part

- P** = 11
- T** = 11
- R** = 15
- L** = 19
- tilt** = 15

FEED
1/2"

Main Feed

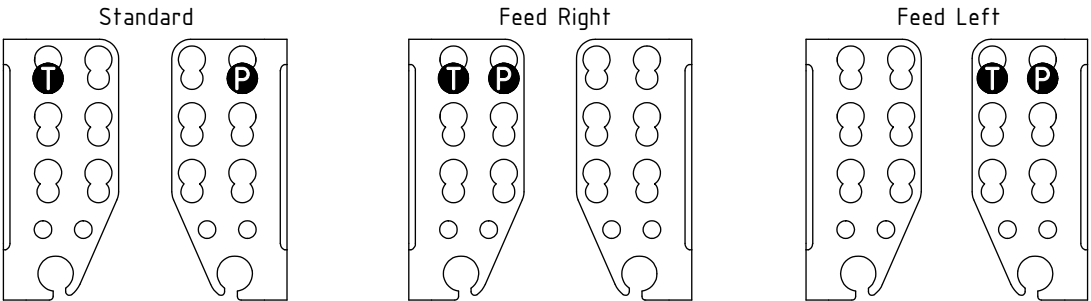

Rotation

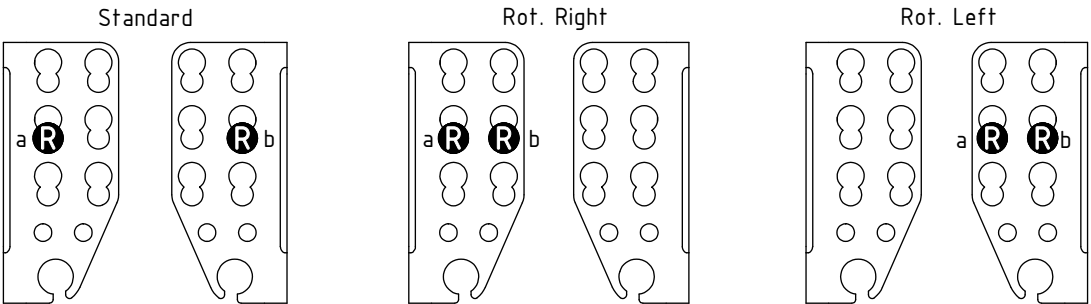

Lock (SQ)

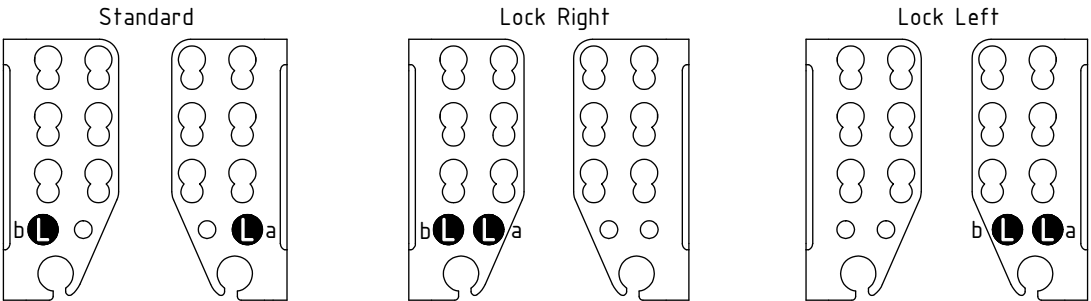

Tilt (ST)

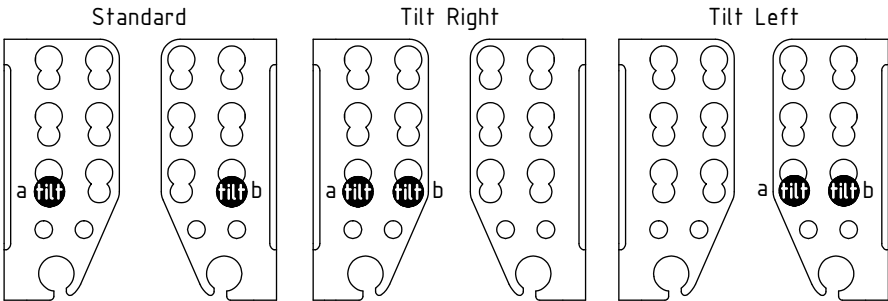

POS	DESCRIPTION	PART	QTY	COMMENTS
11	Use washer, adapter, nut: POS.12, 13, 14			
12	Washer NL 20mm	611098	2	
13	Adapter 1260-08-08 (1/2")	710244	2	
14	Bulkhead adapter nut 1270-08	710254	2	
15	Use washer, adapter, nut: POS.16, 17, 18			QTY depends on config. (2-4)
16	Washer NL 16mm	611044	2-6	
17	Adapter 1260-06-32 (3/8")	710242	2-6	
18	Bulkhead adapter nut 1270-06	710252	2-6	
19	Use washer, adapter, nut: POS.20, 21, 22			
20	Washer NL 1/2"	611096	2	
21	Adapter 1260-04-04 (1/4")	710240	2	
22	Bulkhead adapter nut 1270-04	710250	2	
Attach feed hoses from control system				(a & b represents channels on feed block)

EC219 ECHF - UNI Top part

FEED
3/4" (Std)

POS	DESCRIPTION	PART	QTY	COMMENTS
8	Adapter 407-12-12 90° (3/4")	7000010	1	Applies only to Feed Right/Left
9	Hose Bridge Feed Right	7000144	1	
10	Hose Bridge Feed Left	7000143	1	
23	Cable tie 7,8x360	1021587	2	
Attach feed hoses from control system				(a & b represents channels on feed block)

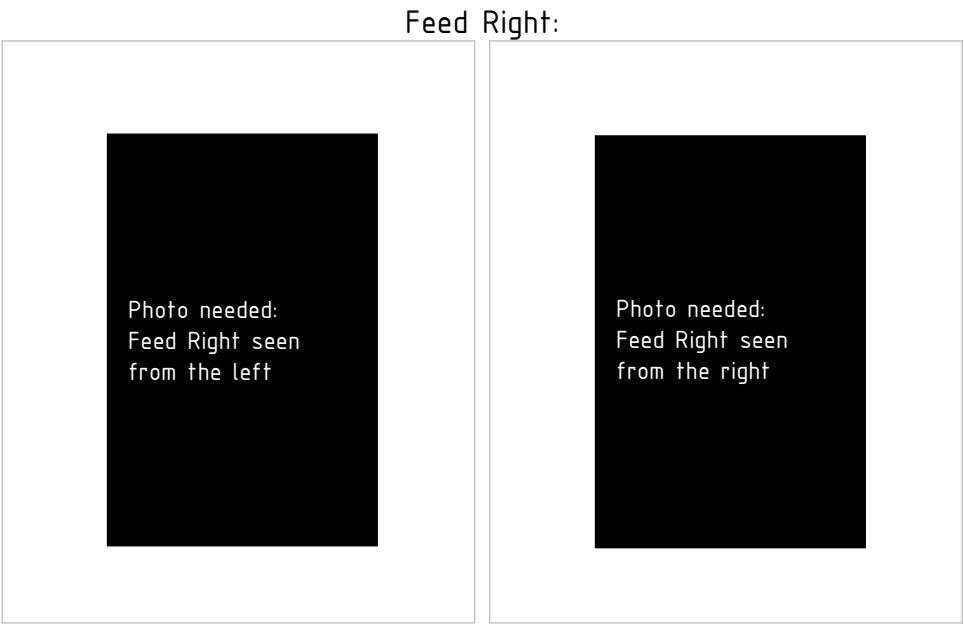
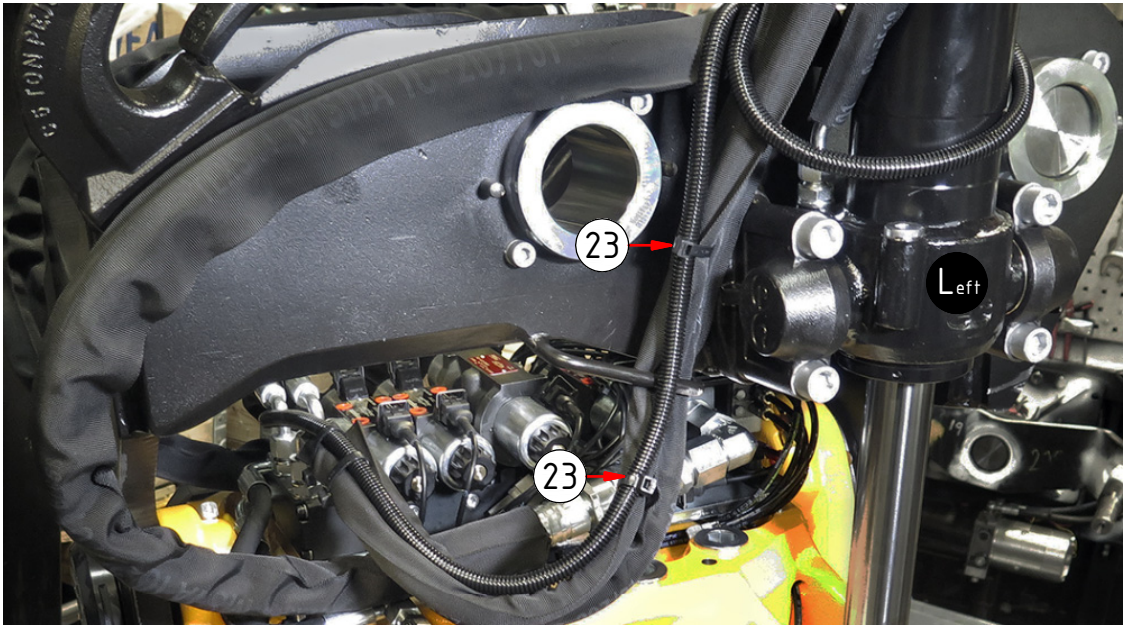
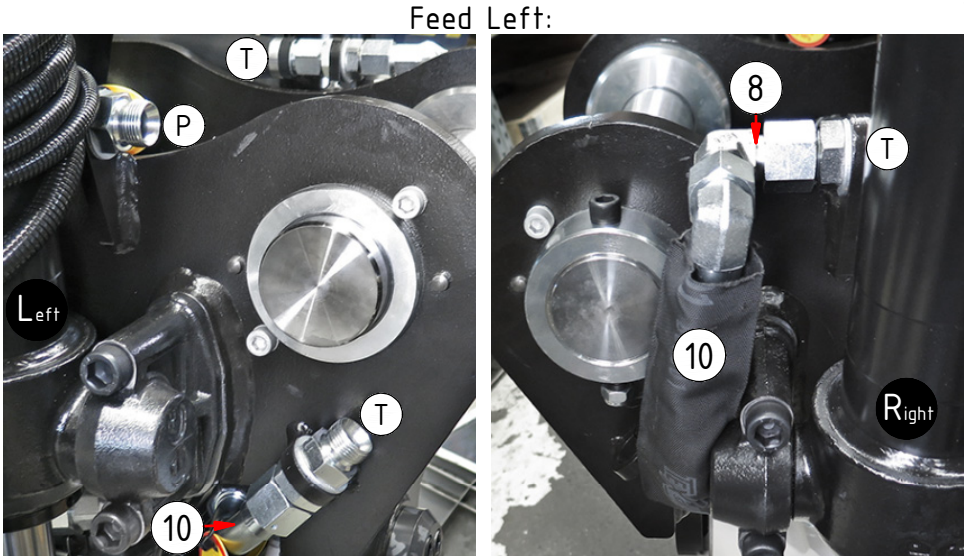
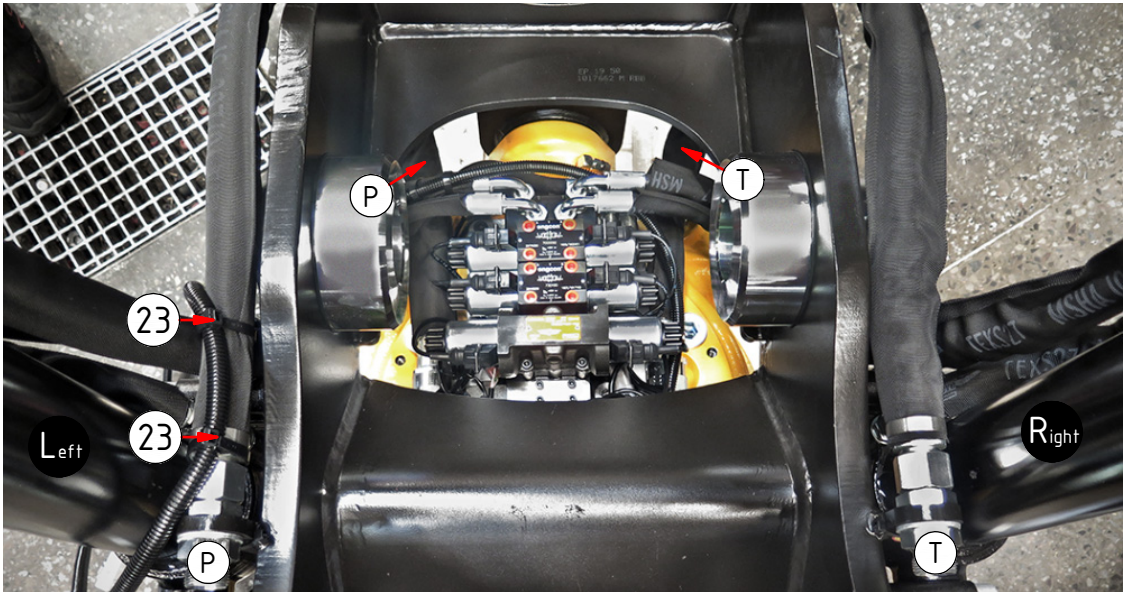

Dashed lines for overview, mounts on other pages/assemblies. indicates instruction. represents hose.

EC219 ECHF - UNI Top part

FEED
1/2"

POS	DESCRIPTION	PART	QTY	COMMENTS
23	Cable tie 7,8x360	1021587	2	
	Attach feed hoses from control system			(a & b represents channels on feed block)

Feed Left:

Photo needed: option 1/2"
Feed Right+Left (std)

Functions according to control system

Photo needed: option Feed Left

Functions according to control system

Photo needed: option 1/2"
Feed Right+Left (std)
with cable ties

Functions according to control system

Feed Right:

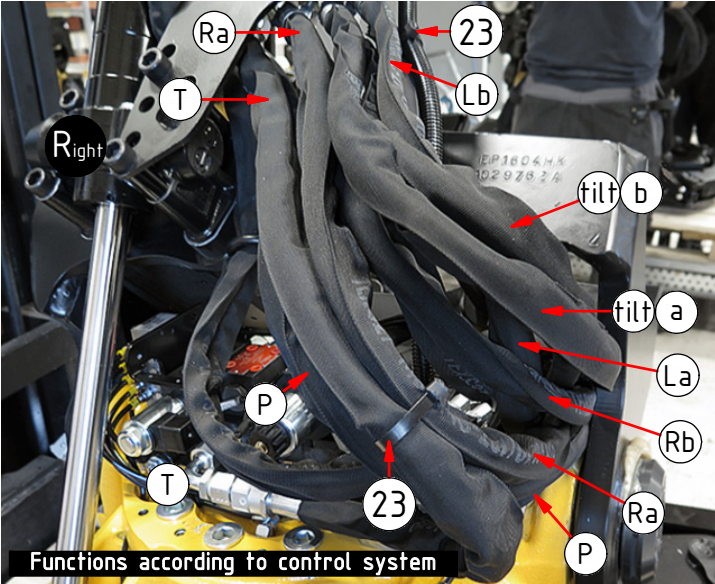

New photo needed:
Feed Right with
better hose
separation

Functions according to control system