

**EC20B Main**

Published:2013-10-30

Drawing No:1012417/D

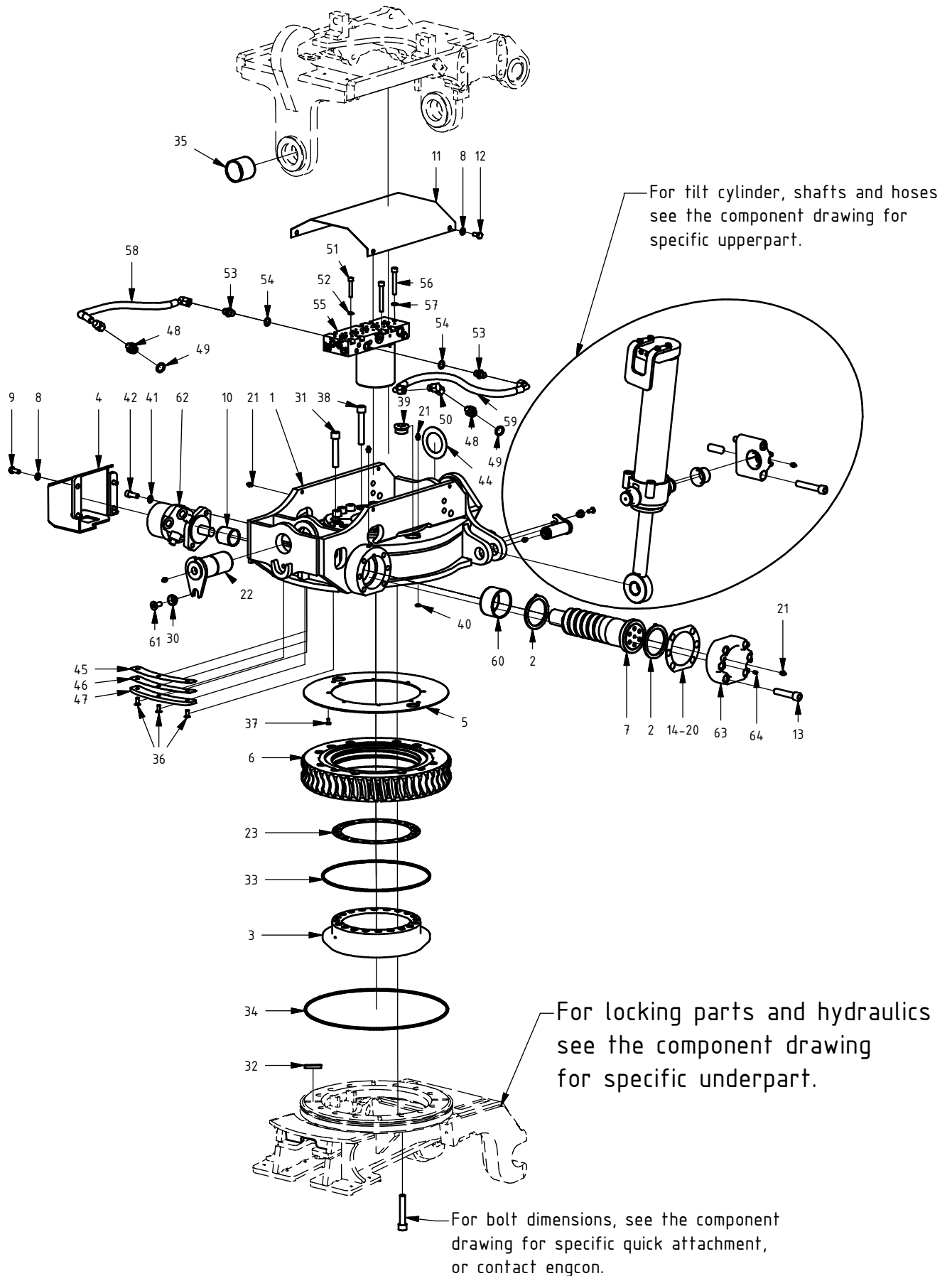

## EC20B Main

Published:2013-10-30				Drawing No:1012417/D	
POS	DESCRIPTION	PART	QTY	COMMENTS	
1	EC20 housing	101277	1		
2	Thrust Washer 10,15,20	1010758	2		
3	Centrumring 20	302807	1		
4	Motor Prot. EC20 & 30	100010	1		
5	Wear Washer 20	400310	1		
6	Worm Gear	300863	1		
7	Worm Screw	300030	1		
8	Flat Washer	611006	8		
9	Hex Head Screw 10 x 25	610142	4		
10	Bushing 45/50x50	630102	1		
11	Lock	300118	1		
12	Hex Head Screw 10 x 20	610141	4		
13	Socket Head Screw 16 x 80	610528	6		
14	Shims End Lock 0,3mm	1001639	1		
15	Shims End Lock 0,4mm	405126	1		
16	Shims End Lock 0,5mm	405127	1		
17	Shims End Lock 0,6mm	405675	1		
18	Shims End Lock 0,7mm	405676	1		
19	Shims End Lock 0,8mm	1001638	1		
20	Shims End Lock 0,9mm	1001712	1		
21	Grease Nipple	7114.03	15		
22	Tiltaxle 20	302830	2		
23	Shims 0,4mm	202055	1		
24	Shims 0,5mm	202056	1		
25	Shims 0,7 mm	201793	1		
26	Shims 0,8 mm	2014.05	1		
27	Shims 0,9 mm	2014.06	1		
28	Shims 1mm	201365	1		
23	Shims 1,1 mm	2014.07	1		
30	Distans M12 L15	1008243	2		
31	Socket Head Screw 16 x 90	610530	10		
32	Feather Key	650102	4		
33	O-ring	710908	1		
34	O-ring	710909	1		
35	Bushing 60/65x60	630301	2		
36	Flat head socket screw 8x20	610634	5		
37	Hex Head Screw 6 x 12	610108	8		
38	Socket Head Screw 16 x 100	610532	10		
39	RP M36x2 Din 908 Sv,krom	6504.04	2		
40	O-ring	710910	1		
41	Washer NL12	611042	2		
42	Socket Head Screw 12 x 30	610474	2		
43	Tiltaxelshims 20	650501	1	0,5 mm	
44	Tiltaxelshims 20	650502	1	1 mm	
45	Breakout support plate shims 0,1 mm	1008262	1	If needed	
46	Breakout support plate shims 0,3 mm	1013256	1	If needed	
47	Breakout support plate	1006878	1		
48	Adapter	710122	2		
49	Sealing washer 08 (1/2")	710704	2		
50	Adapter 704-06	710216	1		
51	Socket Head Screw 8 x 50	610439	2		
52	Washer Nordlock M8	611040	2		
53	Adapter	710106	2		
54	Sealing washer 06 (3/8")	710703	2		
55	Svivel (Complete)	201683	1		
56	Socket Head Screw 10 x 70	610461	1		
57	Nordlock washer 10	611041	1		
58	Hose motor EC20 short	740240	1	RM06 4509-06-06/4509-06-06 KL410	
59	Hose motor EC20 long	740208	1	RM06 4512-06-06/4512-06-06 KL500	
60	Bushing 80/85x50	630105	1	630103 before 20090801	
61	Flat head socket screw 12x30	610668	2	10.9 Untreated DIN 7991	
62	Hydraulic motor White 160cc	720134	1		
63	End lock, forged	1014716	1	Replaces 303270 From 1306	
64	Plugg	711527	1		