

COVERSHEET

Planned document changes:

Briefly:

No planned changes.

Document changes:

Date:	Change:	Rev. after change:
2026-06-25	Lock wedge for EC104/EC204BU replaced.	E
2026-02-26	Lock wedge info updated.	D
2025-12-17	Lock wedge for RF replaced.	C
2025-02-21	EC204BU added.	B
2023-06-08	Layout/irrelevant.	A
2019-09-03	New document.	-

Readers note:

Indicates instruction.



Represents Hose.

Dashed lines for overview, mounts
on other pages/assemblies.

Std. Hitch components – S40SEMI

POS in order of assembly

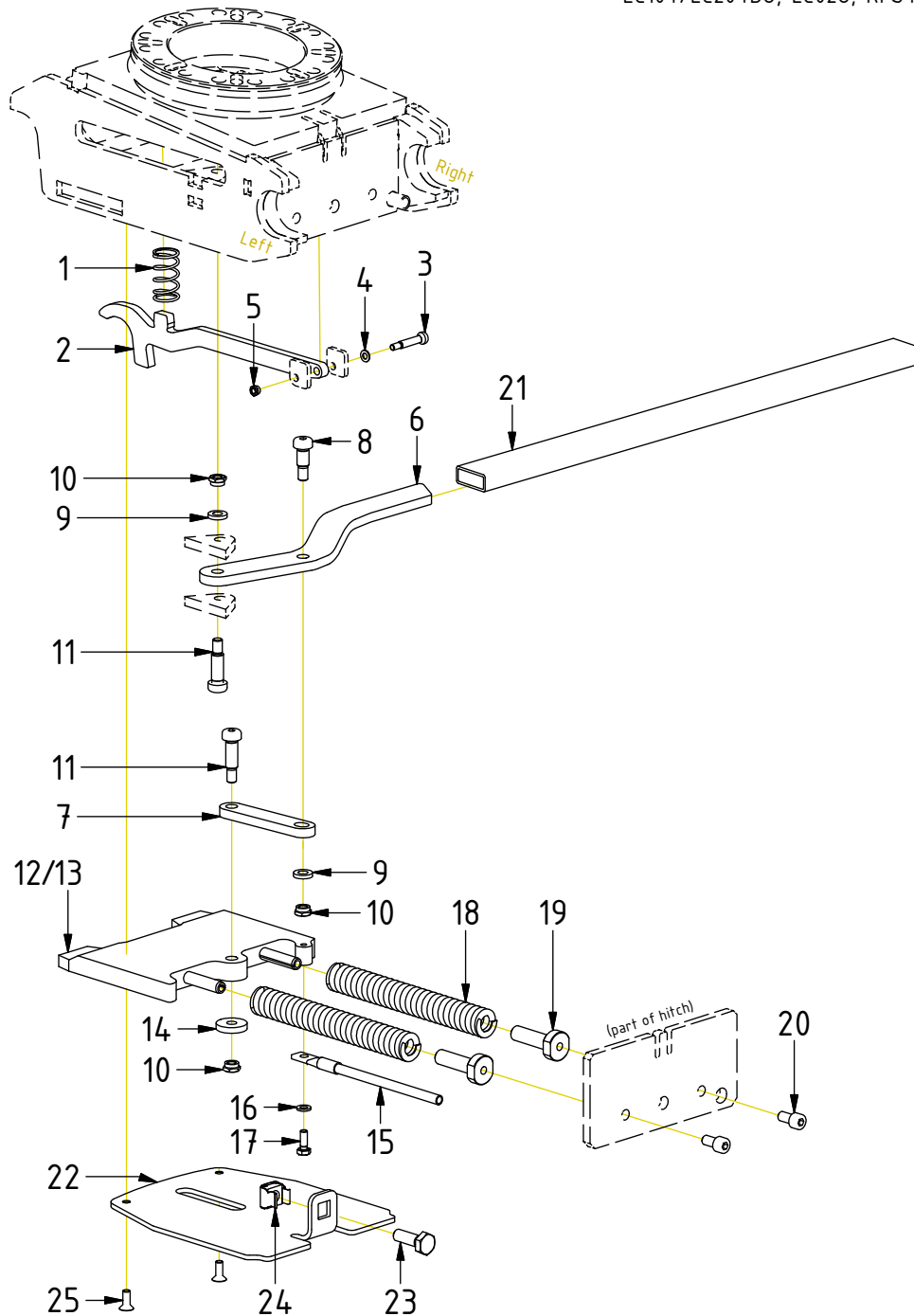

EC104/EC204BU, EC02U, RFS40M

POS	DESCRIPTION	PART	QTY	COMMENTS
1	Pressure Spring 22x41 stainless	640111	1	
2	Lock catch S40SEMI	202971	1	
3	Shoulder bolt 6x25/M5	611705	1	
4	Washer BRB 5,3x10x1 200 HV FZB	611003	1	
5	Lock Nut M6M M5x0,8 8,8 FZB	610920	1	
6	Arm	1080680	1	
7	Link S30/S40	405075	1	
8	Shoulder bolt \varnothing 10x16/M8	611701	1	
9	Washer TBRB 8,4x16x3	611013	2	
10	Nut M6M M8 Lock	610922	3	
11	Shoulder bolt \varnothing 10x25/M8	611703	2	
12	Lock wedge 2026>	1082907	1	For RF from 2026-01 For EC104/204BU from 2026-06
13	Lock wedge <2025	303246	1	Until 2026. Still relevant for EC02
14	Washer TBRB 8,4x26x5	611014	1	
15	Indicator pin	303406	1	
16	Washer BRB 6,4x12x1,5	611004	1	
17	Screw M6S M6x16 10.9 untreated	610109	1	Loxal 83-52
18	Spring blue 25x178	640112	2	
19	Spring retainer S40	405301	2	
20	Screw MC6S M8x16 12.9	610431	2	
21	Handle S40SEMI	303423	1	
22	Protection Plate S40M	1015126	1	
23	Screw M6S M10x30 8,8 FZB	610143	1	
24	Cage Nut M10	610952	1	
25	Screw MF6S M6x16 10.9 untreated	610604	2	