

**EC05B Components SS9IQ**

Published:2013-11-29

Drawing No:1023751/-

**COVERSHEET**

Discontinued model/configuration, exploded view will receive no updates.

**Notable regarding spare parts:**

Coverplate left POS.2 replaced by 1024952. Coverplate right POS.3 replaced by 1024865.

Washer and screw for coverplates: 611040 and 610122.

### EC05B Components SS9IQ

Published:2013-11-29				Drawing No:1023751/-	
POS	DESCRIPTION	PART	QTY	COMMENTS	
1	Valve block complete	1008197	1		
2	Coverplate left	1007327	1		
3	Coverplate right	1007332	1		
4	Engine CL80cc	720128	1		
5	Tiltcylinder 63/32	1001840	1		
6	O-ring	710961	2	12,37x2,62	
7	Sealing washer 04 (1/4")	710702	6		
8	Adapter	710135	2		
9	Banjobolt	710271	2		
10	Hose Tilt	740558	2		
11	Sealing washer 06 (3/8")	710703	4		
12	Adapter	710106	4		
13	Washer NL12	611042	2		
14	Socket Head Screw 8 x 25	610434	4		
15	Nordlock washer 10	611041	7		
16	Socket Head Screw 10 x 50	610457	3		
17	NG4 locking valve 12V	730161	1		
18	Socket Head Screw 5 x 30	610403	4		
19	Socket Head Screw 5 x 35	610404	8		
20	Socket Head Screw 12 x 35	610578	2	12.9 Untreated ISO 4762	
21	Nut (Shot)	710252	4		
22	Shof Adapter Straight	710242	4		
23	O-ring	710901	2	9,25x1,78	
24	Block engine	1010409	1		
25	Block valveblock	1010405	1		
26	Washer Nordlock M8	611040	4		
27	Flat head socket screw 8x35	610611	2		
28	Hose Rotation EC05B	740550	2		
29	Assembly Stop	712103	4		
30	Deutch plate	1008340	1		
31	Hex. Nut M5	610903	8	DIN 985	
32	Socket Head Screw 5 x 20	610400	2	12.9 Untreated ISO 4762	
33	Terminal S40	1013348	1	Used on S40 top bracket	
34	Terminal S40	1011450	1	Used on S40 top bracket	
35	Terminal S45/ S50, UNI	1011067	1	Used on S45/S50, UNI top bracket	
36	Terminal S45/ S50, UNI	1016707	1	Used on S45/S50, UNI top bracket	
37	Socket Head Screw 10 x 20	610451	4		
38	Socket Head Screw 12 x 90	610486	2		
39	Valve NG4 Closed 12V	730153	1	RPE3-042P51/01200E8	
40	Directional Valve Closed 12V	730181	1		
41	Dumpblock NG6 12V	1006174 K	1		
42	Socket Head Screw 5 x 65	6104101	4	12.9 Untreated ISO 4762	
43	Adapterkabel Hirschmann - Amp Contact	1008557	1		
44	Hose valve block T, P	740559	1-2	Used on S40 top bracket . Used as Rotation Hose on S40 top bracket	
45	Hose valve block T, P	740554	1-2	Used on S45/S50 top bracket . Used as Rotation Hose on S45/S50, UNI top bracket	
46	Hose valve block T, P	740443	1-2	Used on UNI top bracket . Used as Rotation Hose on S40, UNI top bracket	
47	Assembly Cable SS9IQ- SS9SQ	1008633	1		

**EC05B Components SS9IQ**

Published:2013-11-29

Drawing No:1023751/-

Complete Component Drawing  
of Tiltcylinder 1001840  
(Pos. 5) 1009594

Complete Component Drawing  
of Svivel and Valveblock  
(Pos. 1) 1010548

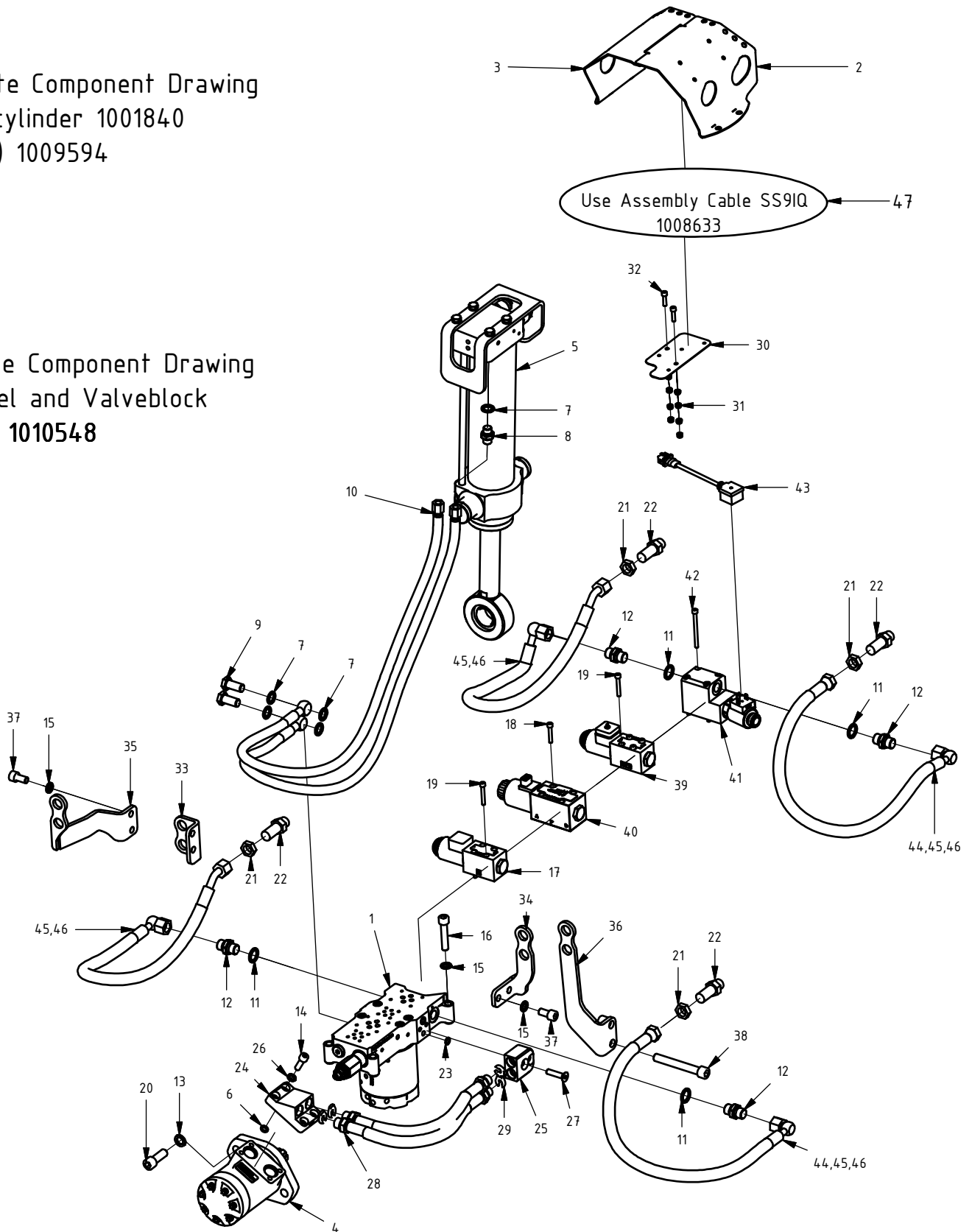

Hose traction varies  
depending on top brackets.  
See pos. comments