

COVERSHEET

Planned document changes:

Briefly:

No planned changes.

Document changes:

Date:	Change:	Rev. after change:
2023-04-25	Photos updated.	A
2023-04-05	New document.	-

Readers note:

 Indicates instruction.

 Represents Hose.

Dashed lines for overview, mounts
on other pages/assemblies.

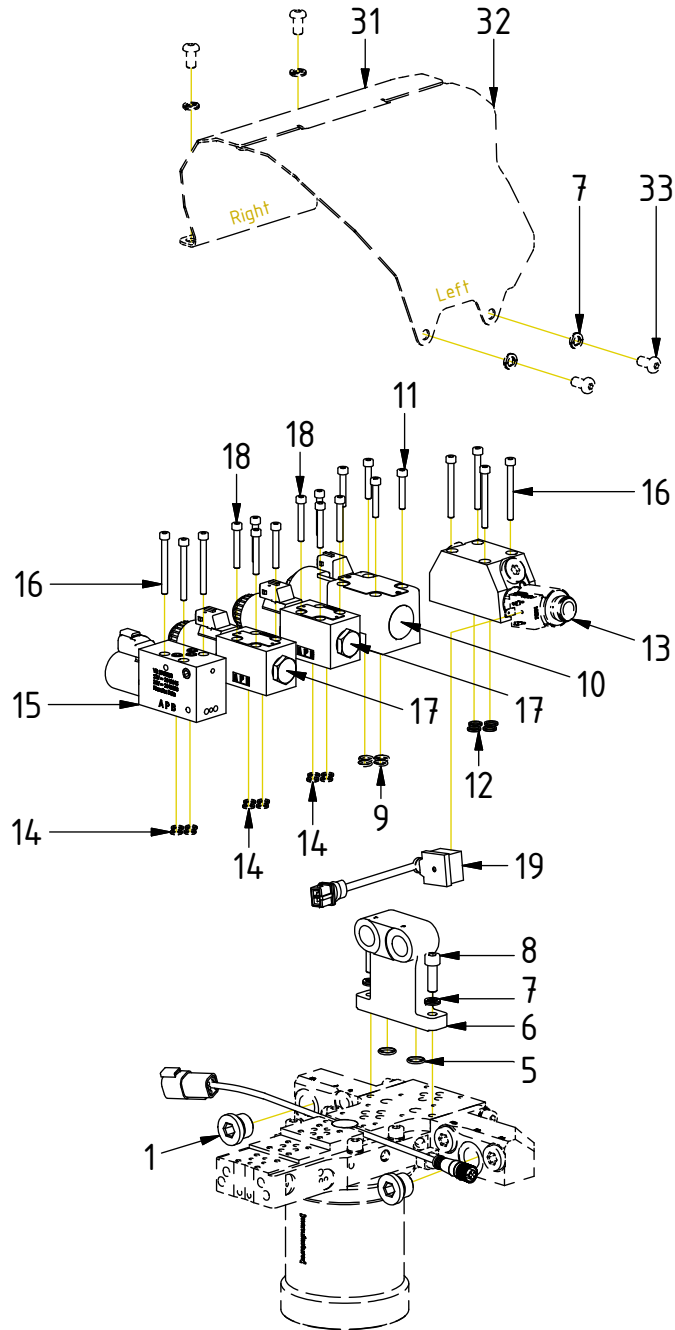

POS	DESCRIPTION	PART	QTY	COMMENTS
1	Plug 70125-08 (1/2")	711500	2	
5	O-ring 12,42x1,78	710973	2	
6	Feed block QSM40	1061758	1	
7	Washer NL 8mm	611040	14	QTY: 4 part of make up
8	Screw MC6S M8x25 12.9 ZFSHL	6000143	2	
9	O-ring 9,25x1,78	710901	4	
10	Directional valve closed 12V	730112	1	(POS.9 incl.)
11	Screw MC6S M5x30 12.9	610403	4	Torque: 9,7Nm
12	O-ring 8,75x1,78	710959	4	
13	Dumper block 12V NG6 Complete	1026714	1	(Dump valve incl.)
14	O-ring 7,65x1,78	710960	12	
15	Directional valve NG4 IQS 12V DT	1042045	1	(POS.14 incl.)
16	Screw MC6S M5x50 12.9	610407	7	Torque: 9,7Nm
17	Directional valve NG4 closed 12V	730330	2	(POS.14 incl.)
18	Screw MC6S M5x35 12.9	610404	8	Torque: 9,7Nm
19	Adapter cabel-Hirschmann-Amp	302971	1	
31	Protective cover EC206B right	1060973	1	Part of make up
32	Protective cover EC206B left	1061668	1	Part of make up
33	Screw K6S M8x16 10.9 FZB	611810	4	Part of make up

POS in order of assembly

Hoses

POS	DESCRIPTION	PART	QTY	COMMENTS
2	Washer GBR04 1/4	710702	2	
3	Adapter 136-04-04 (1/4")	7000531	2	
4	Hose Tilt	7001694	2	
20	Washer GBR08 1/2	710704	2	
21	Adapter 136-08-08 (1/2")	710108	2	
22	Hose Feed	7001692	2	
23	Hose Rotation a (ss9)	7001669	1	Part of quick hitch assy.
24	Hose Rotation b (ss9)	7001670	1	Part of quick hitch assy.

POS in order of assembly

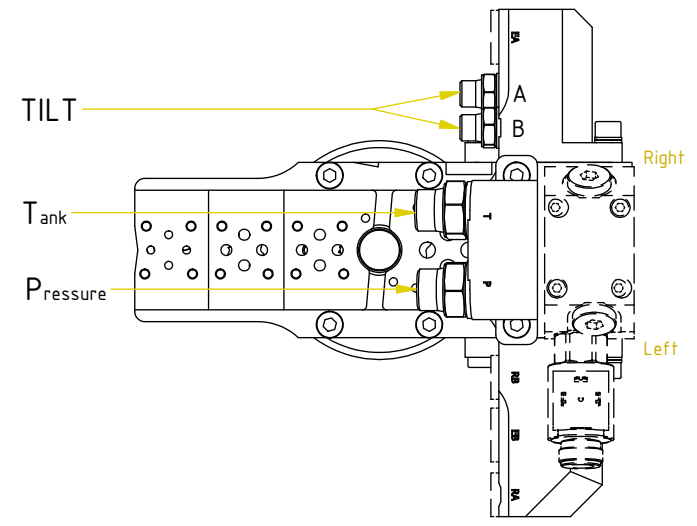
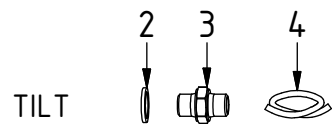
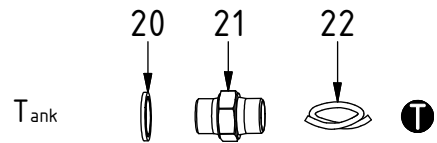
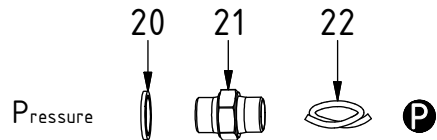

(FEED Rotation directly between motor & top part)

Cables

POS	DESCRIPTION	PART	QTY	COMMENTS
25	Aggregate cable ss9-2 DT Complete	8001823	1	
26	ILME cover 12P contact with jumper	810208	1	(Incl. with agg.cable)
27	Cable QS QLM tiltrotator ss9-2	842148	1	
28	Q-Safe connector			
29	Protection plate End lock EC206B	1062673	1	
30	Screw K6S M6x20 10.9 FZB	6000339	2	Torque: 79Nm

POS in order of assembly

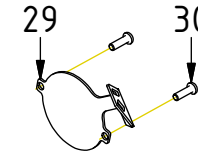
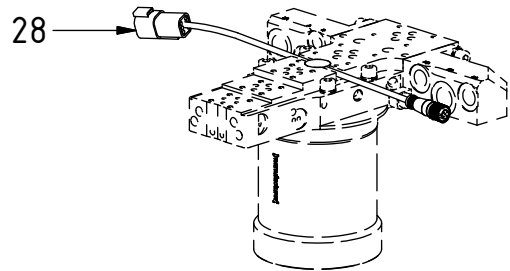
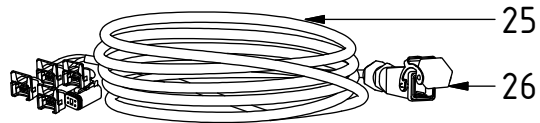
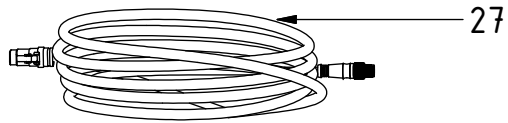

EC206BS:

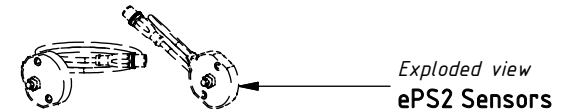

Exploded view
ePS2 Sensors

Hoses
Std Feed

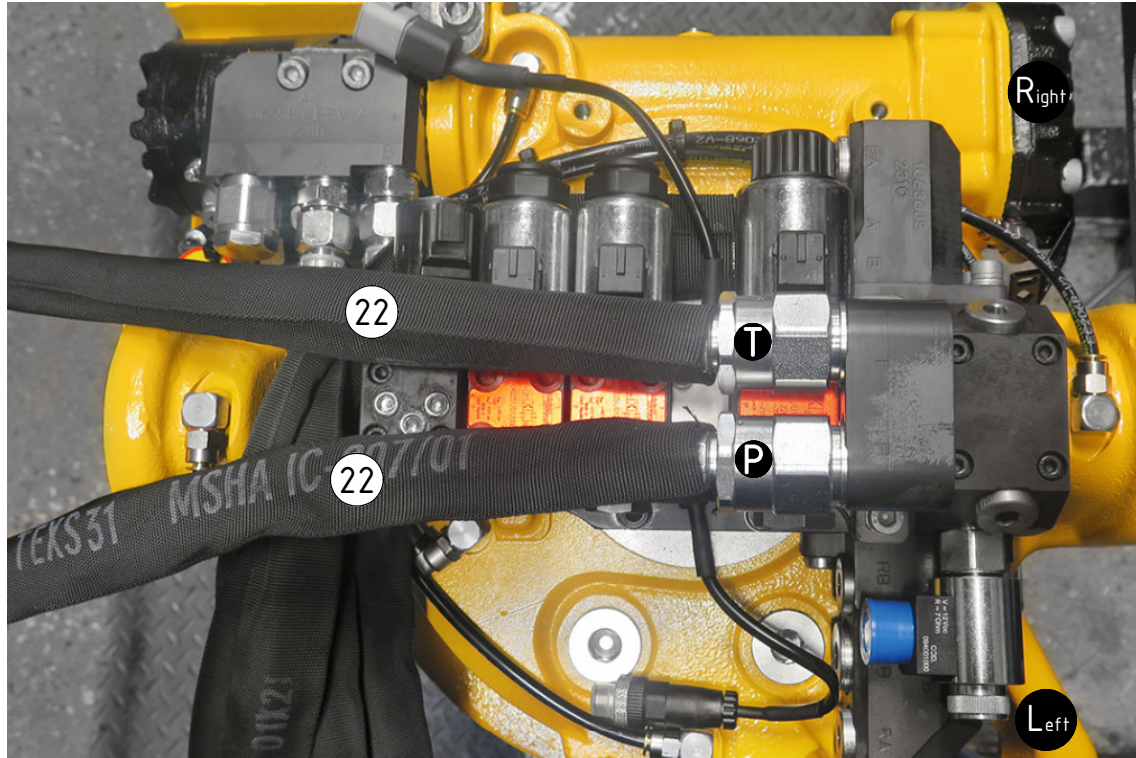

POS	DESCRIPTION	PART	QTY	COMMENTS
4	Hose Tilt	7001694	2	
22	Hose Feed	7001692	2	
23	Hose Rotation a (ss9)	7001669	1	Part of quick hitch assy.
24	Hose Rotation b (ss9)	7001670	1	Part of quick hitch assy.

POS in order of assembly

Rotation & TILT:

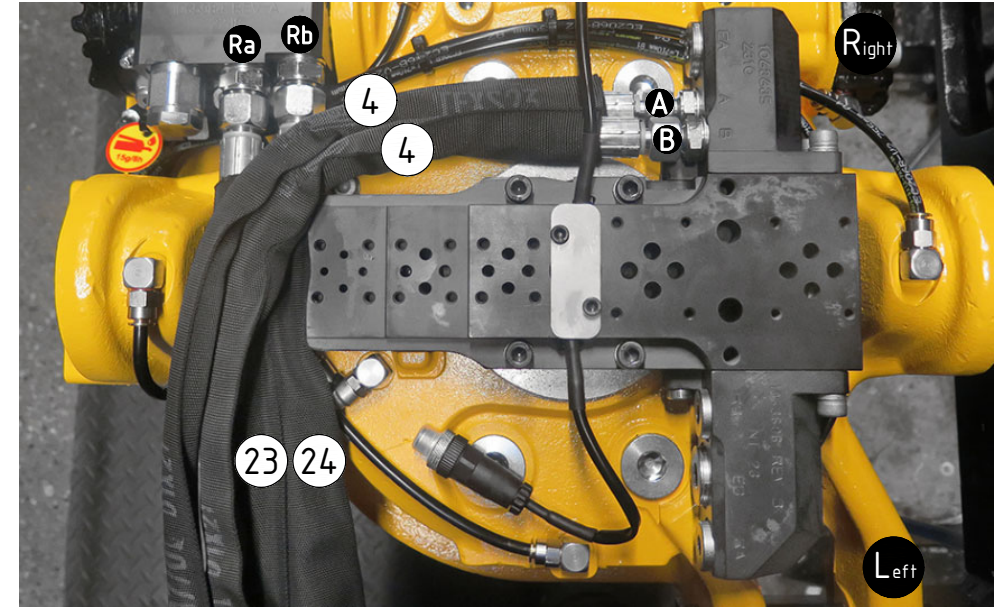

Cables

POS	DESCRIPTION	PART	QTY	COMMENTS
25	Aggregate cable ss9-2 DT Complete	8001823	1	
27	Cable QS QLM tiltrotator ss9-2	842148	1	
28	Q-Safe connector			
	● Use cable ties			

POS in order of assembly

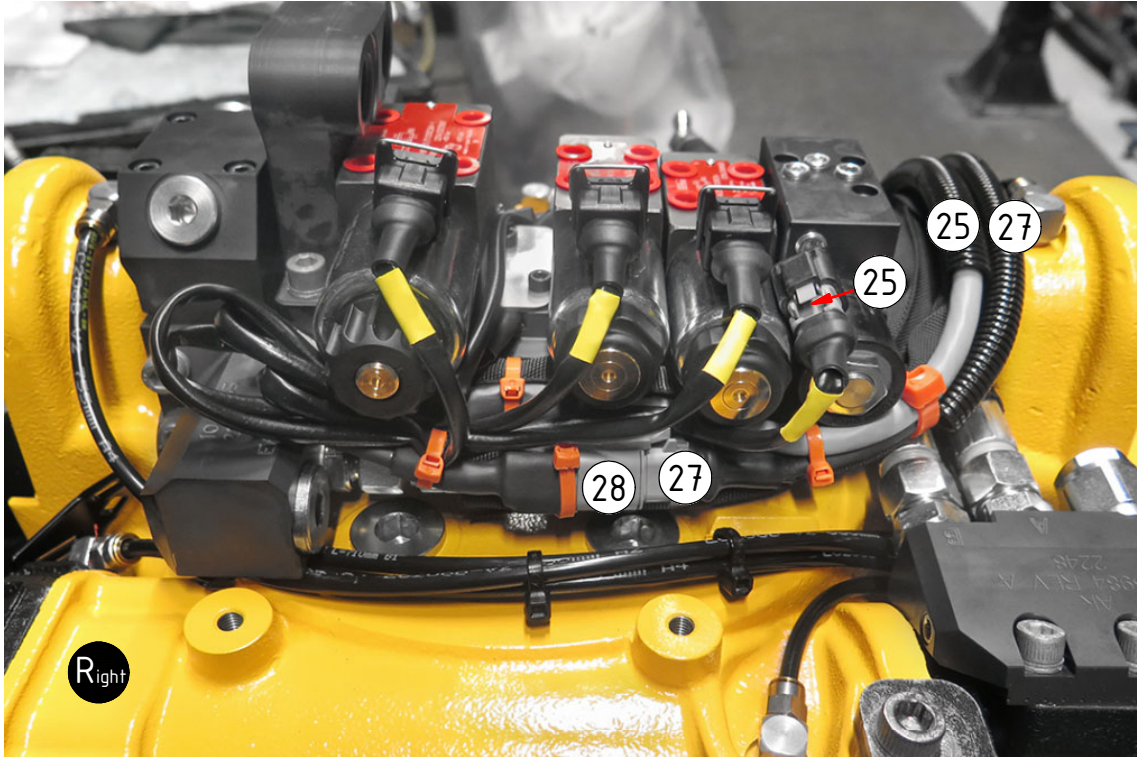

Valves

POS	DESCRIPTION	PART	QTY	COMMENTS
-----	-------------	------	-----	----------

POS in order of assembly

