

COVERSHEET

Planned document changes:

Briefly:

No planned changes.

Document changes:

Date:	Change:	Rev. after change:
2023-08-10	Spare parts updated.	C
2023-03-23	O-rings corrected. New ECO adapter cable added.	B
2022-11-24	Spare parts added.	A
2022-08-30	New document.	-

Readers note:

 Indicates instruction.

 Represents Hose.

Dashed lines for overview, mounts
on other pages/assemblies.

POS in order of assembly

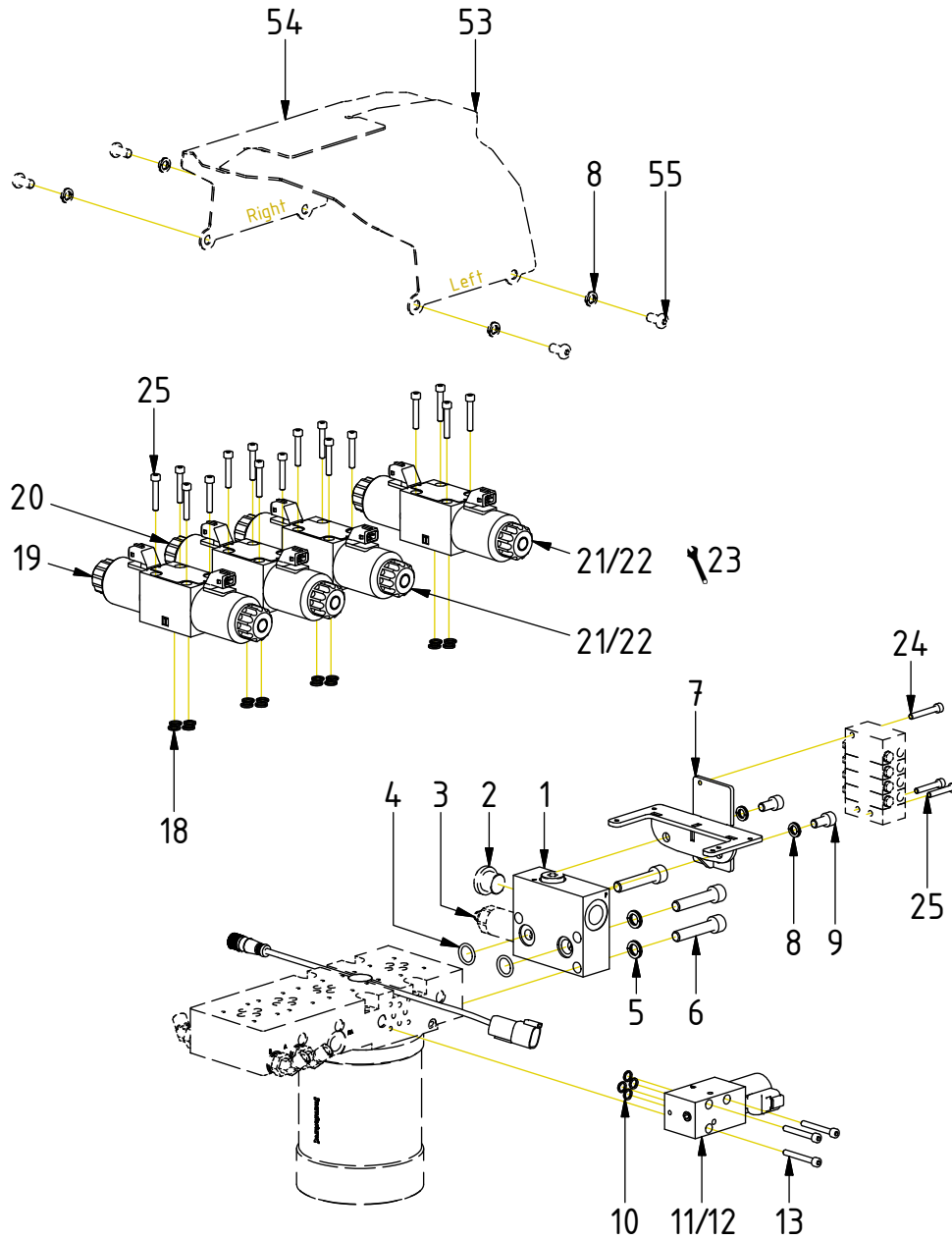

POS	DESCRIPTION	PART	QTY	COMMENTS
1	Connection block P reducer Compl.	1055945	1	(POS.2-3 incl.)
2	Plug VSTIR12ED	711500	1	Opposite side for EC-Oil
3	Pressure reduction valve SP4A-B3	730288	1	
4	O-ring 15,54x2,62	712423	2	
5	Washer NL 10mm	611041	3	
6	MC6S M10x50 12.9 ZFSHL	611515	3	
7	Mounting plate Central lub. QSM	1055574	1	
8	Washer NL 8mm	611040	6	QTY: 4 part of make up
9	Screw MC6S M8x16 12.9	610431	2	
10	O-ring 7,65x1,78	710960	4	
11	Directional valve NG4 IQS 12V DT	1042047	1	(POS.10 incl.)
12	Directional valve NG4 IQS 24V DT	1042190	1	(POS.10 incl.)
13	Screw MC6S M5x40 12.9	610405	3	Torque: 9,7Nm. QTY: 1 when EC-Oil
14	Valve spacer M5x39	1047243	2	Torque: 9,7Nm
15	Mounting plate-1x Deutsch NG4	1058235	1	
16	Washer NL 5mm	611038	2	
17	Screw K6S M5x16 10.9 FZB	611818	2	Torque: 8,1Nm
18	O-ring 8,75x1,78	710959	16	
19	Directional valve prop 12V open T	7001615	1	(POS.18 incl.)
20	Directional valve prop 12V	7001614	1	(POS.18 incl.)
21	Directional valve NG6 12V	7001617	2	(POS.18 incl.)
22	Directional valve NG6 24V	7001616	2	(POS.18 incl.)
23	For option PROP on grab/extra			Use POS.20 instead of POS.21/22
24	Screw MC6S M5x35 12.9	610404	1	
25	Screw MC6S M5x30 12.9	610403	18	Torque: 9,7Nm
53	Protective cover EC209 QSM Left	1056632	1	Part of make up
54	Protective cover EC209 QSM Right	1056633	1	Part of make up
55	Screw K6S M8x16 10.9 FZB	611810	4	Part of make up

EC-Oil:

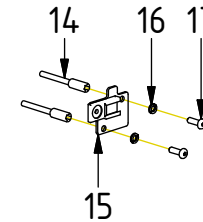

Hoses

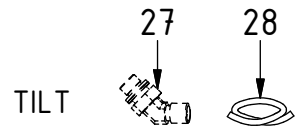
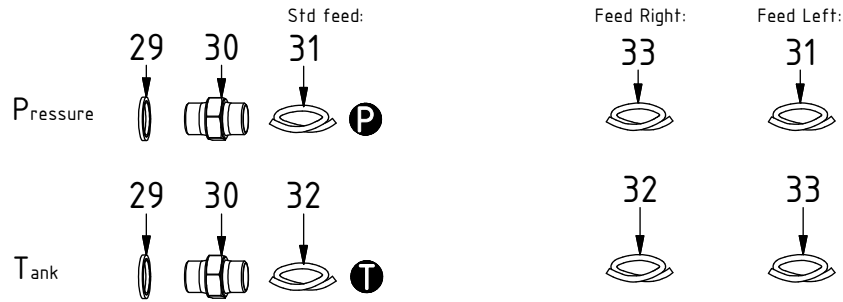

EC-Oil:

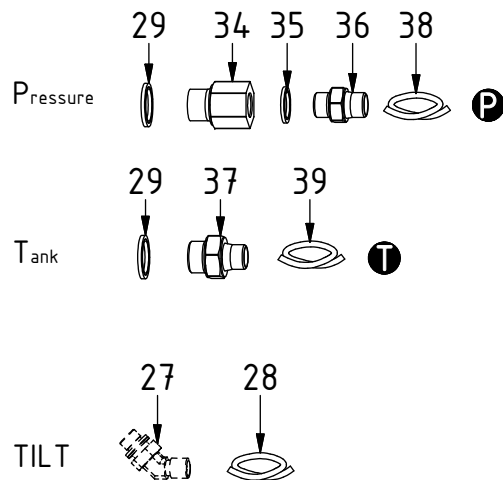

POS	DESCRIPTION	PART	QTY	COMMENTS
26	For option Drain			See p.8 for instruction
27	Adapter 45° 402-04-04(1/4")	7000104	4	Part of quick hitch assy.
28	Hose Tilt	7001308	4	
29	Washer GBR08 1/2	710704	3	
30	Adapter 136-08-08 (1/2")	710108	2	
31	Hose Feed P	7001265	1	
32	Hose Feed T	7001266	1	
33	Hose Feed Right/Left	7001586	1	Feed Right: Use this for "P" Feed Left: Use this for "T"
34	Adapter 235-08-06	7000705	1	
35	Washer GBR06 3/8	710703	1	
36	Adapter 136-06-06 (3/8")	710106	1	
37	Adapter 135-06-08	710122	1	
38	Hose Feed EC-Oil P	7001267	1	
39	Hose Feed EC-Oil T	7001268	1	

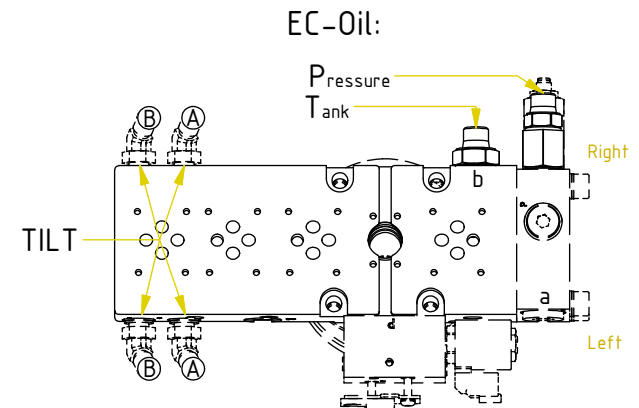
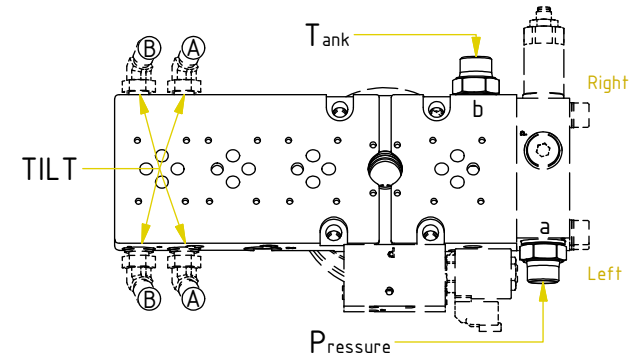

EC209B - ss10 (DC2/SVAB)

Cables

POS	DESCRIPTION	PART	QTY	COMMENTS
42	Q-Safe connector			
43	Tiltrotator module DC2 Q-Safe	842137	1	
44	Jumper JT QSC connected	1018662	1	Plug JT connector "1"
45	Screw MC6S M5x12 12.9	6000077	2	
46	Aggregate cable DC2 Compl. QSC DT	8001201	1	
47	ILME cover 12P contact with jumper	810208	1	(Incl. with agg.cable)
48	Adapter cable ECOW DC2 DTM	1048529	1	For EC-Oil. Instead of agg.cable
49	Adapter cable ECOW DC2 DTM 2xM12		1	For EC-Oil & T/R Sensors. Instead of agg.cable
51	Protection plate End lock EC209B	1063372	1	
52	Screw MC6S M12x70 12.9 Geomet	611517	8	Torque: 136Nm

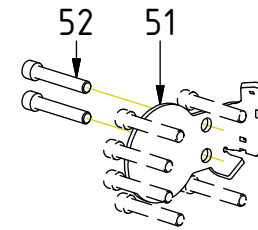
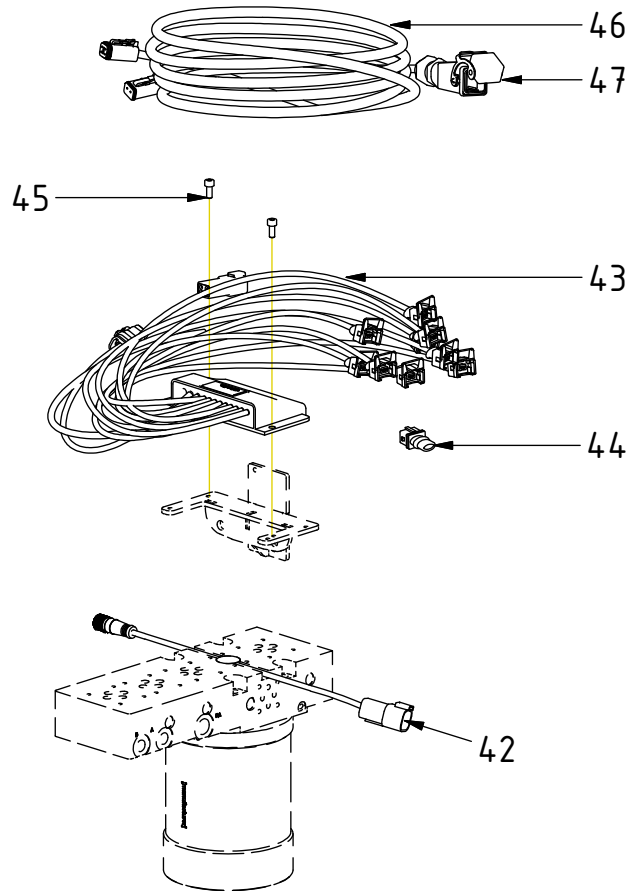

EC209BS:

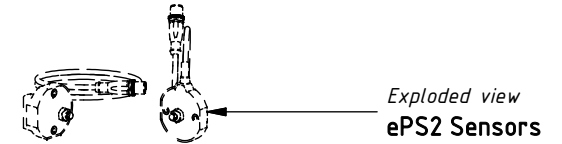

EC-Oil:

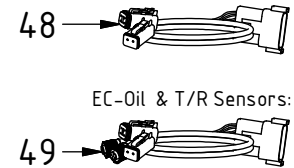
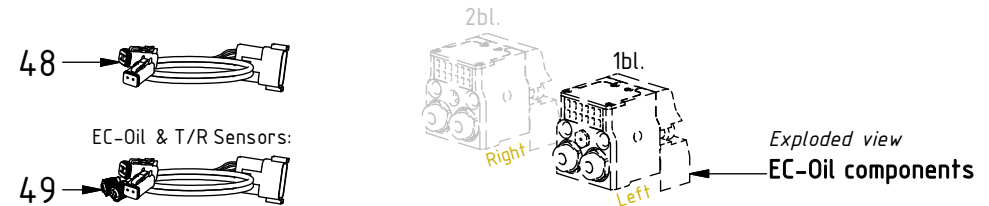

POS in order of assembly

Hoses
Std Feed

POS	DESCRIPTION	PART	QTY	COMMENTS
26	For option Drain			See p.8 for instruction
28	Hose Tilt	7001308	4	
31	Hose Feed P	7001265	1	
32	Hose Feed T	7001266	1	
33	Hose Feed Right/Left	7001586	1	Feed Right: Use this for "P" Feed Left: Use this for "T"
38	Hose Feed EC-Oil P	7001267	1	
39	Hose Feed EC-Oil T	7001268	1	

POS in order of assembly

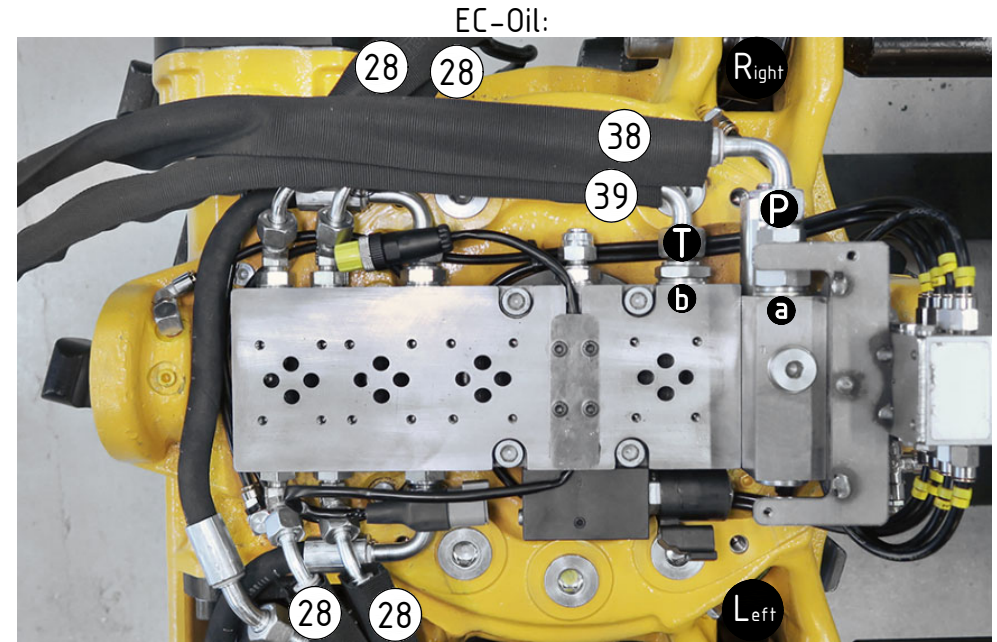
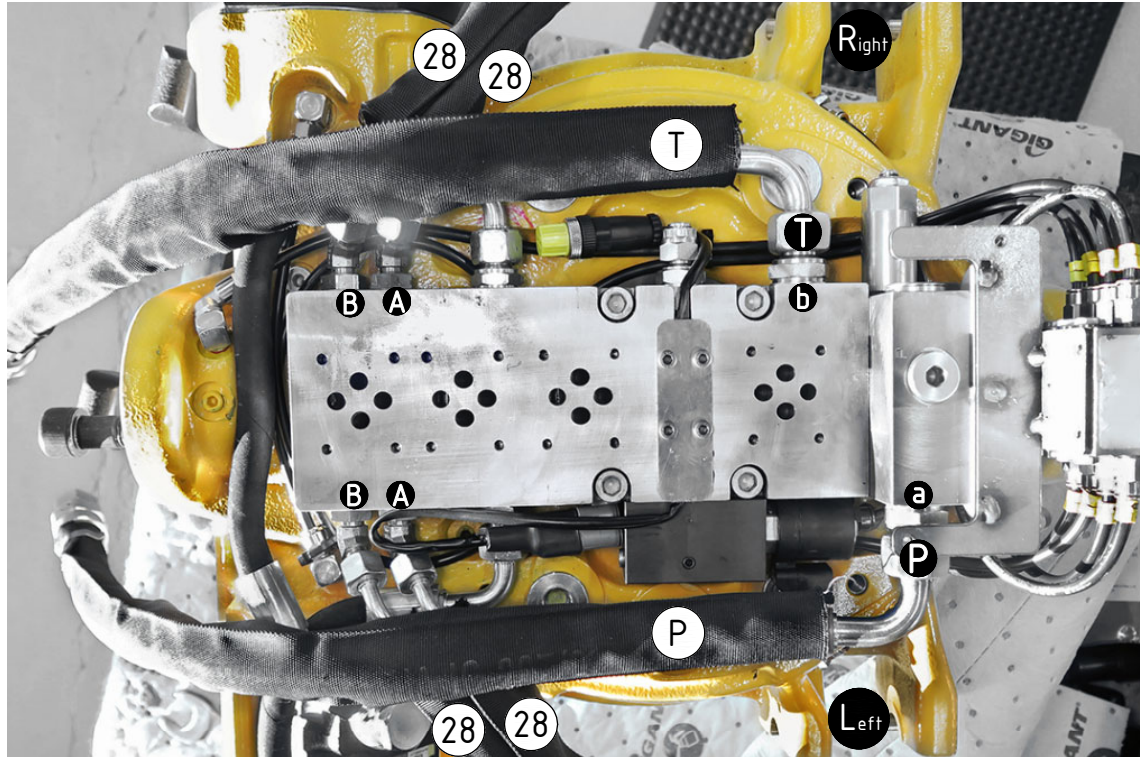

Cables

POS	DESCRIPTION	PART	QTY	COMMENTS
42	Q-Safe connector		1	
43	Tiltrotator module DC2 Q-Safe	842137	1	
44	Jumper JT QSC connected	1018662	1	Plug JT connector "1"
46	Aggregate cable DC2 Compl. QSC DT	8001201	1	
48	Adapter cable ECOW DC2 DTM	1048529	1	For EC-Oil. Instead of agg.cable
49	Adapter cable ECOW DC2 DTM 2xM12		1	For EC-Oil & T/R Sensors. Instead of agg.cable
50	Protection plug DTM	8000090	1	
● Use cable ties				

POS in order of assembly

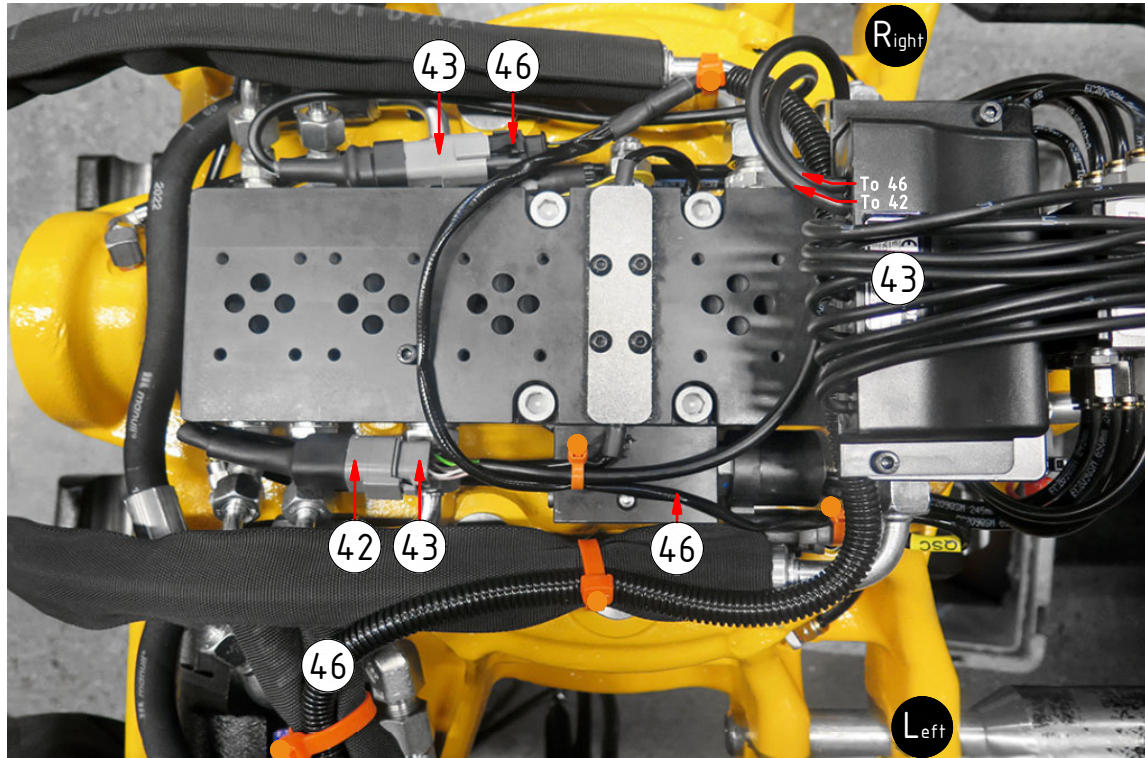

EC-Oil:

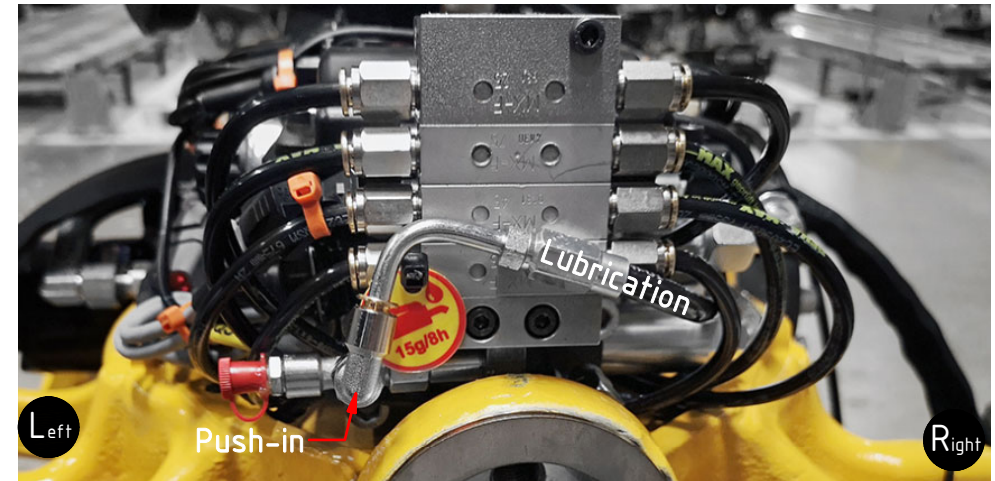
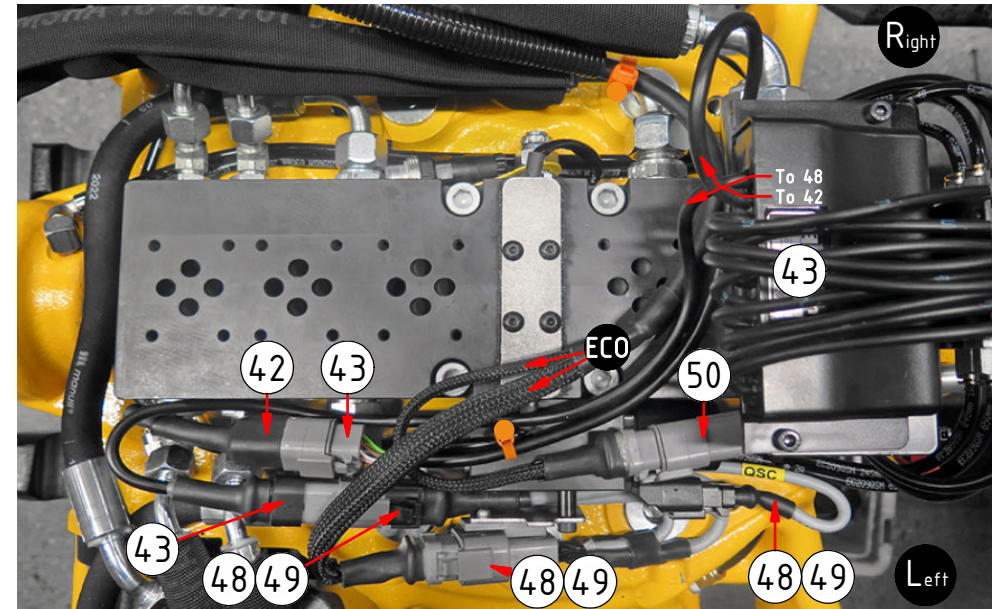

Valves

POS	DESCRIPTION	PART	QTY	COMMENTS
●	Use cable ties			

POS in order of assembly

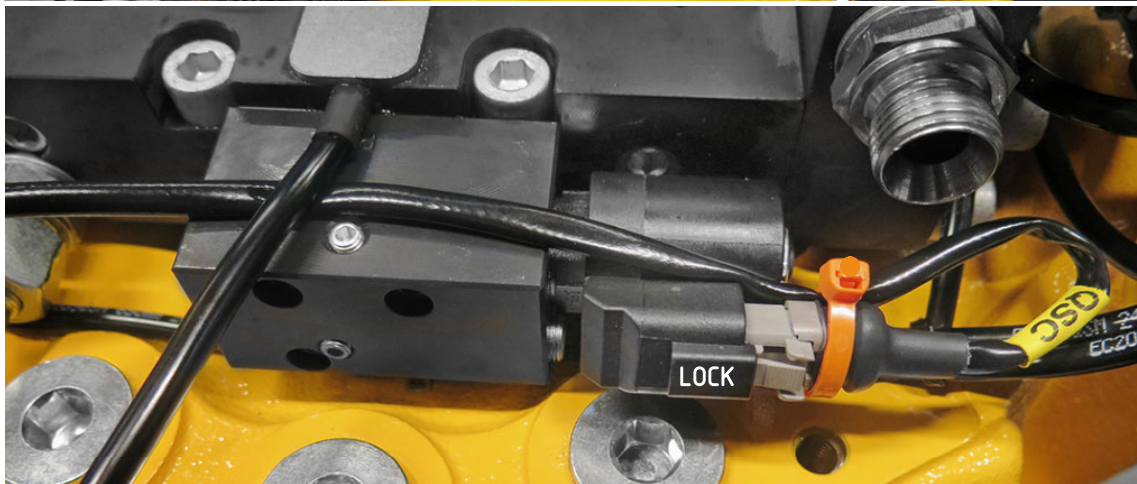
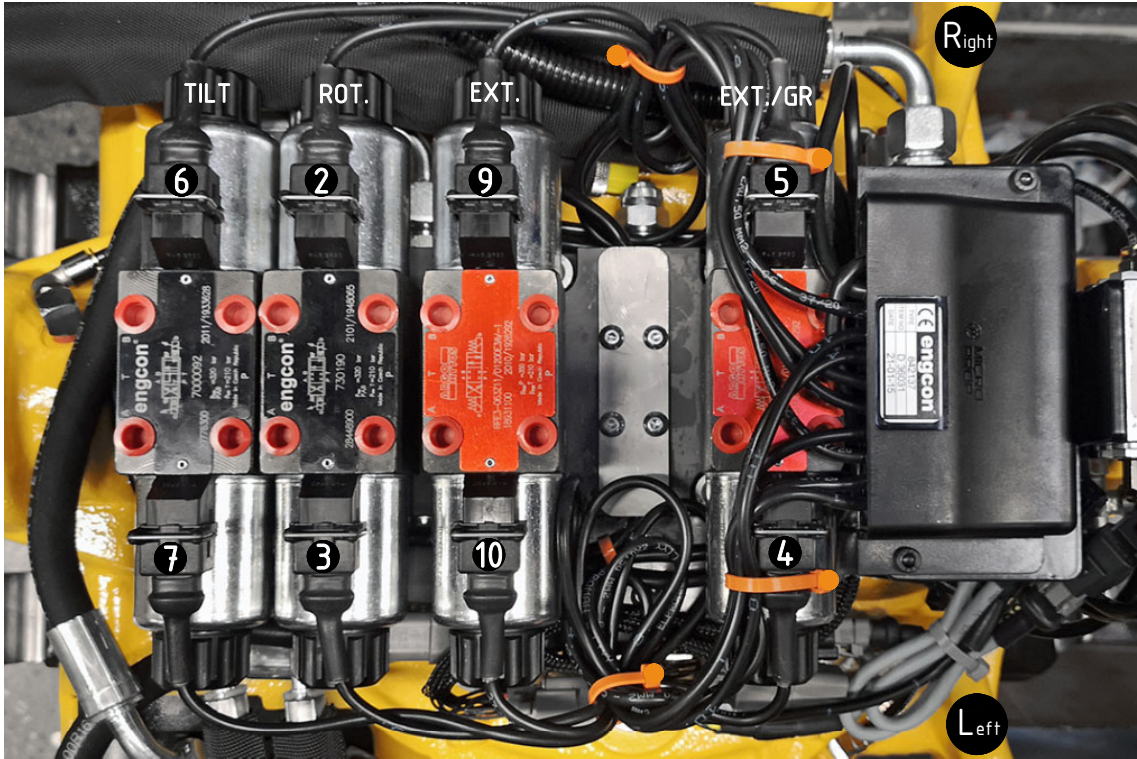

special/options

POS	DESCRIPTION	PART	QTY	COMMENTS
40	Remove Protective cap			Part of Quick hitch
41	Hose Drain	7001276	1	

POS in order of assembly

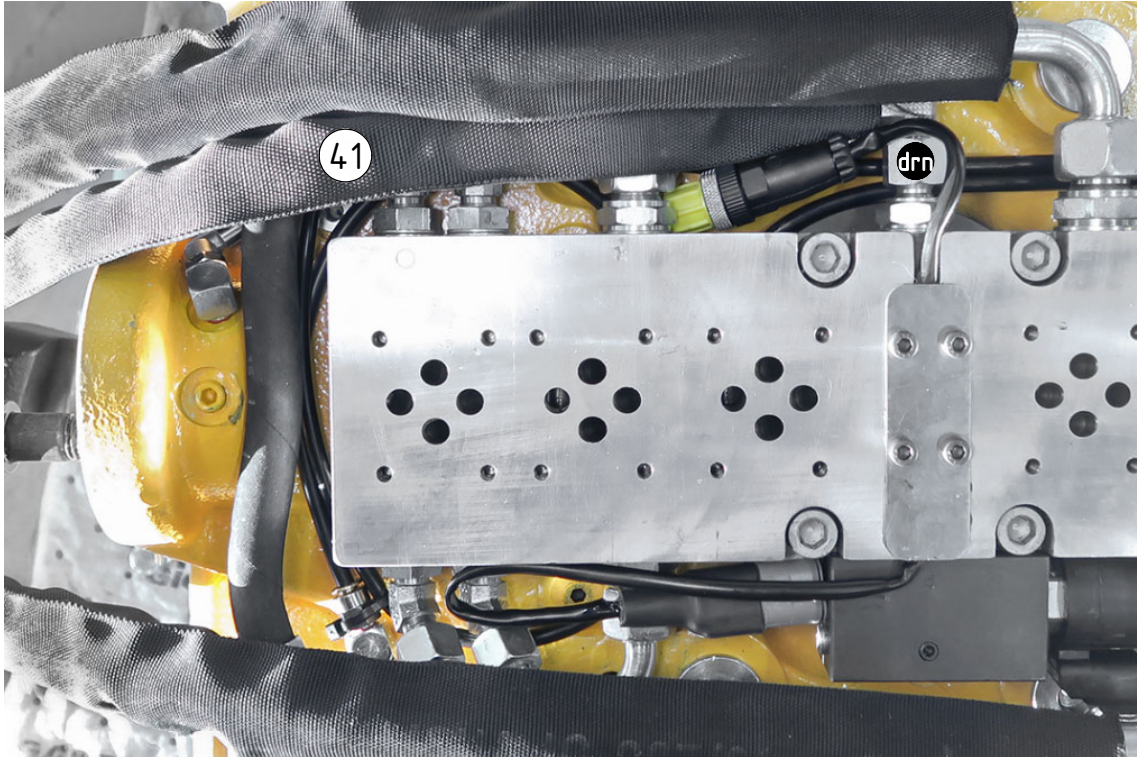

SPARE PARTS

ss10 (DC2/SVAB)

Used until 2022-06

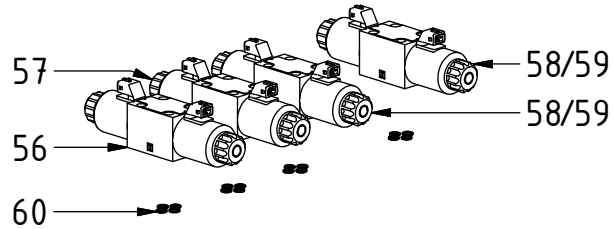

o-rings, coils, & nuts are not compatible between valve brands

EC209PS DC2:

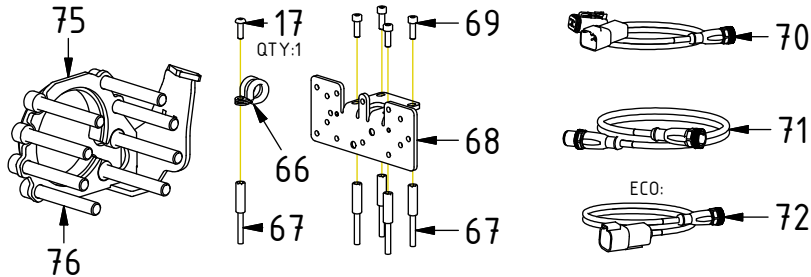

EC209PS ss10 (SVAB):

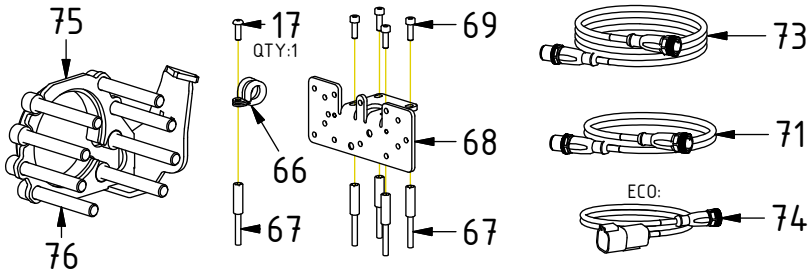

POS	DESCRIPTION	PART	QTY	COMMENTS
17	Screw K6S M5x16 10.9 FZB	611818	2	Torque: 8,1Nm
18	O-ring 8,75x1,78	710959	16	
19	Directional valve prop 12V open T	7001615	1	(POS.18 incl.)
20	Directional valve prop 12V	7001614	1	(POS.18 incl.)
21	Directional valve NG6 12V	7001617	2	(POS.18 incl.)
22	Directional valve NG6 24V	7001616	2	(POS.18 incl.)
46	Aggregate cable DC2 Compl. QSC DT	8001201	1	
47	ILME cover 12P contact with jumper	810208	1	(Incl. with agg.cable)
56	Argo hytos valve prop 12V open T	7000092	1	Replaced by POS.19 (ATOS)
57	Argo hytos valve prop 12V	730190	1	Replaced by POS.20 (ATOS)
58	Argo hytos valve NG6 12V	730101	2	Replaced by POS.21 (ATOS)
59	Argo hytos valve NG6 24V	730103	2	Replaced by POS.22 (ATOS)
60	O-ring 9,25x1,78	710901	16	Used until 2022-06
61	Aggregate cable DC2 Comp. QSC JT	8000175	1	Replaced by POS.46 from 2020-12
62	Cable QS QLM tiltrotator SVAB	842148	1	
63	Aggregate cable SVAB Complete	303465	1	
64	Adapter cable JT>DT	1017478	1	(Previously also for DC2)
65	Adapter cable ECO (DTM) SVAB	1029599	1	For EC-Oil. Instead of POS.62-63
66	Rubber steel clamp ø16	6000009	1	
67	Valve spacer	1034402	5	
68	Plate EC209PS QSM	1057538	1	
69	Screw MC6S M5x16 12.9	610401	4	
70	Adapter cable DC2 ePS	8000783	1	
71	Adapter cable ePS rotation sensor	8000784	1	
72	Cable Tilt angle sensor ECO W DC2	1048530	1	For EC-Oil with ePS
73	Unit cable ePS w. 120 ohm termin.	8000824	1	
74	Ad.cable ePS ECO W SVAB 120 ohm	8000825	1	For ECO w. ePS. Instead of POS.73
75	Protection EC209PS	1033565	1	
76	Screw MC6S M12x80 12.9 ZFSLH	6000148	8	Torque: 136Nm

ss10 (SVAB):



DC2:

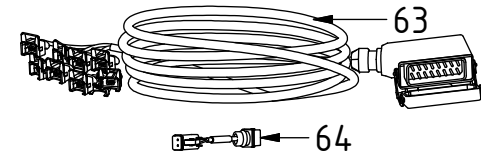
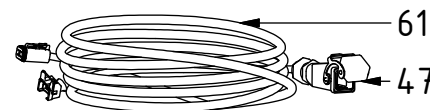

ss10 (SVAB) ECO:

