

Planned document changes:

Briefly:

2024-09-30. Cables for ss0 (always w/o ECO): POS.17 & POS.20.

Document changes:

| Date: | Change: | Rev. after change: |
|------------|---------------------------------|-----------------------|
| 2024-11-05 | EC204B cables added. | G |
| 2023-10-24 | DC3 added. | F |
| 2023-08-15 | Photos added. | E |
| 2023-03-14 | Y-split replaced. Cables added. | D |
| 2022-09-30 | Glue info updated. | C |
| 2022-08-31 | Torque updated. | B |
| 2022-06-14 | Sensor clarification. | A |
| 2022-05-11 | New document. | - |

Readers note:

 Indicates instruction.

 Represents Hose.

Dashed lines for overview, mounts
on other pages/assemblies.

EC204B

| POS | DESCRIPTION | PART | QTY | COMMENTS |
|-----|------------------------------------|---------|-----|--|
| 1 | Rotation sensor EC204B | 8002455 | 1 | White side against magnet |
| 2 | Tilt angle sensor EC204B | 8002467 | 1 | White side against magnet |
| 3 | Powerplug ECO40W Left 2xM12 204B | 8002454 | 1 | Part of EC-Oil components |
| 4 | Adapter cable tilt sensor EC204B | 8002471 | 1 | |
| 5 | Y-split EC204B | 8002474 | 1 | |
| 6 | Aggregate cable DC2 1xM12 EC204B | 8002470 | 1 | Part of control system |
| 7 | Adapter cable ss9 w. 120 ohm term. | 8002495 | 1 | |
| 8 | Magnet screw - Rot./Tilt sensor | 8001547 | 2 | Loxal 83-52. Torque: 10Nm QTY: 1 for EC204B |
| 11 | K6S M4x16 10.9 FZB | 6000368 | 4 | Loxal 55-02 |
| 12 | Washer BRB 4,3x9x0,8 200 HV FZB | 6000127 | 2 | |

POS in order of assembly

Exploded view
Std. Top components

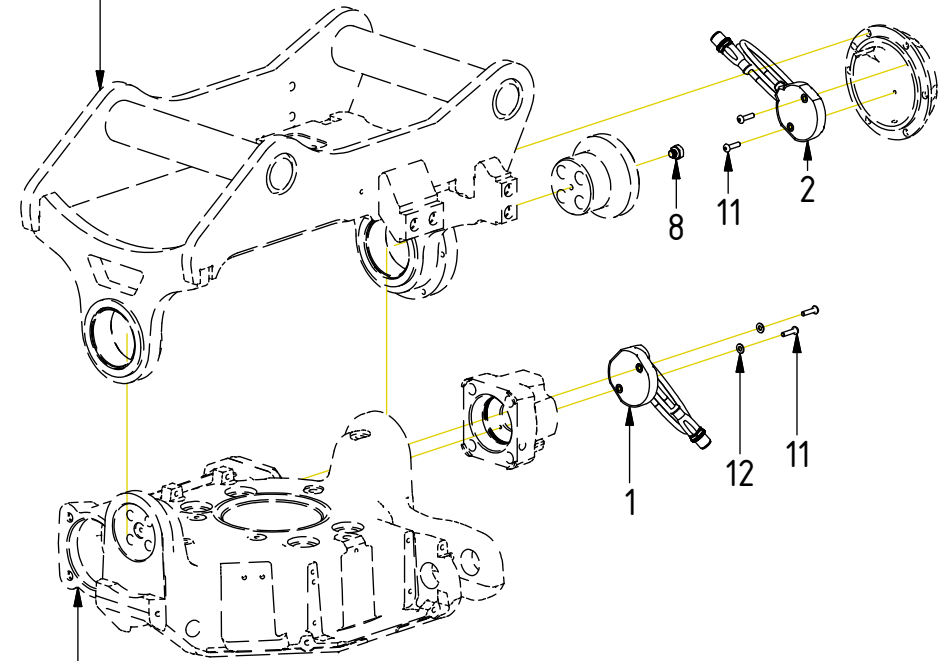

Exploded view
Rotator frame

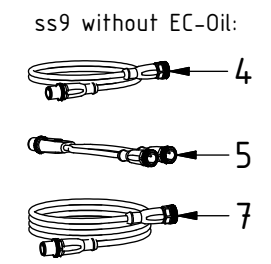
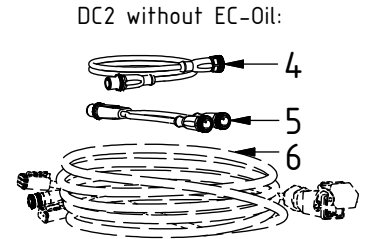
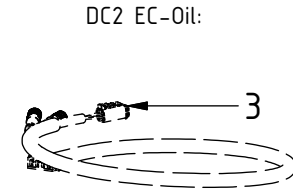

EC206B

| POS | DESCRIPTION | PART | QTY | COMMENTS |
|-----|-----------------------------------|---------|-----|--|
| 8 | Magnet screw - Rot./Tilt sensor | 8001547 | 2 | Loxal 83-52. Torque: 10Nm QTY: 1 for EC204B |
| 9 | Rotation sensor | 8001543 | 1 | White side against magnet |
| 10 | Tilt angle sensor | 8001544 | 1 | White side against magnet |
| 11 | K6S M4x16 10.9 FZB | 6000368 | 4 | Loxal 55-02 |
| 13 | Adapter cable tilt sensor 600mm | 8001610 | 1 | Cable cover: 405mm for EC206B, 495mm for EC209B |
| 15 | Powerplug ECO40W Left 2xM12 206B | 8001885 | 1 | Part of EC-Oil components |
| 17 | Y-split M12 EVC614 | 1069559 | 1 | |
| 18 | Adapter cable DC2 | 8000783 | 1 | |
| 19 | Ad.cable ss9/SVAB ECOW 120 ohm | 8000825 | 1 | |
| 20 | Ad.cable ss9/SVAB w. 120 ohm ter. | 8000824 | 1 | |

POS in order of assembly

Exploded view
Std. Top components

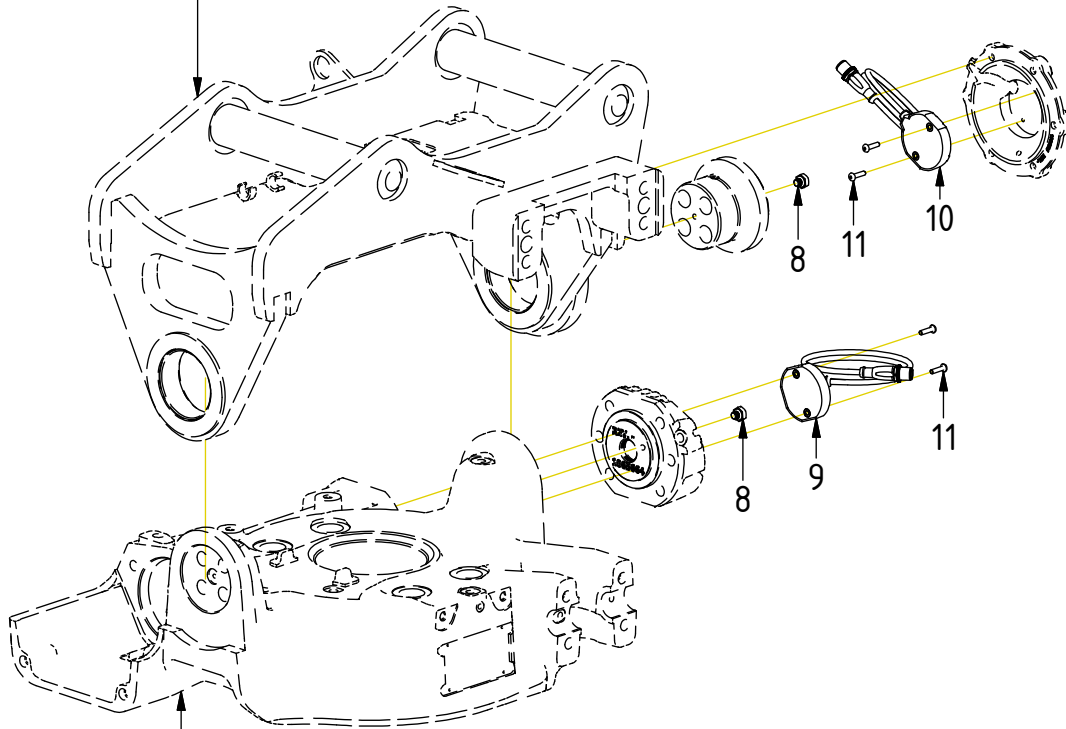

Exploded view
Rotator frame

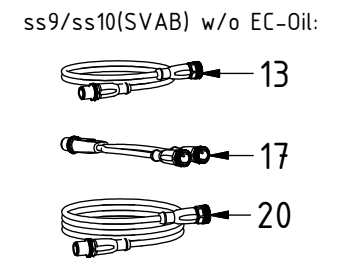
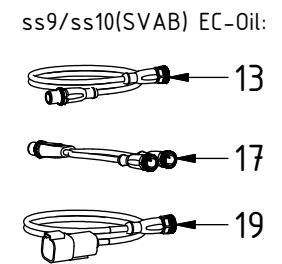
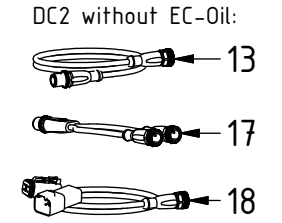
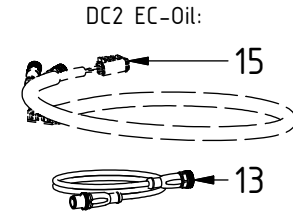

EC209B-EC233

- 21
- 22

| POS | DESCRIPTION | PART | QTY | COMMENTS |
|-----|-------------------------------------|---------|-----|--|
| 8 | Magnet screw - Rot./Tilt sensor | 8001547 | 2 | Loxal 83-52. Torque: 10Nm QTY: 1 for EC204B |
| 9 | Rotation sensor | 8001543 | 1 | White side against magnet |
| 10 | Tilt angle sensor | 8001544 | 1 | White side against magnet |
| 11 | K6S M4x16 10.9 FZB | 6000368 | 4 | Loxal 55-02 |
| 13 | Adapter cable tilt sensor 600mm | 8001610 | 1 | Cable cover: 405mm for EC206B, 495mm for EC209B |
| 14 | Adapter cable tilt sensor 1200mm | 8001611 | 1 | Cable cover: 800mm for EC214-233 |
| 16 | Adapter cable ECO W DC2 ePS2 | 8001847 | 1 | Part of Control system |
| 17 | Y-split M12 EVC614 | 1069559 | 1 | |
| 18 | Adapter cable DC2 | 8000783 | 1 | |
| 19 | Ad.cable ss9/SVAB ECOw 120 ohm | 8000825 | 1 | |
| 20 | Ad.cable ss9/SVAB w. 120 ohm ter. | 8000824 | 1 | |
| 21 | Rubber steel clamp $\varnothing 14$ | 613009 | 1 | |
| 22 | K6S M5x8 10.9 FZB | 611801 | 1 | |

POS in order of assembly

Exploded view
Std. Top components

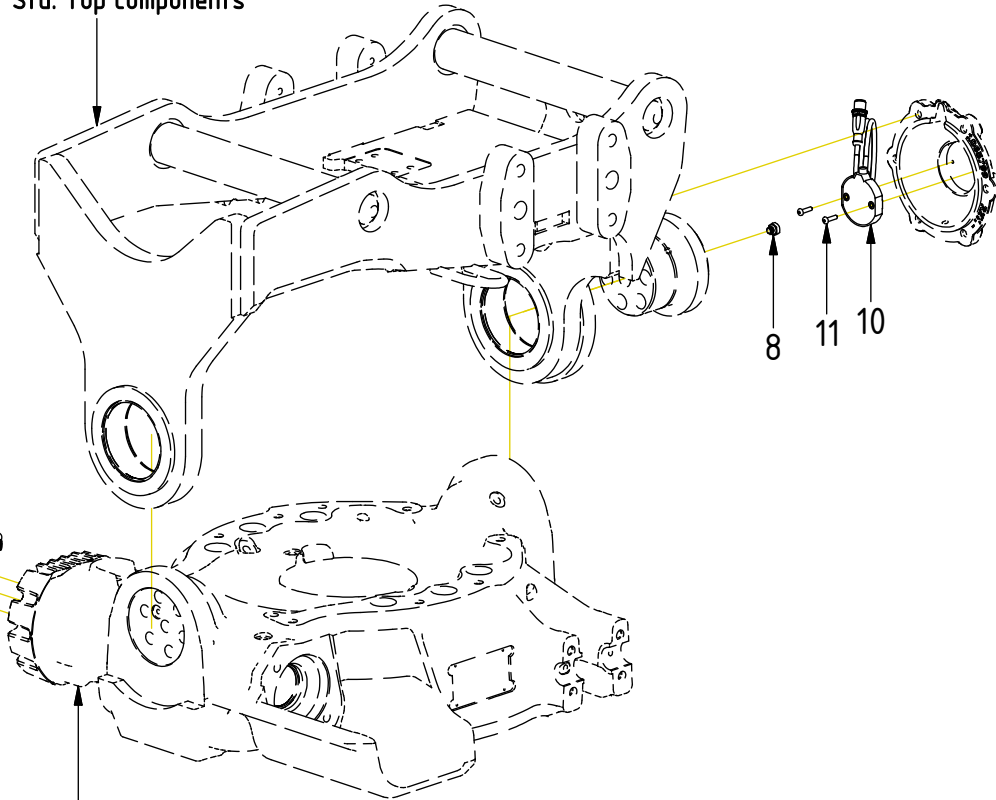

Exploded view
Rotator frame

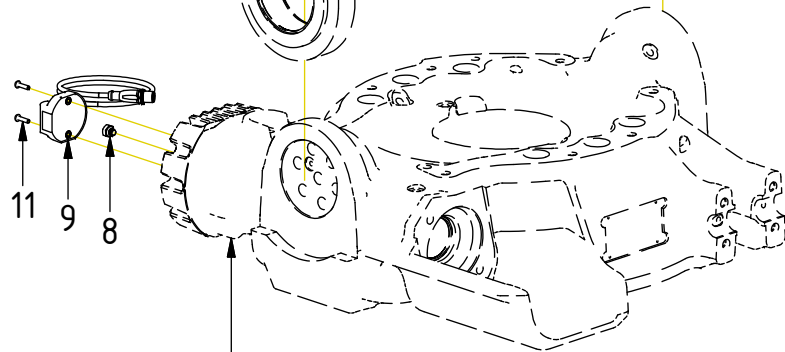

DC3 EC-Oil:

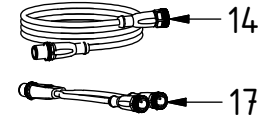

DC2 EC-Oil:

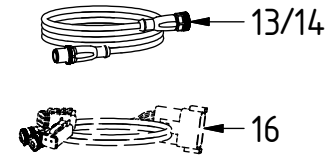

DC2 without EC-Oil:

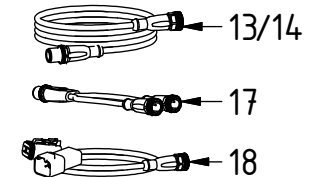

ss9/ss10(SVAB) EC-Oil:

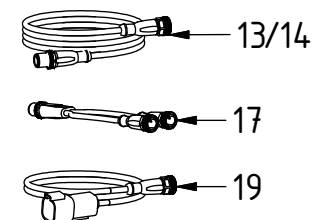

ss9/ss10(SVAB) without EC-Oil:

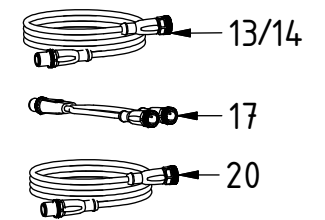

EC204B
DC2 EC-Oil

| POS | DESCRIPTION | PART | QTY | COMMENTS |
|-----|------------------------------------|---------|-----|---------------------------|
| 1 | Rotation sensor EC204B | 8002455 | 1 | White side against magnet |
| 2 | Tilt angle sensor EC204B | 8002467 | 1 | White side against magnet |
| 3 | Powerplug ECO40W Left 2xM12 204B | 8002454 | 1 | Part of EC-Oil components |
| 4 | Adapter cable tilt sensor EC204B | 8002471 | 1 | |
| 5 | Y-split EC204B | 8002474 | 1 | |
| 6 | Aggregate cable DC2 1xM12 EC204B | 8002470 | 1 | Part of control system |
| 7 | Adapter cable ss9 w. 120 ohm term. | 8002495 | 1 | |
| ● | Use cable ties | | | |

POS in order of assembly

Photo needed: control system photo,
how POS.3 is connected

DC2 without EC-Oil:

Photo needed: control system photo,
how POS.5-6 are connected

Photo needed: top part photo,
how POS.2 is connected

Photo needed: control system photo,
how POS.2 & 4 are connected

EC206B
DC2 EC-Oil

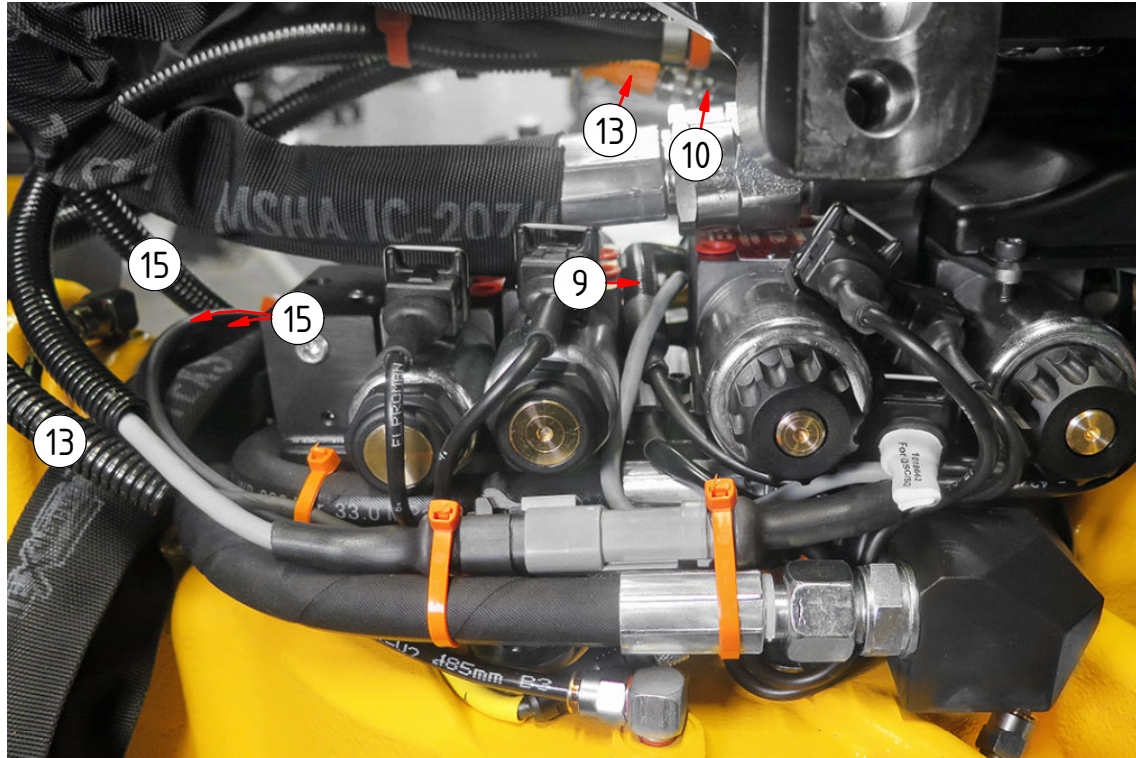

| POS | DESCRIPTION | PART | QTY | COMMENTS |
|-----|----------------------------------|---------|-----|---|
| 9 | Rotation sensor | 8001543 | 1 | White side against magnet |
| 10 | Tilt angle sensor | 8001544 | 1 | White side against magnet |
| 13 | Adapter cable tilt sensor 600mm | 8001610 | 1 | Cable cover: 405mm for EC206B, 495mm for EC209B |
| 15 | Powerplug ECO40W Left 2xM12 206B | 8001885 | 1 | Part of EC-Oil components |
| 17 | Y-split M12 EVC614 | 1069559 | 1 | |
| 18 | Adapter cable DC2 | 8000783 | 1 | |
| ● | Use cable ties | | | |

POS in order of assembly

DC2 without EC-Oil:

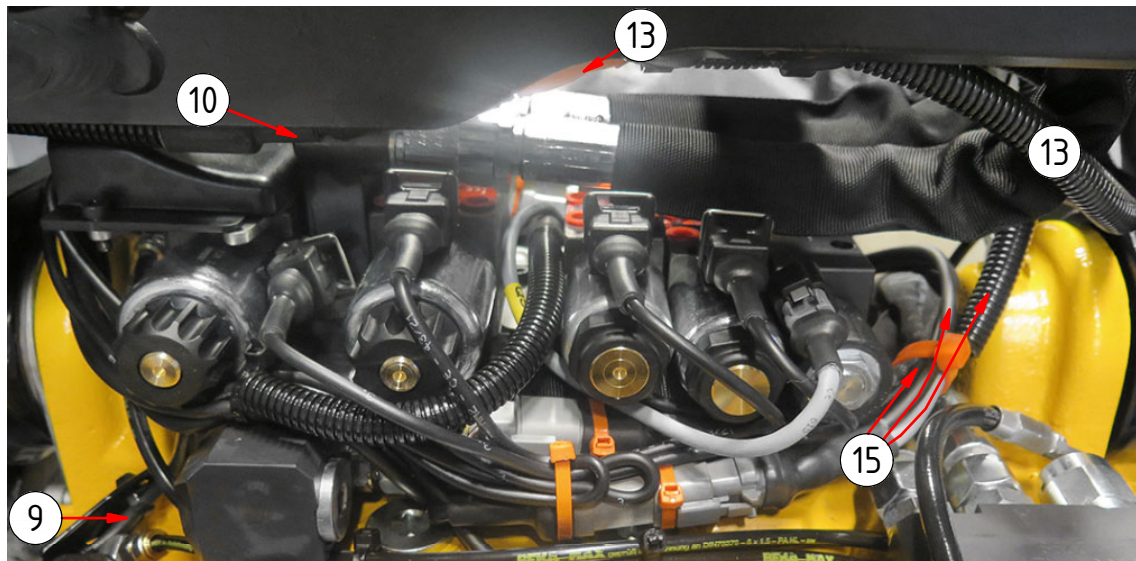
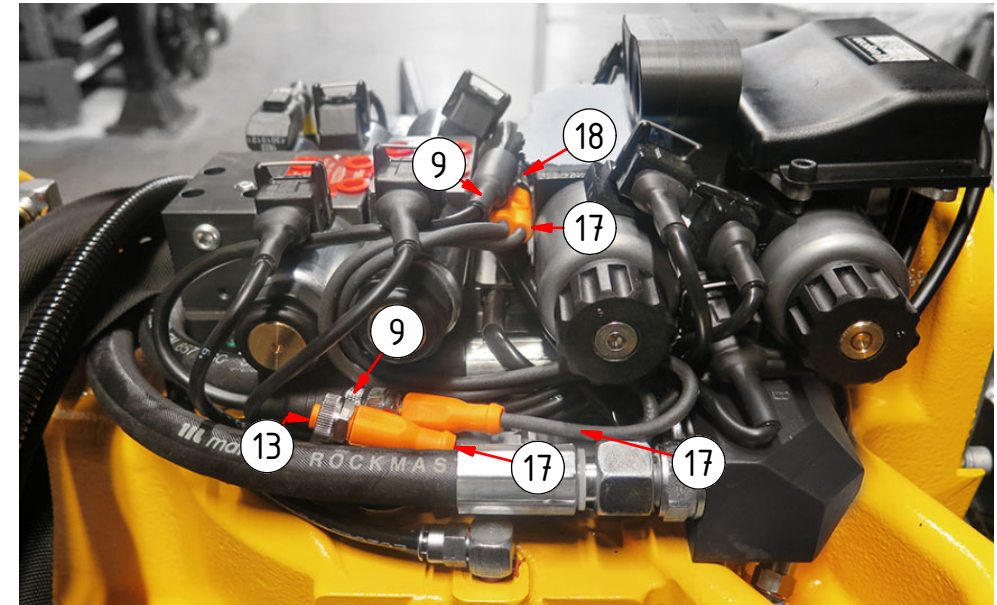

UNI:

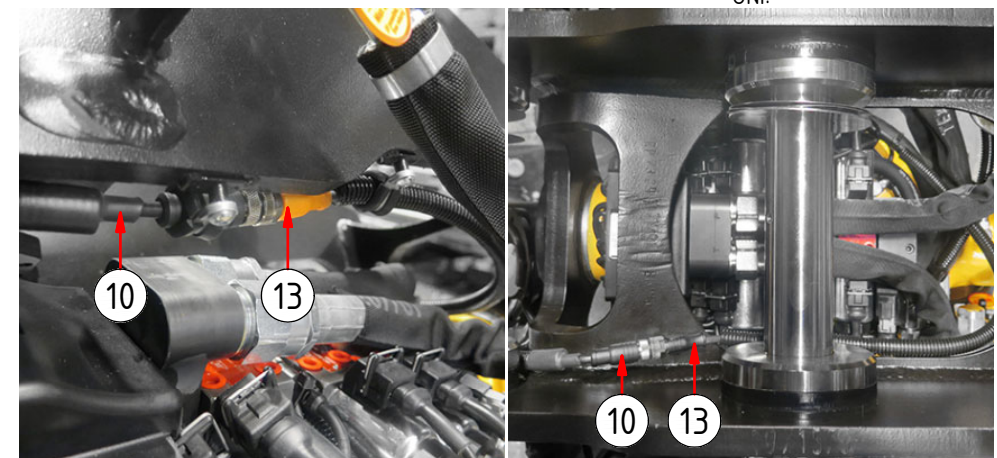

EC206B

ss9/ss10 (SVAB) EC-Oil

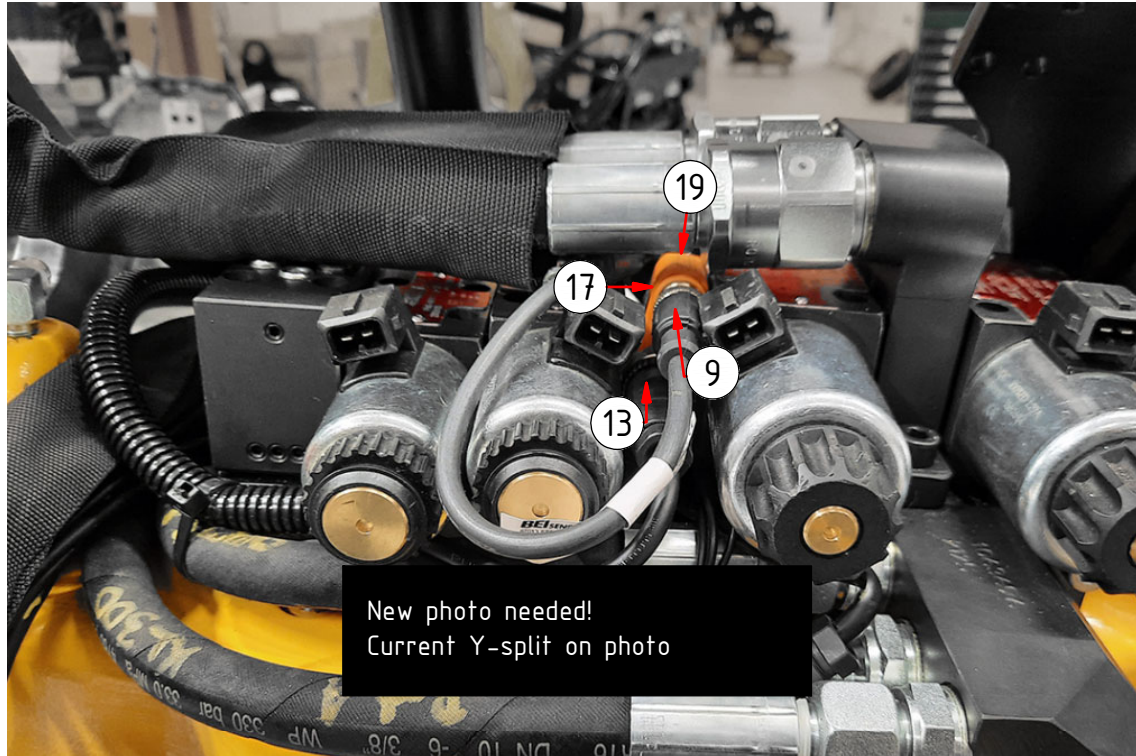

| POS | DESCRIPTION | PART | QTY | COMMENTS |
|-----|-----------------------------------|---------|-----|---|
| 9 | Rotation sensor | 8001543 | 1 | White side against magnet |
| 10 | Tilt angle sensor | 8001544 | 1 | White side against magnet |
| 13 | Adapter cable tilt sensor 600mm | 8001610 | 1 | Cable cover: 405mm for EC206B, 495mm for EC209B |
| 17 | Y-split M12 EVC614 | 1069559 | 1 | |
| 19 | Ad.cable ss9/SVAB ECOW 120 ohm | 8000825 | 1 | |
| 20 | Ad.cable ss9/SVAB w. 120 ohm ter. | 8000824 | 1 | |

ss9/ss10 (SVAB) without EC-Oil:

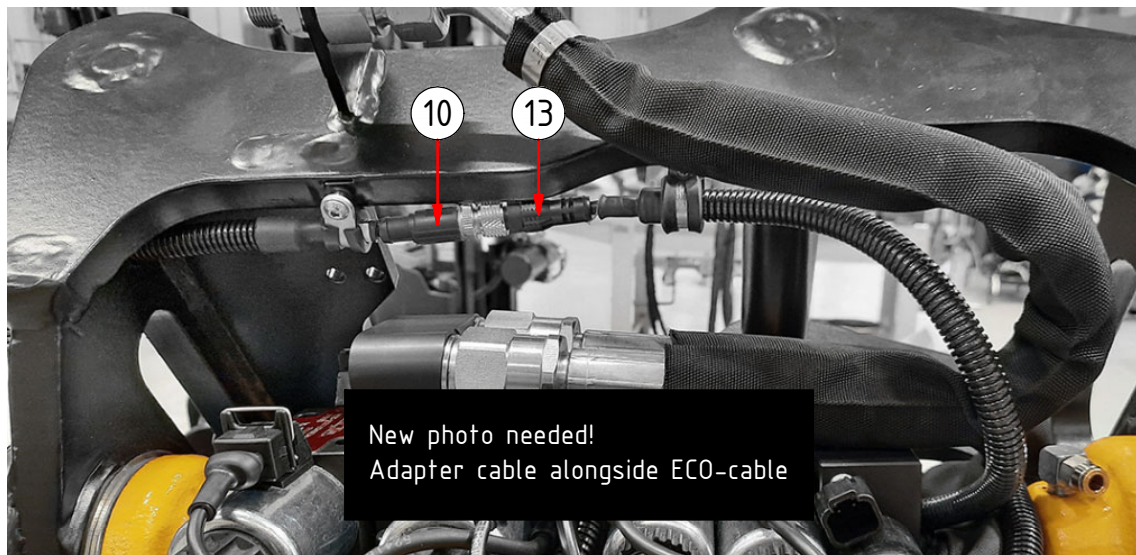
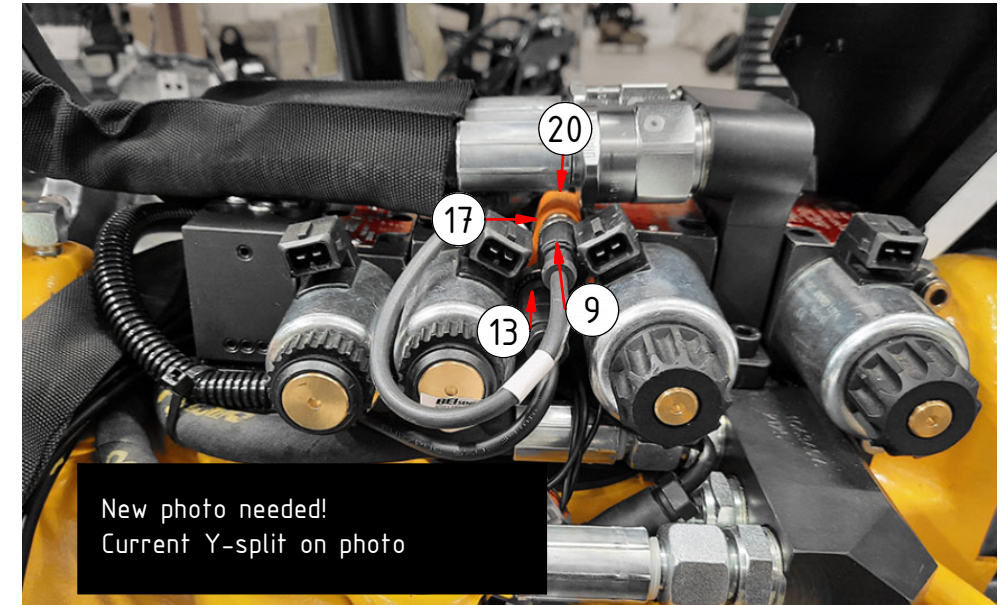

UNI:

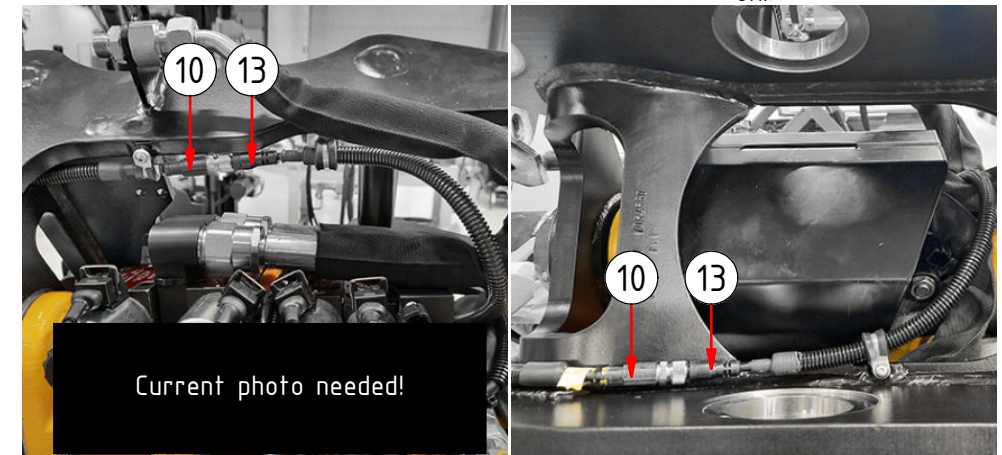

EC209B
DC2 EC-Oil

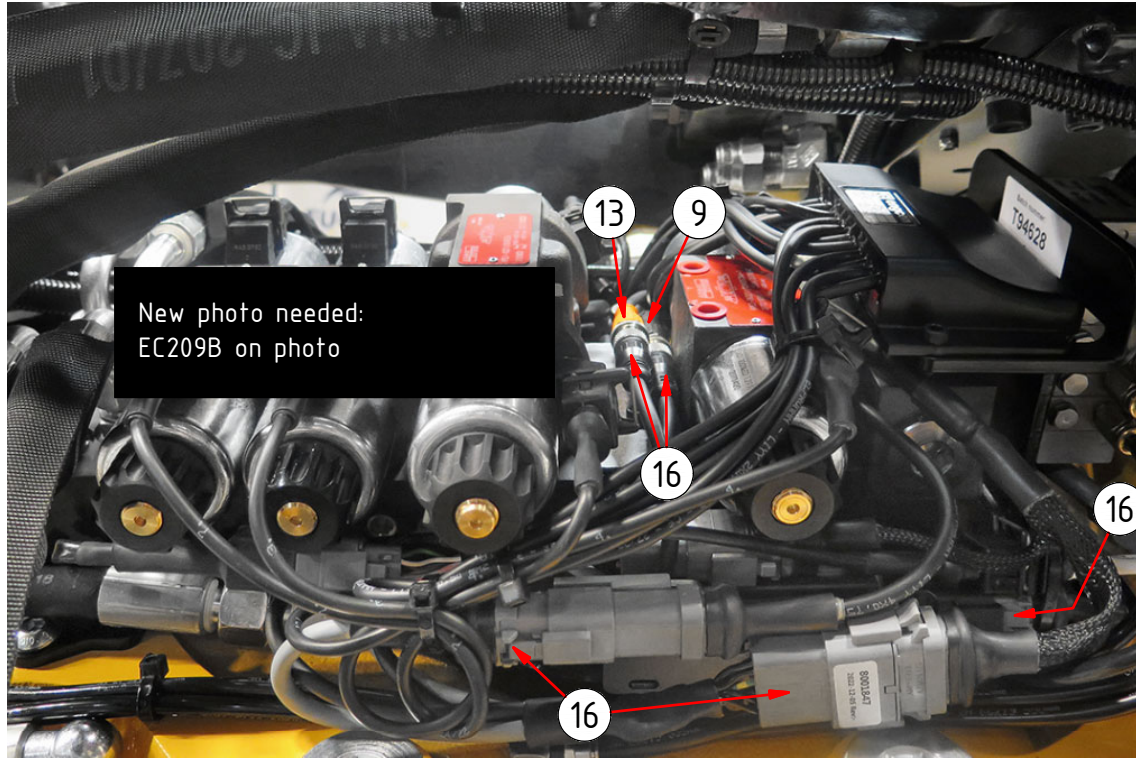

| POS | DESCRIPTION | PART | QTY | COMMENTS |
|-----|---------------------------------|---------|-----|---|
| 9 | Rotation sensor | 8001543 | 1 | White side against magnet |
| 10 | Tilt angle sensor | 8001544 | 1 | White side against magnet |
| 13 | Adapter cable tilt sensor 600mm | 8001610 | 1 | Cable cover: 405mm for EC206B, 495mm for EC209B |
| 16 | Adapter cable ECO W DC2 ePS2 | 8001847 | 1 | Part of Control system |
| 17 | Y-split M12 EVC614 | 1069559 | 1 | |
| 18 | Adapter cable DC2 | 8000783 | 1 | |
| ● | Use cable ties | | | |

POS in order of assembly

DC2 without EC-Oil:

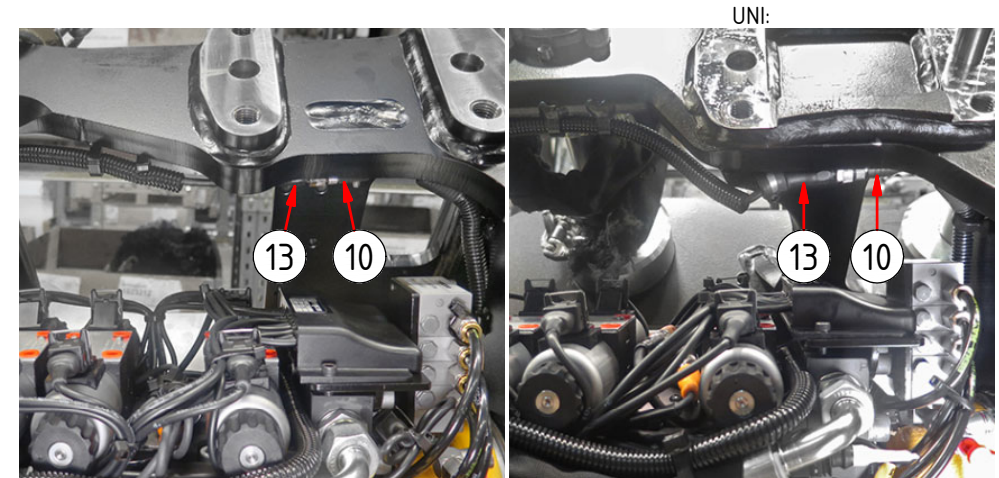
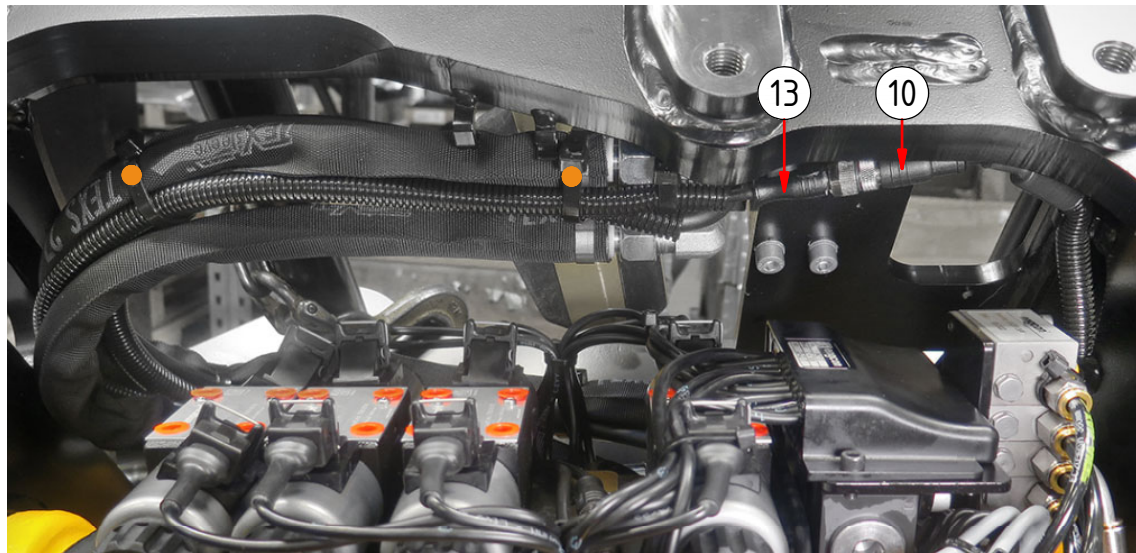
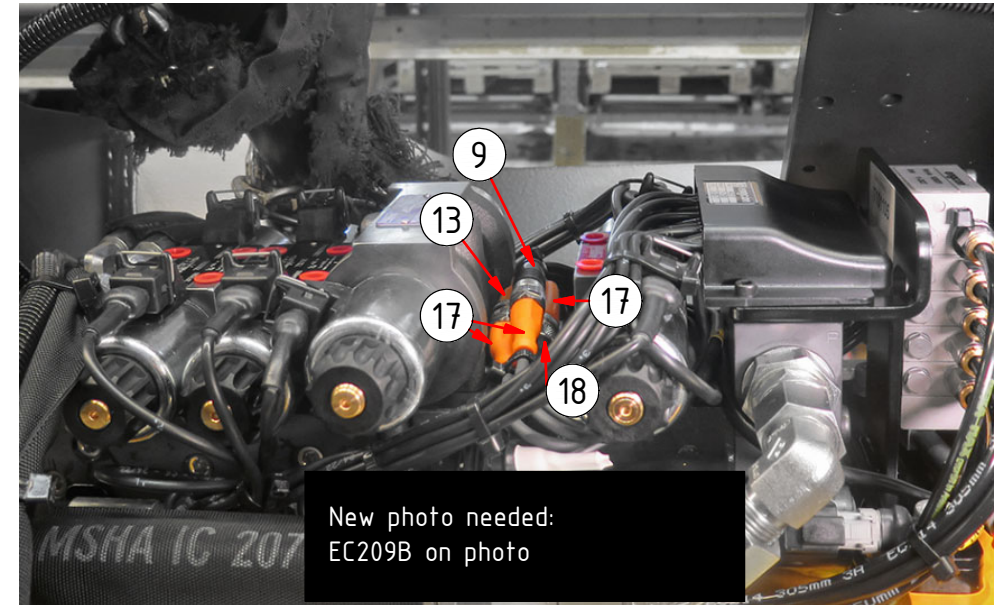

EC209B

ss9/ss10 (SVAB) EC-Oil

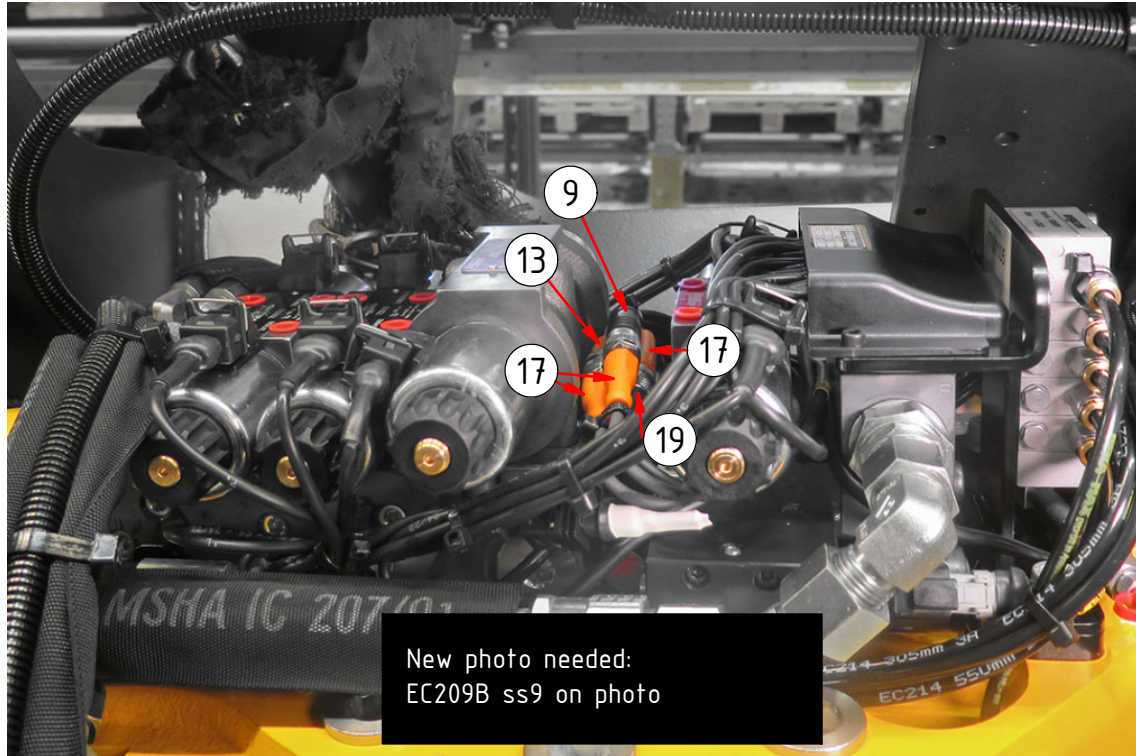

| POS | DESCRIPTION | PART | QTY | COMMENTS |
|-----|-----------------------------------|---------|-----|---|
| 9 | Rotation sensor | 8001543 | 1 | White side against magnet |
| 10 | Tilt angle sensor | 8001544 | 1 | White side against magnet |
| 13 | Adapter cable tilt sensor 600mm | 8001610 | 1 | Cable cover: 405mm for EC206B, 495mm for EC209B |
| 17 | Y-split M12 EVC614 | 1069559 | 1 | |
| 19 | Ad.cable ss9/SVAB ECOW 120 ohm | 8000825 | 1 | |
| 20 | Ad.cable ss9/SVAB w. 120 ohm ter. | 8000824 | 1 | |
| ● | Use cable ties | | | |

ss9/ss10 (SVAB) without EC-Oil:

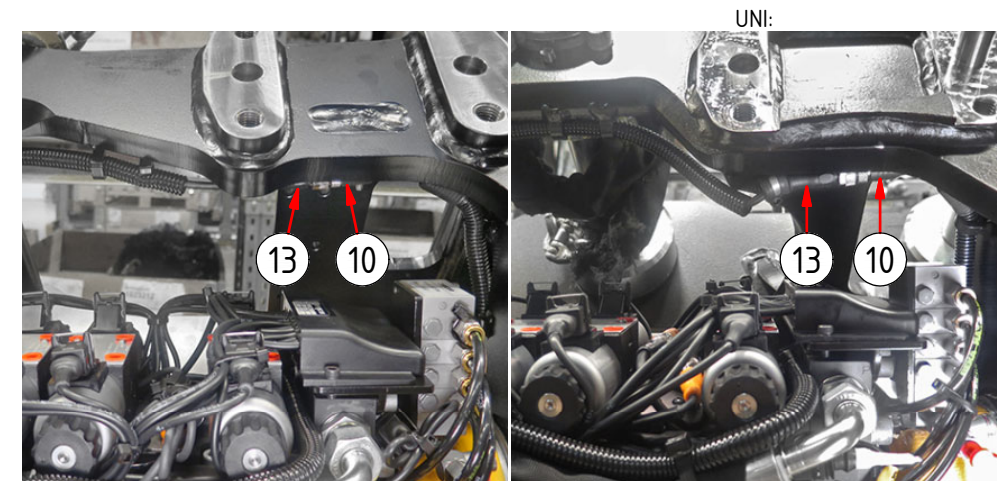
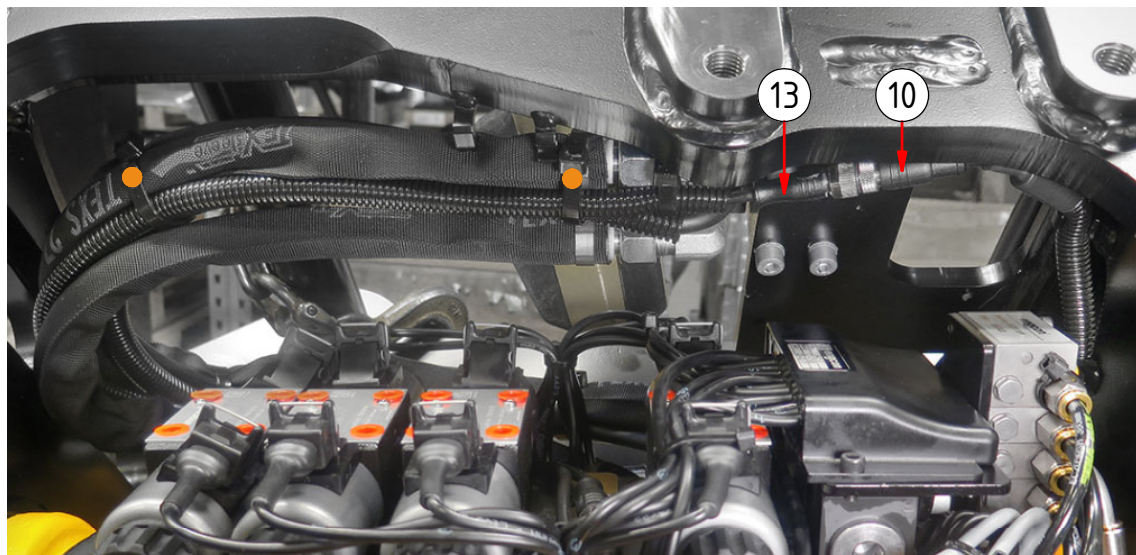
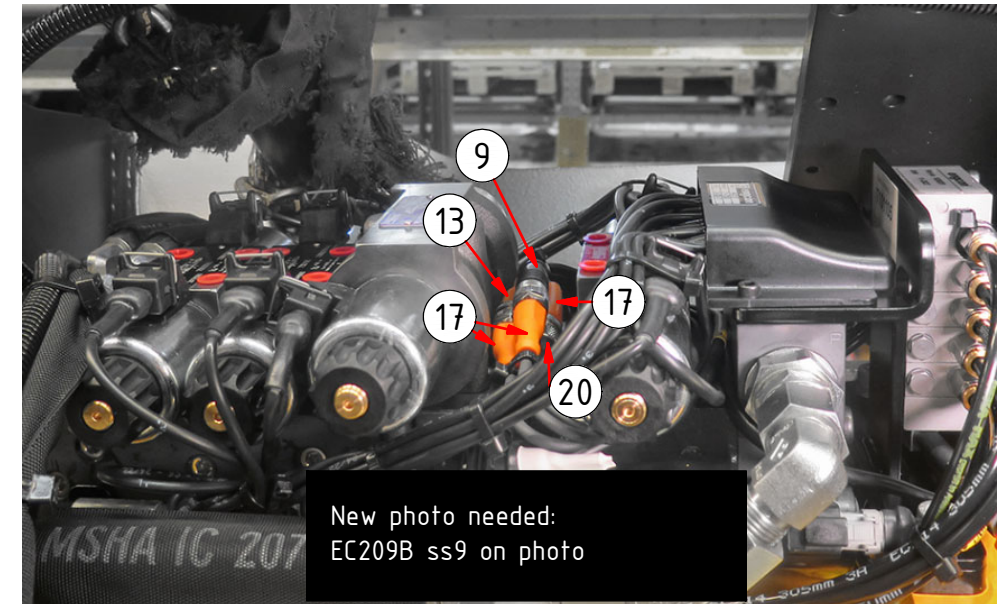

EC214-EC219
DC2 EC-Oil

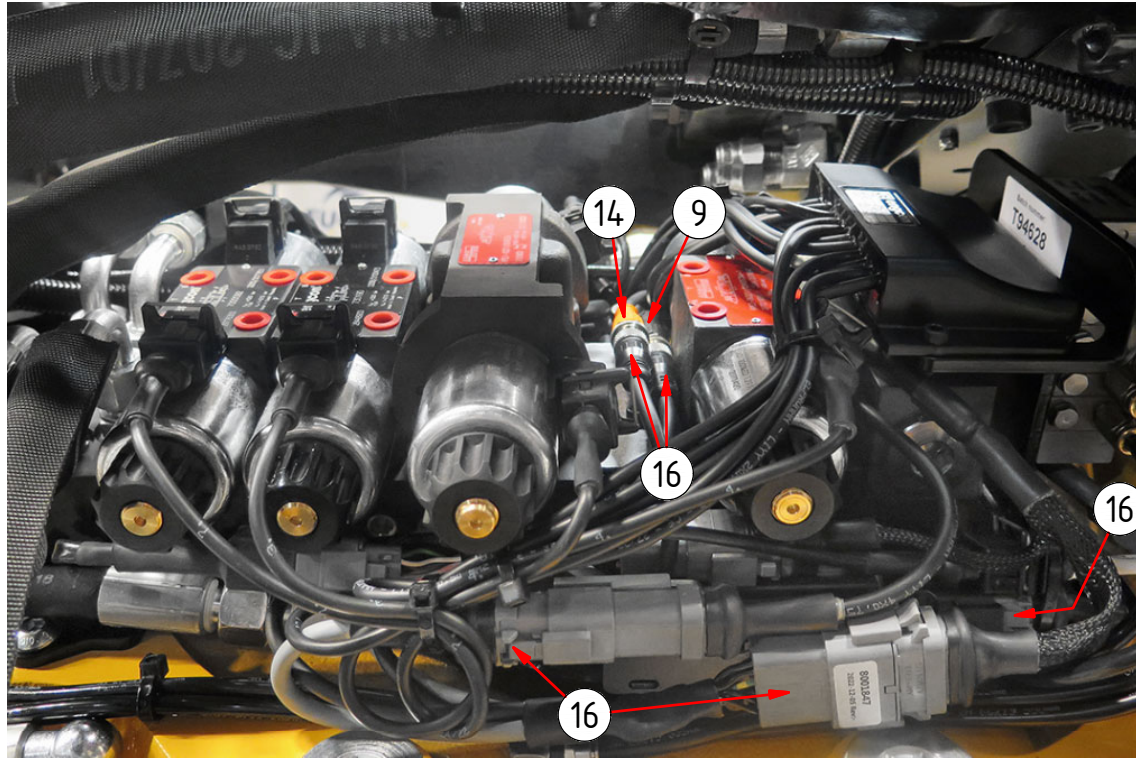

| POS | DESCRIPTION | PART | QTY | COMMENTS |
|-----|----------------------------------|---------|-----|----------------------------------|
| 9 | Rotation sensor | 8001543 | 1 | White side against magnet |
| 10 | Tilt angle sensor | 8001544 | 1 | White side against magnet |
| 14 | Adapter cable tilt sensor 1200mm | 8001611 | 1 | Cable cover: 800mm for EC214-233 |
| 16 | Adapter cable ECO W DC2 ePS2 | 8001847 | 1 | Part of Control system |
| 17 | Y-split M12 EVC614 | 1069559 | 1 | |
| 18 | Adapter cable DC2 | 8000783 | 1 | |
| ● | Use cable ties | | | |

POS in order of assembly

DC2 without EC-Oil:

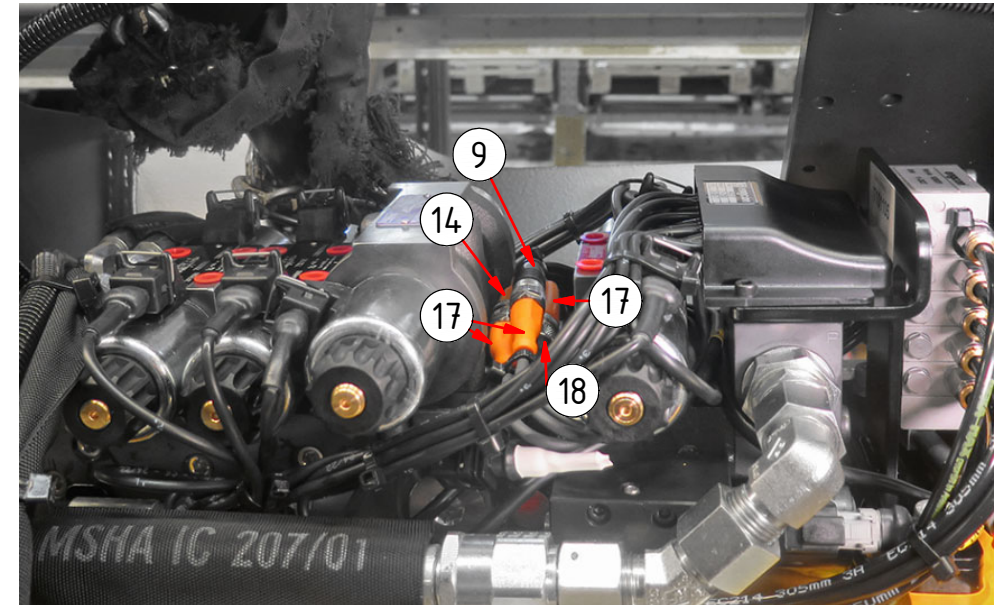

EC214:

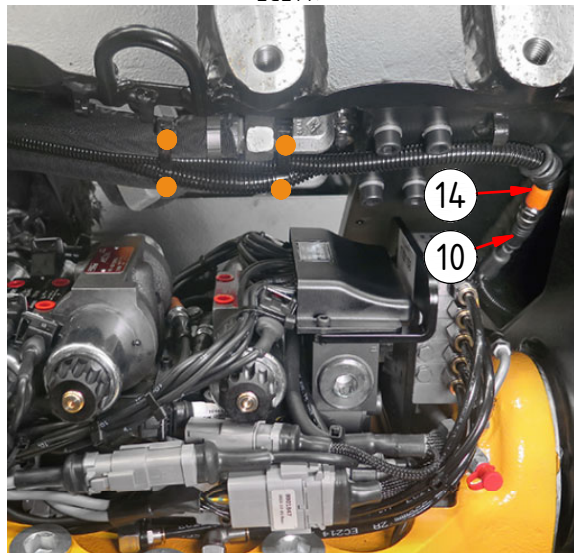

EC219:

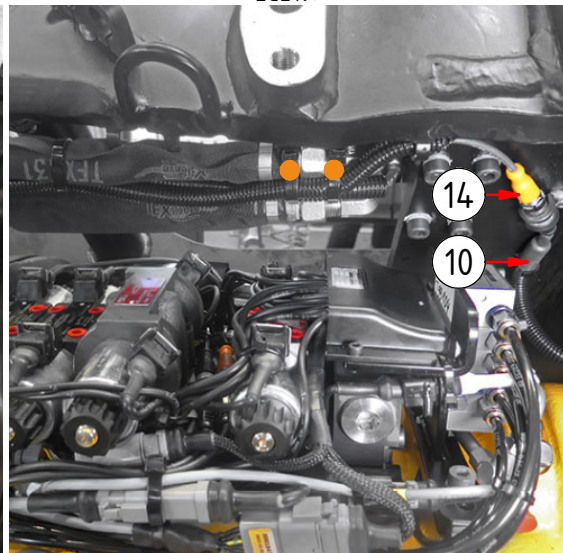

EC214:

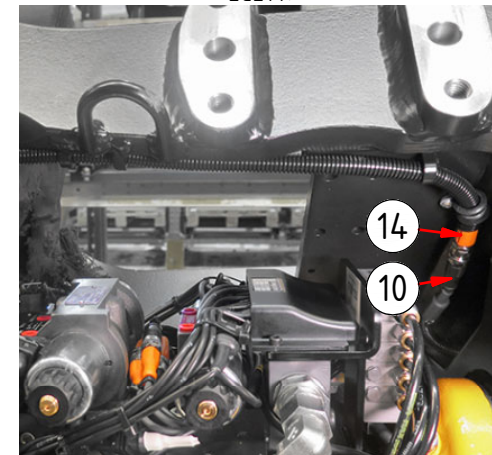

EC219:

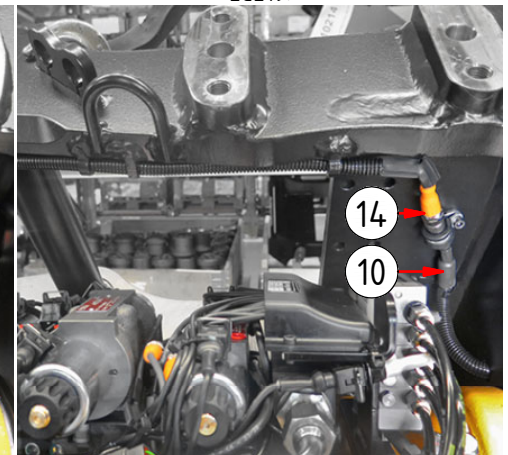

EC214-EC219

ss9/ss10 (SVAB) EC-Oil

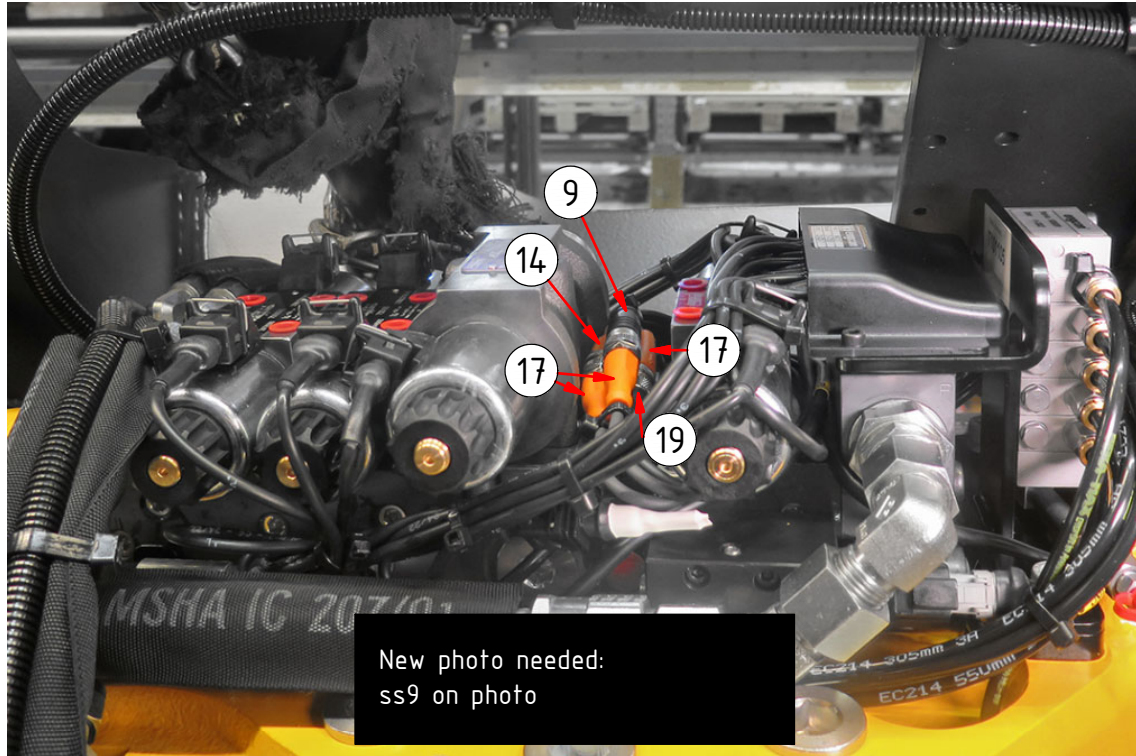

| POS | DESCRIPTION | PART | QTY | COMMENTS |
|-----|-----------------------------------|---------|-----|----------------------------------|
| 9 | Rotation sensor | 8001543 | 1 | White side against magnet |
| 10 | Tilt angle sensor | 8001544 | 1 | White side against magnet |
| 14 | Adapter cable tilt sensor 1200mm | 8001611 | 1 | Cable cover: 800mm for EC214-233 |
| 17 | Y-split M12 EVC614 | 1069559 | 1 | |
| 19 | Ad.cable ss9/SVAB ECOW 120 ohm | 8000825 | 1 | |
| 20 | Ad.cable ss9/SVAB w. 120 ohm ter. | 8000824 | 1 | |
| ● | Use cable ties | | | |

ss9/ss10 (SVAB) without EC-Oil:

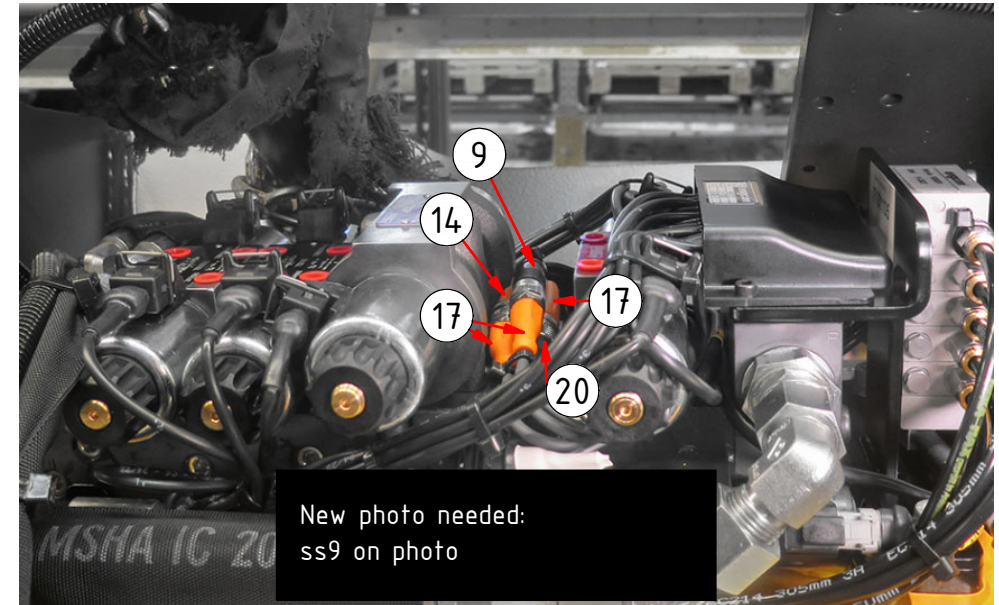

EC214:

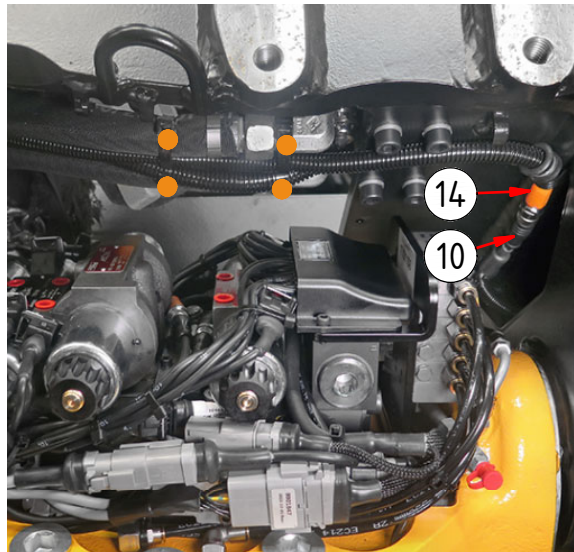

EC219:

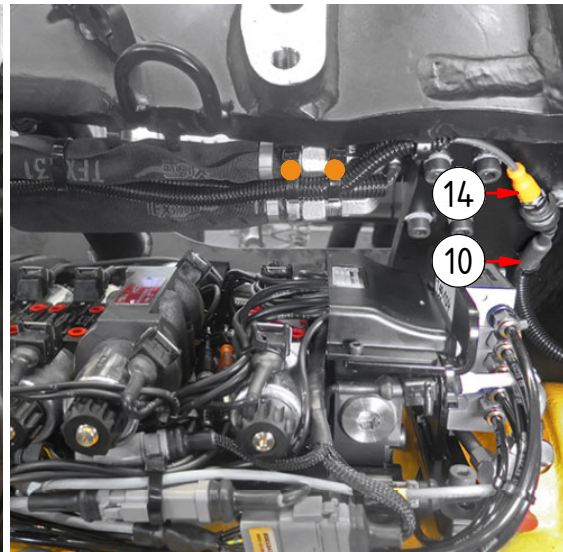

EC214:

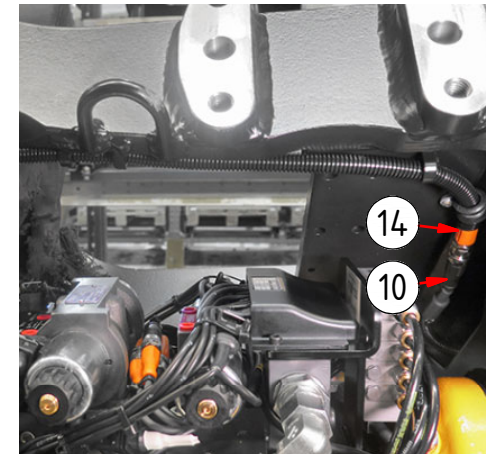

EC219:

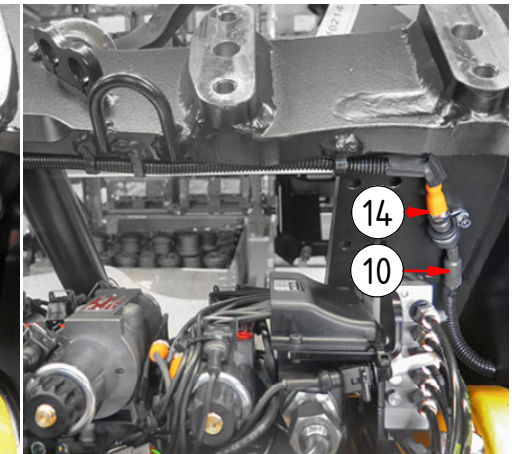

EC226
DC3 EC-Oil

| POS | DESCRIPTION | PART | QTY | COMMENTS |
|-----|----------------------------------|---------|-----|----------------------------------|
| 9 | Rotation sensor | 8001543 | 1 | White side against magnet |
| 10 | Tilt angle sensor | 8001544 | 1 | White side against magnet |
| 14 | Adapter cable tilt sensor 1200mm | 8001611 | 1 | Cable cover: 800mm for EC214-233 |
| 17 | Y-split M12 EVC614 | 1069559 | 1 | |

POS in order of assembly

Photo needed: control system photo,
how POS.17 is connected

Photo needed: top part photo,
how POS.10 is connected

EC226-EC233

DC2 EC-Oil

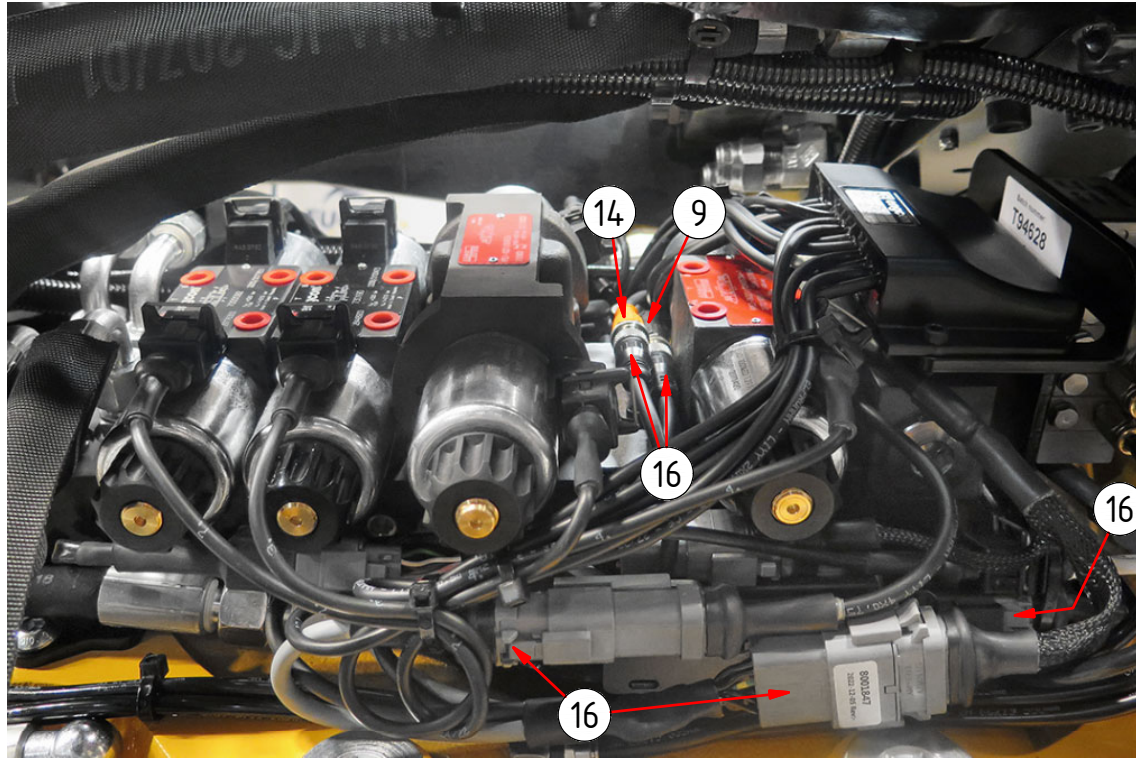

| POS | DESCRIPTION | PART | QTY | COMMENTS |
|-----|----------------------------------|---------|-----|----------------------------------|
| 9 | Rotation sensor | 8001543 | 1 | White side against magnet |
| 10 | Tilt angle sensor | 8001544 | 1 | White side against magnet |
| 14 | Adapter cable tilt sensor 1200mm | 8001611 | 1 | Cable cover: 800mm for EC214-233 |
| 16 | Adapter cable ECO W DC2 ePS2 | 8001847 | 1 | Part of Control system |
| 17 | Y-split M12 EVC614 | 1069559 | 1 | |
| 18 | Adapter cable DC2 | 8000783 | 1 | |
| ● | Use cable ties | | | |

POS in order of assembly

DC2 without EC-Oil:

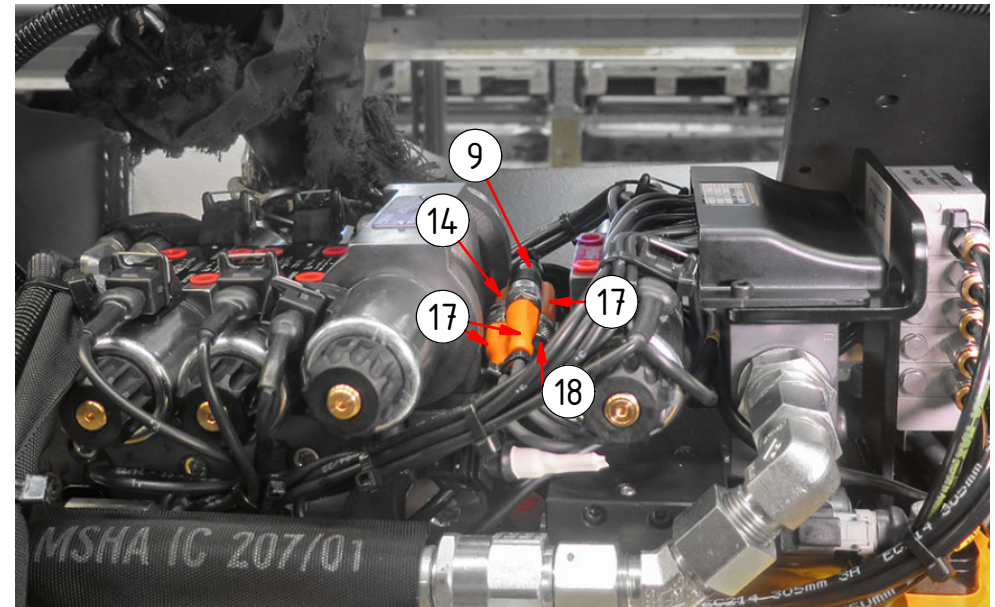

EC226:

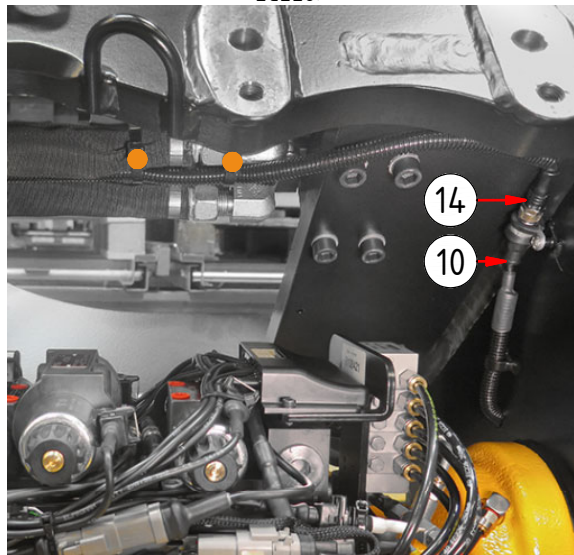

EC233:

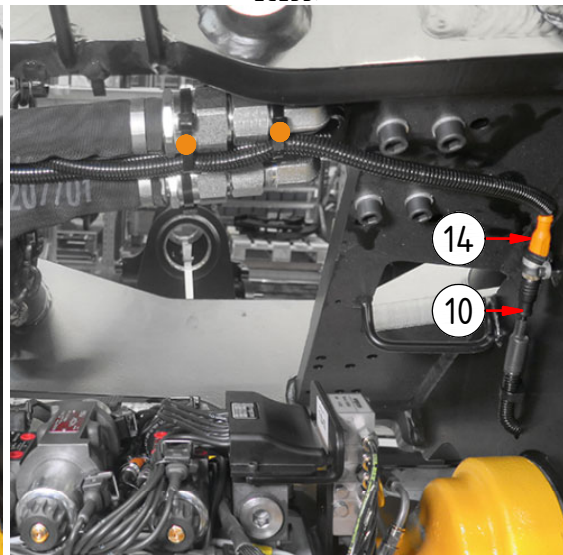

EC226-EC233

ss9/ss10 (SVAB) EC-Oil

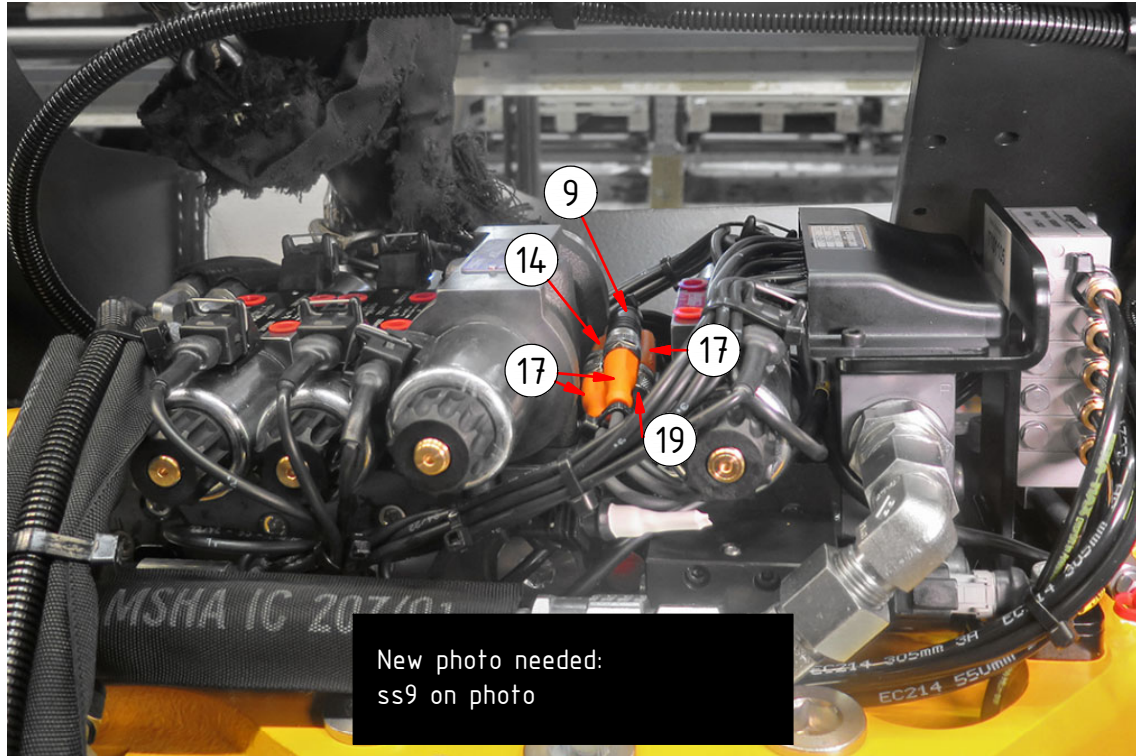

| POS | DESCRIPTION | PART | QTY | COMMENTS |
|-----|-----------------------------------|---------|-----|----------------------------------|
| 9 | Rotation sensor | 8001543 | 1 | White side against magnet |
| 10 | Tilt angle sensor | 8001544 | 1 | White side against magnet |
| 14 | Adapter cable tilt sensor 1200mm | 8001611 | 1 | Cable cover: 800mm for EC214-233 |
| 17 | Y-split M12 EVC614 | 1069559 | 1 | |
| 19 | Ad.cable ss9/SVAB ECOW 120 ohm | 8000825 | 1 | |
| 20 | Ad.cable ss9/SVAB w. 120 ohm ter. | 8000824 | 1 | |
| ● | Use cable ties | | | |

ss9/ss10 (SVAB) without EC-Oil:

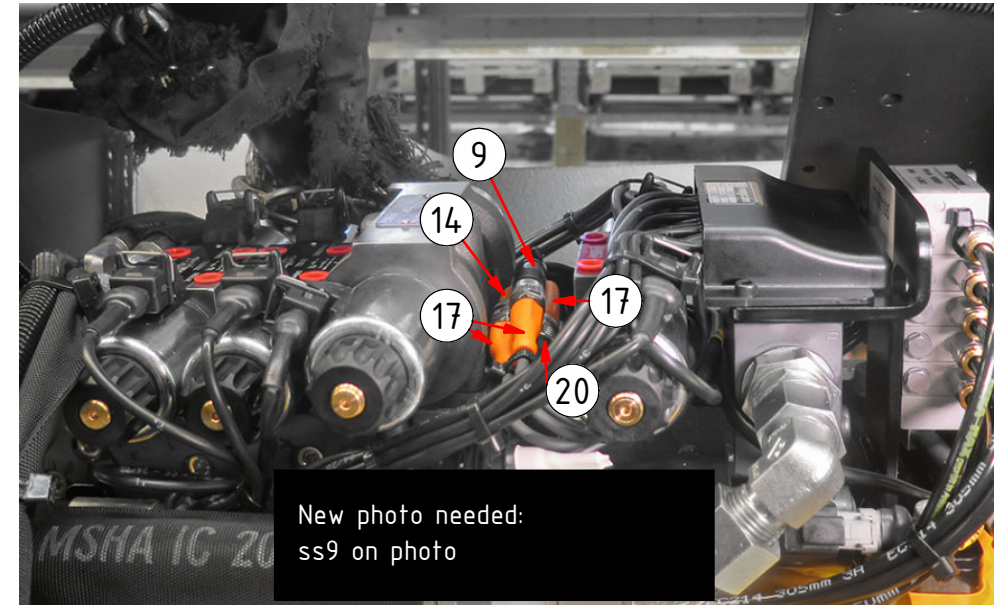

EC226:

EC233:

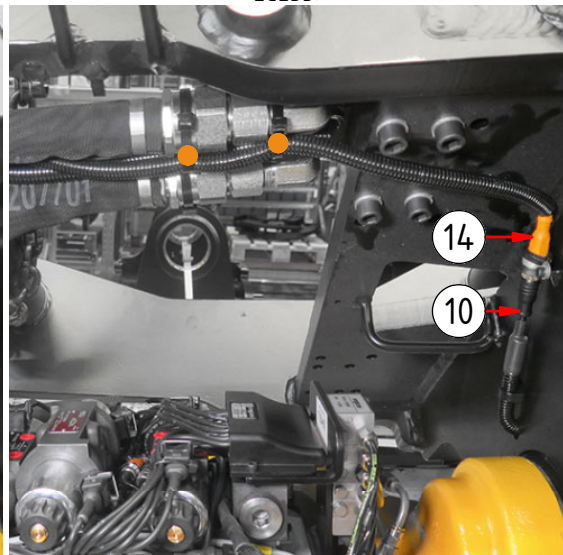
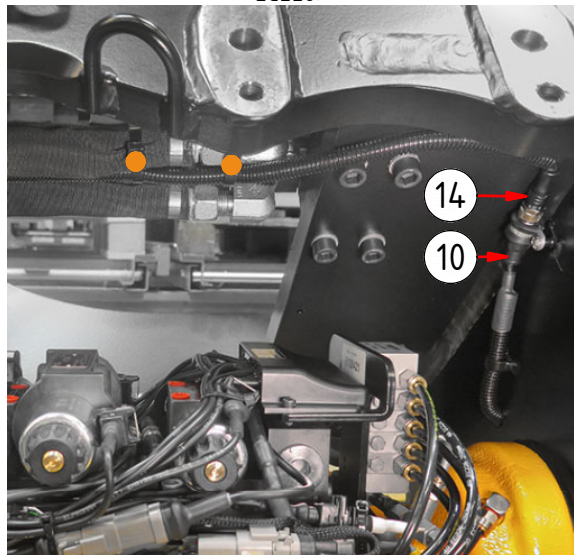

POS in order of assembly

SPARE PARTS

| POS | DESCRIPTION | PART | QTY | COMMENTS |
|-----|-------------------------------------|---------|-----|---|
| 13 | Adapter cable tilt sensor 600mm | 8001610 | 1 | Cable cover: 405mm for EC206B, 495mm for EC209B |
| 14 | Adapter cable tilt sensor 1200mm | 8001611 | 1 | Cable cover: 800mm for EC214-233 |
| 17 | Y-split M12 EVC614 | 1069559 | 1 | |
| 18 | Adapter cable DC2 | 8000783 | 1 | |
| 20 | Ad.cable ss9/SVAB w. 120 ohm ter. | 8000824 | 1 | |
| 21 | Rubber steel clamp $\varnothing 14$ | 613009 | 1 | |
| 22 | K6S M5x8 10.9 FZB | 611801 | 1 | |
| 23 | Y-split M12 EBC116 | 1065340 | 1 | Replaced by POS.17 |

POS in order of assembly



21



22

DC2 with Y-split "EBC116":

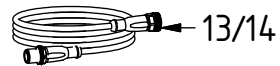

13/14



23



18

ss9/ss10 (SVAB) with Y-split "EBC116":

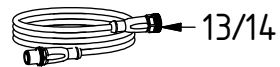

13/14



23

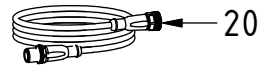

20