

## COVERSHEET

### Planned document changes:

**Briefly:**

No planned changes.

### Document changes:

**Date:**

**Change:**

**Rev.**

**after change:**

2020-04-22 New instruction.

-

# EC214 QSM - UNI Top part

POS	DESCRIPTION	PART	QTY	COMMENTS
1	Top part UNI is selected via engcon		1	
2	MC6S M16x90 12.9 ZFSHL	6000151	8	Torque: 333Nm. QTY:4 for ss0, ss9
3	Spacer terminal 20mm	1023777	4	
4	Hose terminal 8-hoses Left V2	1047137	1	
5	Hose terminal 8-hoses Right V2	1047138	1	
6	MC6S M16x120 12.9 ZFSHL	6000162	4	Torque: 333Nm
7	Shim Yoke bracket	1007041	4	For option Shimmed Tilt cylinder
8	MC6S M16x100 12.9 ZFSHL	6000156	8	Torque: 333Nm. QTY:4 for ss0, ss9
9	MC6S M16x130 12.9 ZFSHL	6000154	4	Torque: 333Nm
29	Screw Cover M16	611302	8	Part of make up

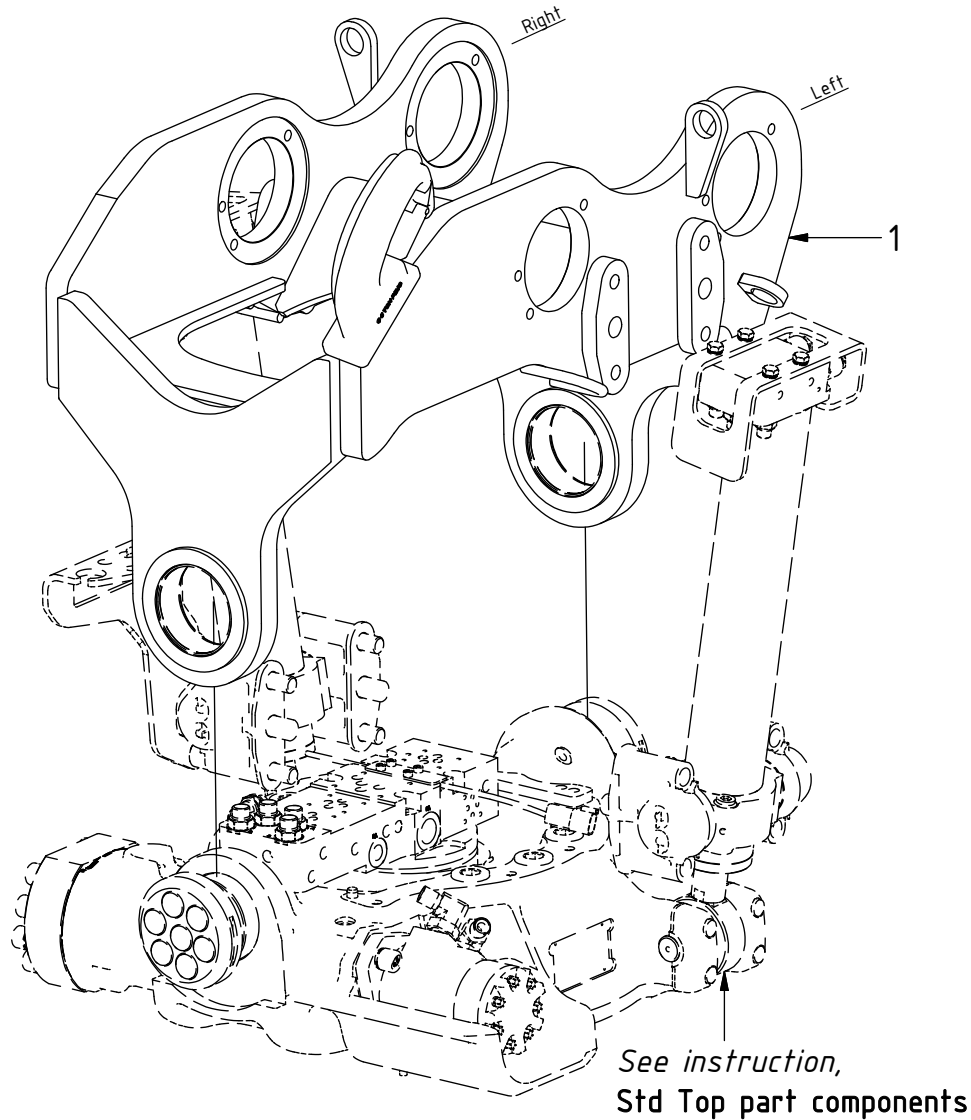

### Option FEED 3/4"

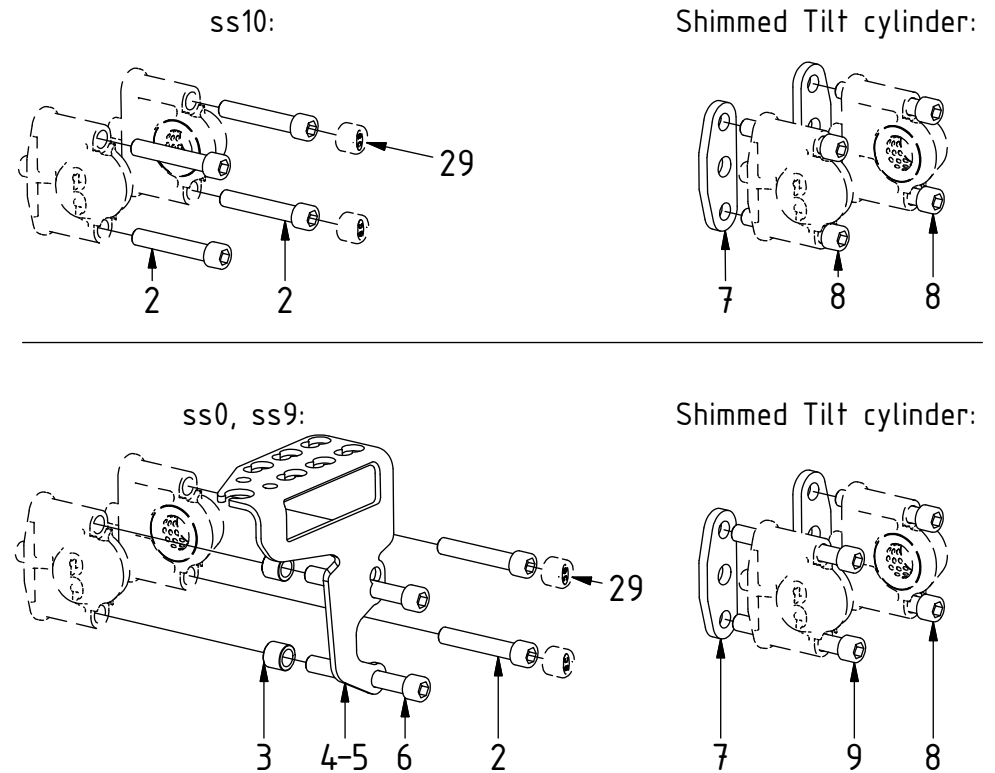

# EC214 QSM - UNI Top part

**P** = 11

**T** = 11

R, L, tilt, G on p.4

FEED

3/4"

Main Feed

POS	DESCRIPTION	PART	QTY	COMMENTS
10	For FEED 1/2" (Std)			See "Std Top part components"
11	Use washer, adapter, nut: POS.12, 13, 14			QTY depends on config. (2-3)
12	Washer NL 1"	611095	2	
13	Adapter 1260-12-12 (3/4")	712210	2	
14	Counternut 1270-12 (3/4")	712211	2	
15	Hose Bridge Feed Right	7000162	1	
16	Hose Bridge Feed Left	7000161	1	
	Attach feed hoses from control system			(a & b represents channels on feed block)

POS in order of assembly

Standard

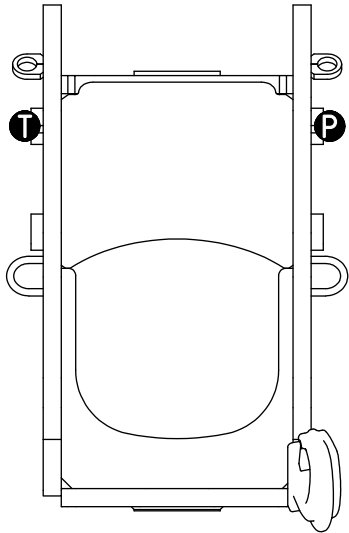

Feed Right

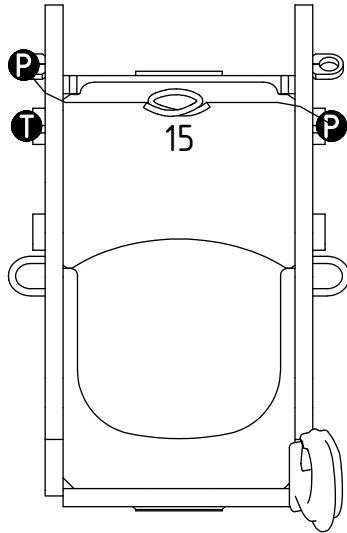

Feed Left

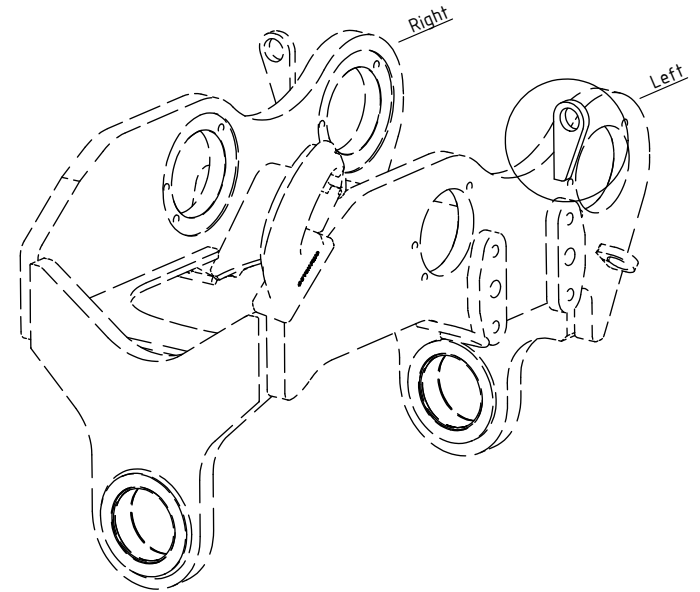
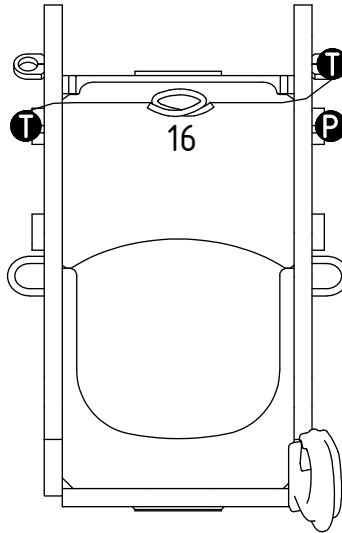

**R** = 17

**L** = 21

**filt** = 17

**G** = 17

T, P on p.3

FEED

3/4"

Rotation

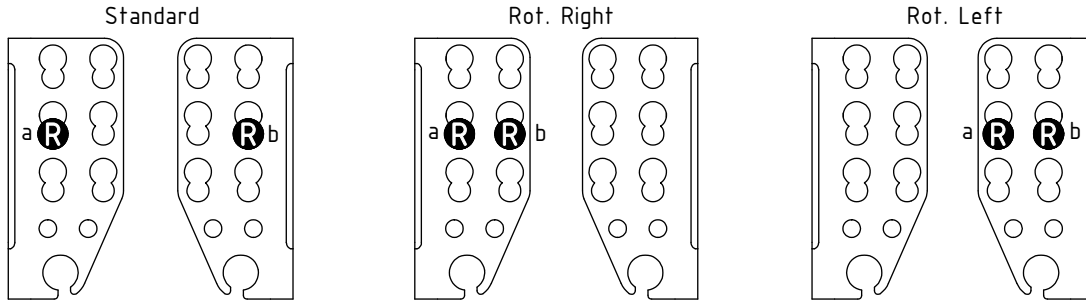

Lock (SQ)

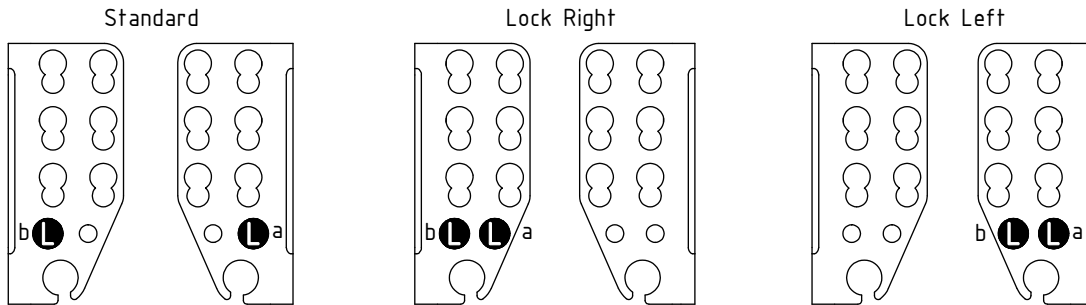

Tilt (ST)

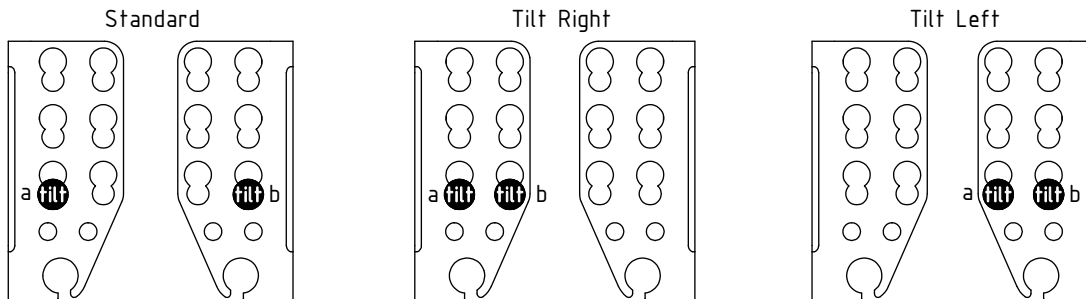

Grab (SG)

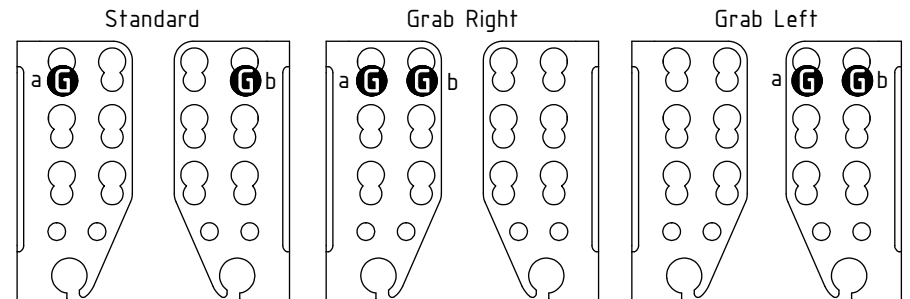

POS	DESCRIPTION	PART	QTY	COMMENTS
10	For FEED 1/2" (Std)			See "Std Top part components"
17	Use washer, adapter, nut: POS.18, 19, 20			QTY depends on config. (2-6)
18	Washer NL 16mm	611044	2	
19	Adapter 1260-06-32 (3/8")	710242	2	
20	Counternut 1270-06 (3/8")	710252	2	
21	Use washer, adapter, nut: POS.22, 23, 24			
22	Washer NL 1/2"	611096	2	
23	Adapter 1260-04-04 (1/4")	710240	2	
24	Counternut 1270-04 (1/4")	710250	2	
Attach feed hoses from control system				(a & b represents channels on feed block)

POS in order of assembly

FEED  
3/4"

POS	DESCRIPTION	PART	QTY	COMMENTS
10	For FEED 1/2" (Std)			See "Std Top part components"
	Attach feed hoses from control system			(a & b represents channels on feed block)

POS in order of assembly

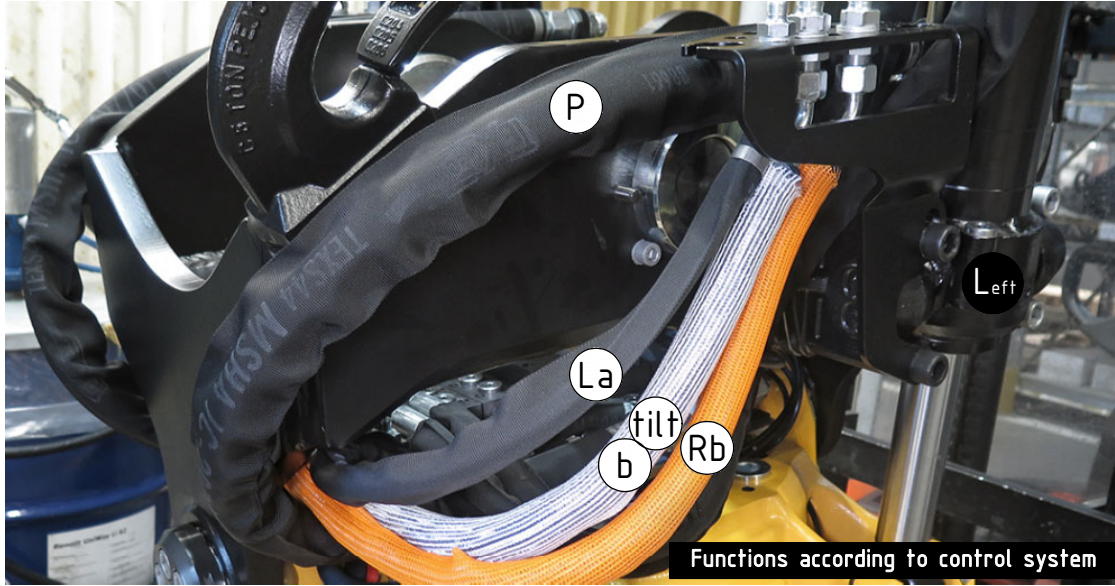

Feed Left:

Photo needed: option Feed Left

Functions according to control system

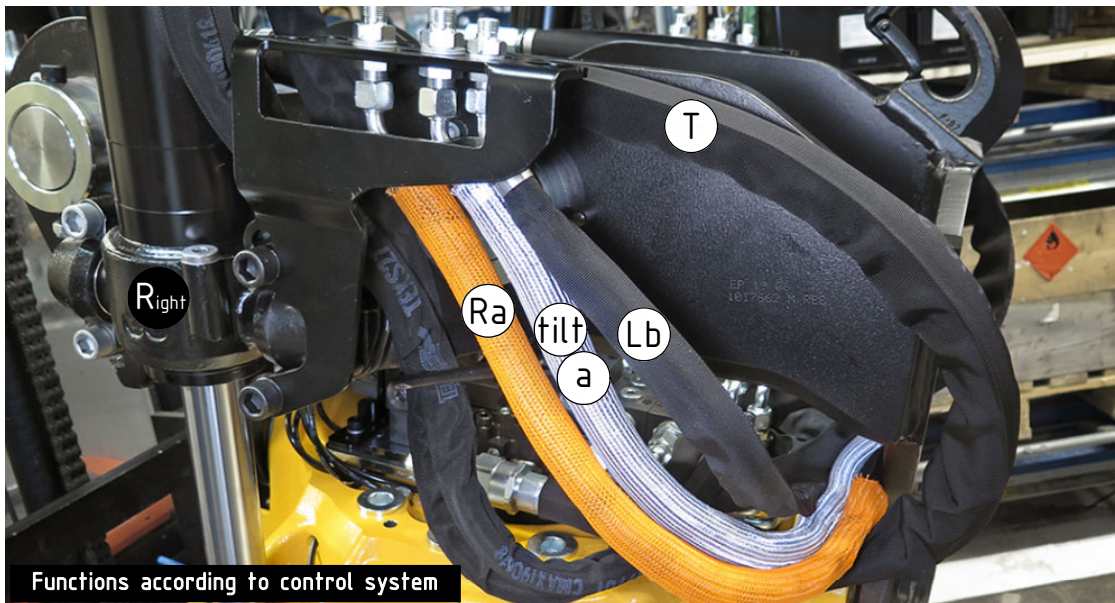

Feed Right:

Photo needed: option Feed Right

Functions according to control system