

COVERSHEET

Planned document changes:

Briefly:

Correct part no for POS.1: 1064529.

Document changes:

Date:	Change:	Rev. after change:
2020-01-22	Screws updated to ZFSHL. Photos added.	A
2020-04-09	New instruction.	-

EC214 QSM - QS60 Top part

POS	DESCRIPTION	PART	QTY	COMMENTS
1	Top part QS60 EC214	1025866	1	
2	MC6S M16x90 12.9 ZFSL	6000151	4	Torque: 333Nm
3	Spacer terminal 39mm	1005911	4	
4	Hose terminal NG10	1027200	2	
5	MC6S M16x140 12.9 ZFSL	6000152	4	Torque: 333Nm
6	Spacer terminal 20mm	1023777	4	
7	Hose terminal 8-hoses Left V2	1047137	1	
8	Hose terminal 8-hoses Right V2	1047138	1	
9	MC6S M16x120 12.9 ZFSL	6000162	4	Torque: 333Nm
10	Shim Yoke bracket	1007041	4	For option Shimmed Tilt cylinder
11	MC6S M16x100 12.9 ZFSL	6000156	4	Torque: 333Nm
12	MC6S M16x130 12.9 ZFSL	6000154	4	Torque: 333Nm
13	MC6S M16x150 12.9	610537	4	Torque: 333Nm
34	Screw Cover M16	611302	8	Part of make up

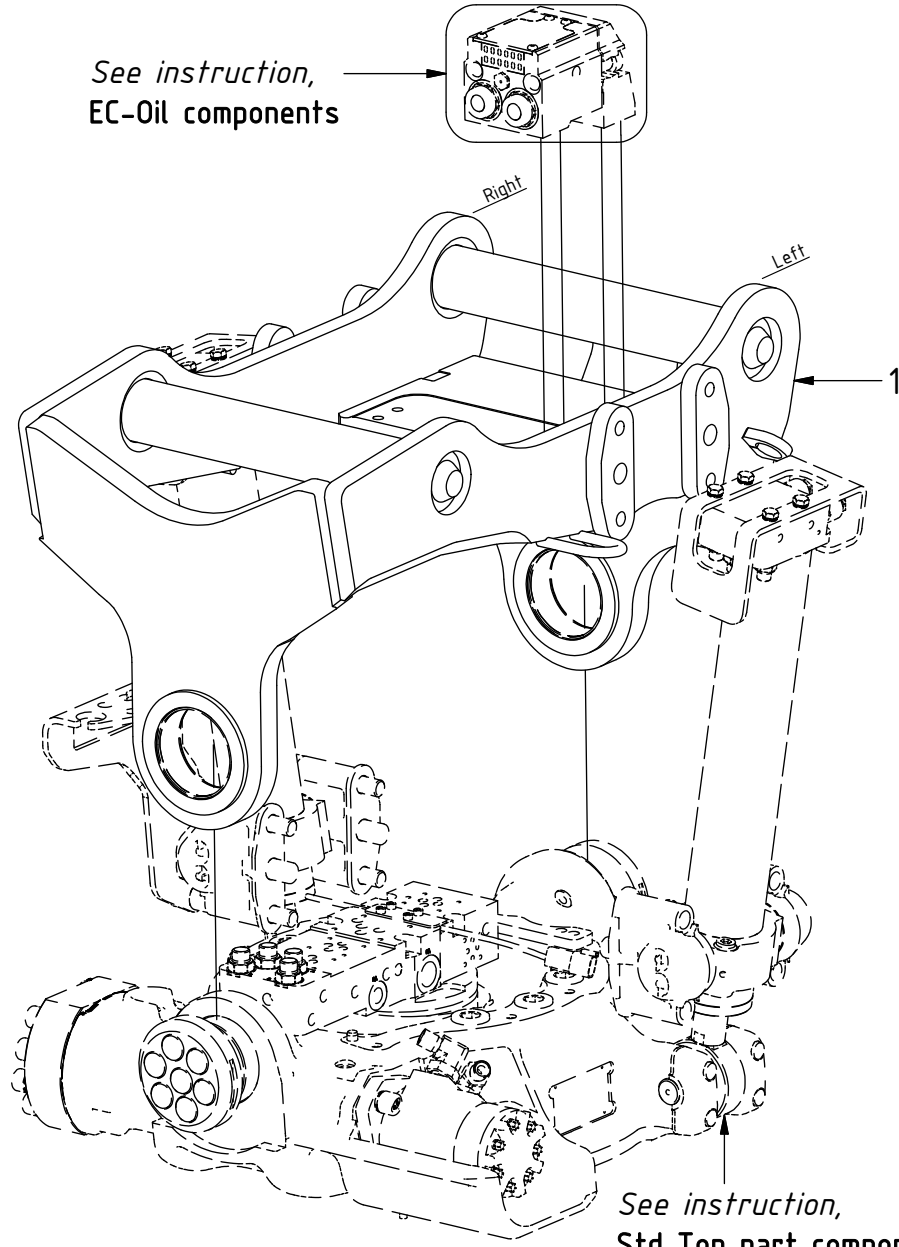

Option FEED 3/4"

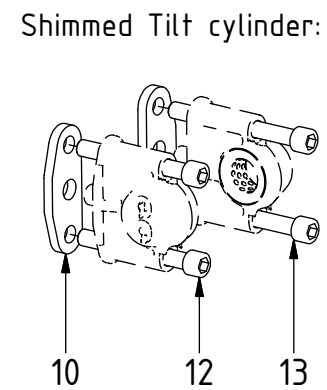
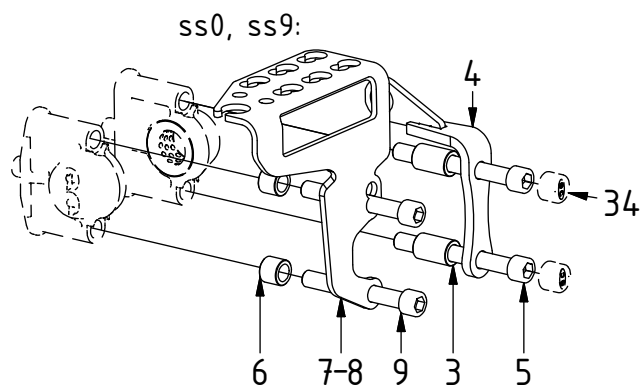
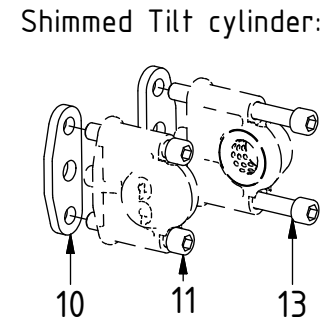
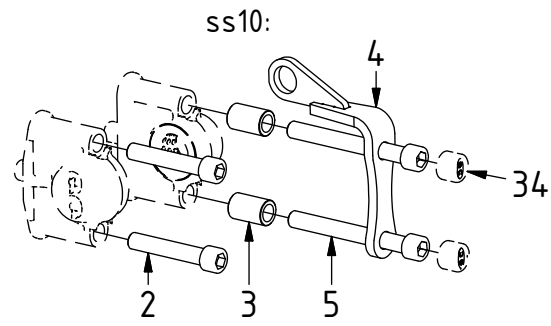

Dashed lines for overview, mounts on other pages/assemblies. indicates instruction. represents hose.

EC214 QSM - QS60 Top part

P = 15

T = 15

R, L, tilt, G on p.4

FEED

3/4"

Main Feed

POS	DESCRIPTION	PART	QTY	COMMENTS
14	For FEED 1/2" (Std)			See "Std Top part components"
15	Use washer, adapter, nut: POS.16, 17, 18			QTY depends on config. (2-3)
16	Washer NL 1"	611095	2	
17	Adapter 1260-12-12 (3/4")	712210	2	
18	Counternut 1270-12 (3/4")	712211	2	
19	Hose Bridge Feed Right	743011	1	
20	Hose Bridge Feed Left	743012	1	
	Attach feed hoses from control system			(a & b represents channels on feed block)

POS in order of assembly

Standard

Feed Right

Feed Left

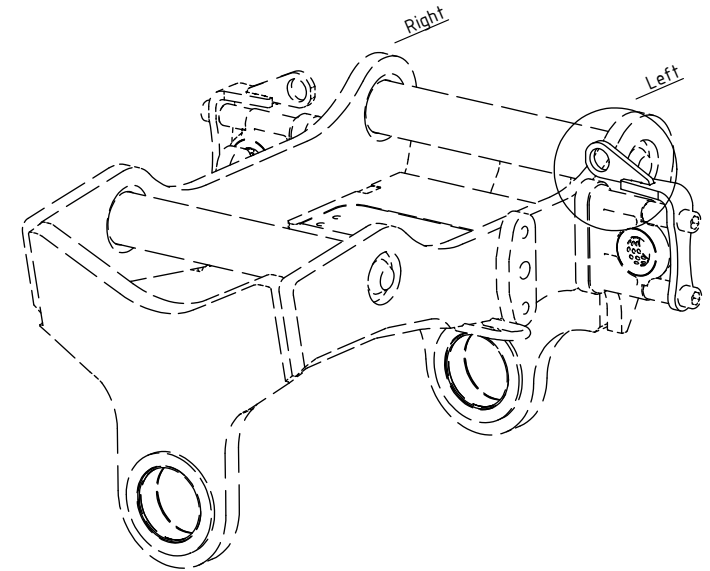
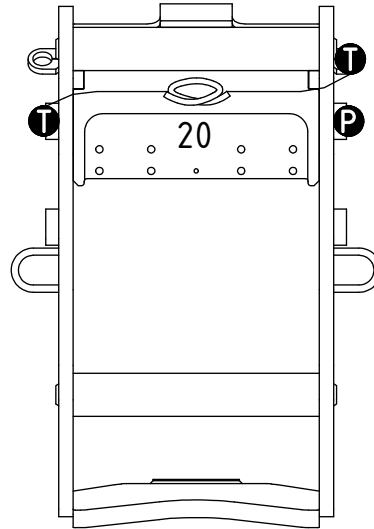
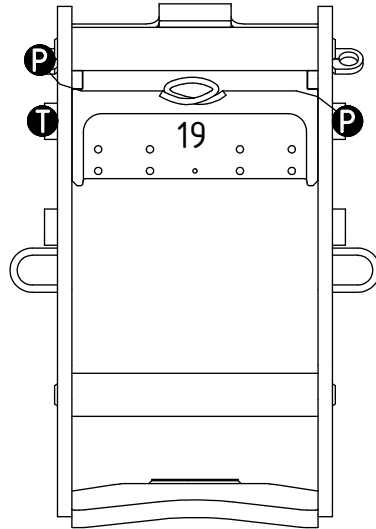
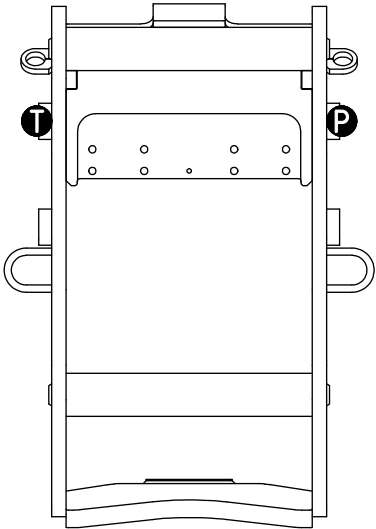

EC214 QSM - QS60 Top part

R = 21

L = 25

filt = 21

G = 21

T, P on p.3

FEED

3/4"

Rotation

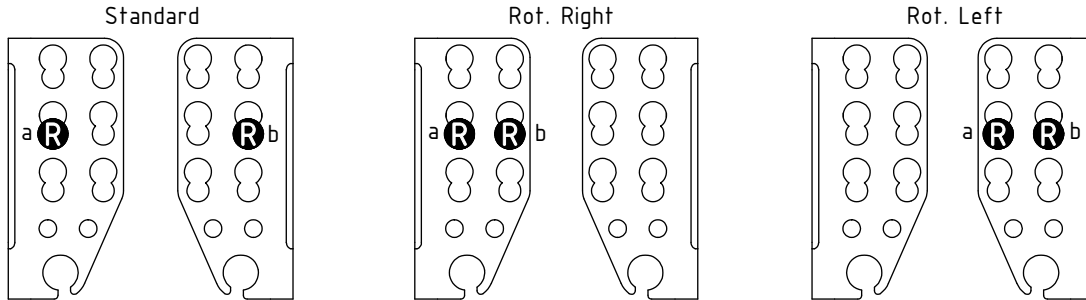

Lock (SQ)

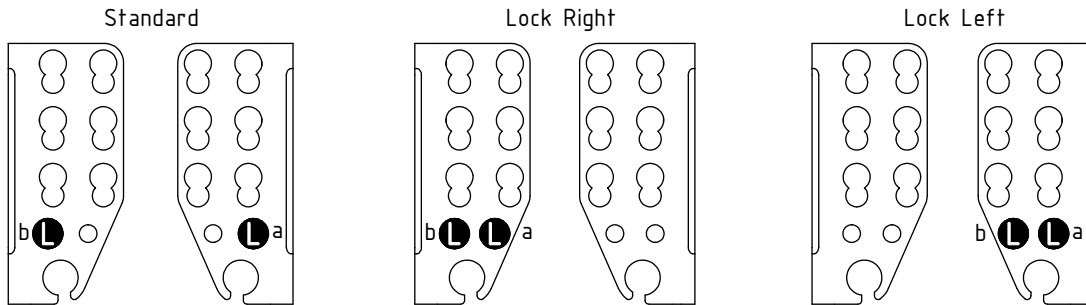

Tilt (ST)

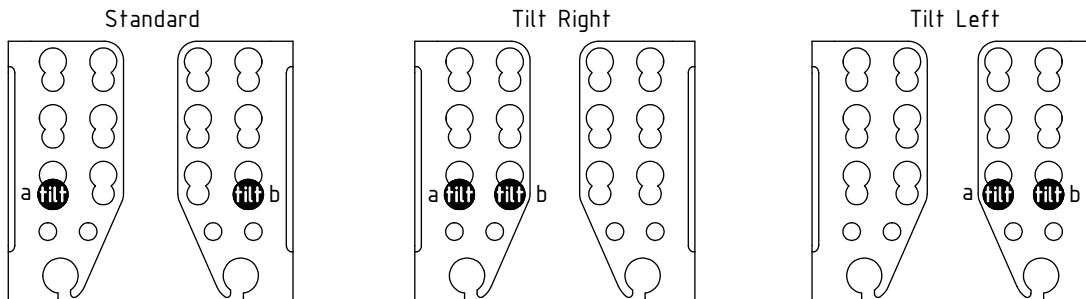

Grab (SG)

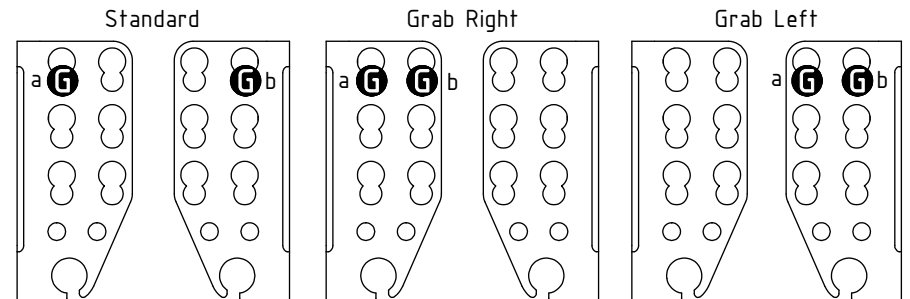

POS	DESCRIPTION	PART	QTY	COMMENTS
14	For FEED 1/2" (Std)			See "Std Top part components"
21	Use washer, adapter, nut: POS.22, 23, 24			QTY depends on config. (2-6)
22	Washer NL 16mm	611044	2	
23	Adapter 1260-06-32 (3/8")	710242	2	
24	Counternut 1270-06 (3/8")	710252	2	
25	Use washer, adapter, nut: POS.26, 27, 28			
26	Washer NL 1/2"	611096	2	
27	Adapter 1260-04-04 (1/4")	710240	2	
28	Counternut 1270-04 (1/4")	710250	2	
Attach feed hoses from control system				(a & b represents channels on feed block)

POS in order of assembly

EC214 QSM - QS60 Top part

- P** = 30
- T** = 30
- cap** = 31
- R** = 33

FEED
Top EC-Oil

ss10

2 hyd. (Std)

4 hyd.

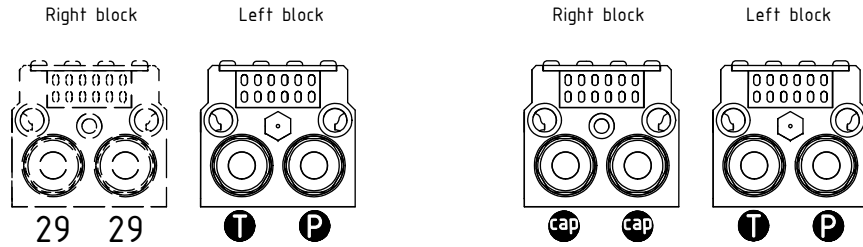

POS	DESCRIPTION	PART	QTY	COMMENTS
29	Plug 70125-08 (1/2")	711500	2	
30	Adapter 4.01-08-08 90° (1/2")	710156	2	QTY depends on config. (2-4)
31	Use adapter, cap: POS.30, 32			
32	Protective cap	711627	2	
33	Adapter 4.01-06-08 90° (3/8"-1/2")	710157	2	
	Attach feed hoses from control system			(a & b represents channels on feed block)

POS in order of assembly

ss9

4 hyd. (Std)

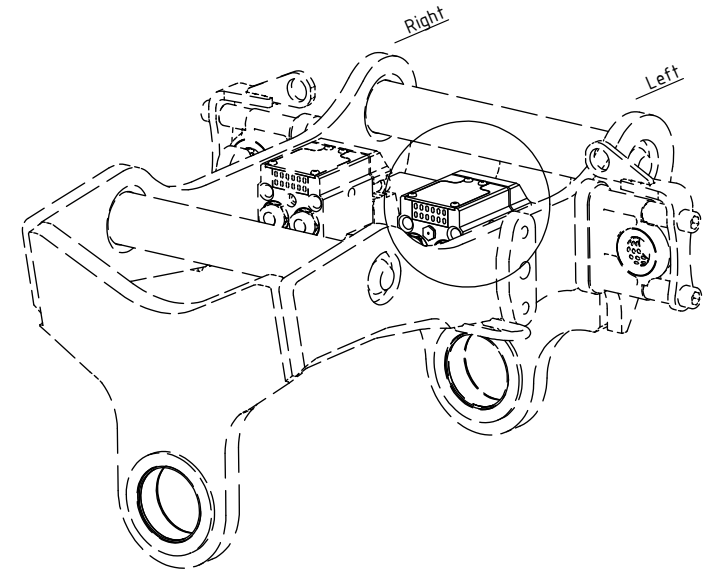
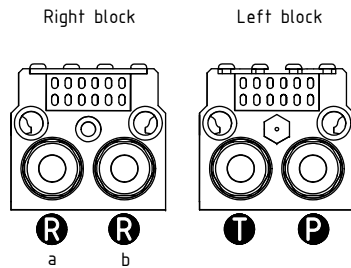

EC214 QSM - QS60 Top part

FEED
3/4"

POS	DESCRIPTION	PART	QTY	COMMENTS
14	For FEED 1/2" (Std)			See "Std Top part components"
	Attach feed hoses from control system			(a & b represents channels on feed block)

POS in order of assembly

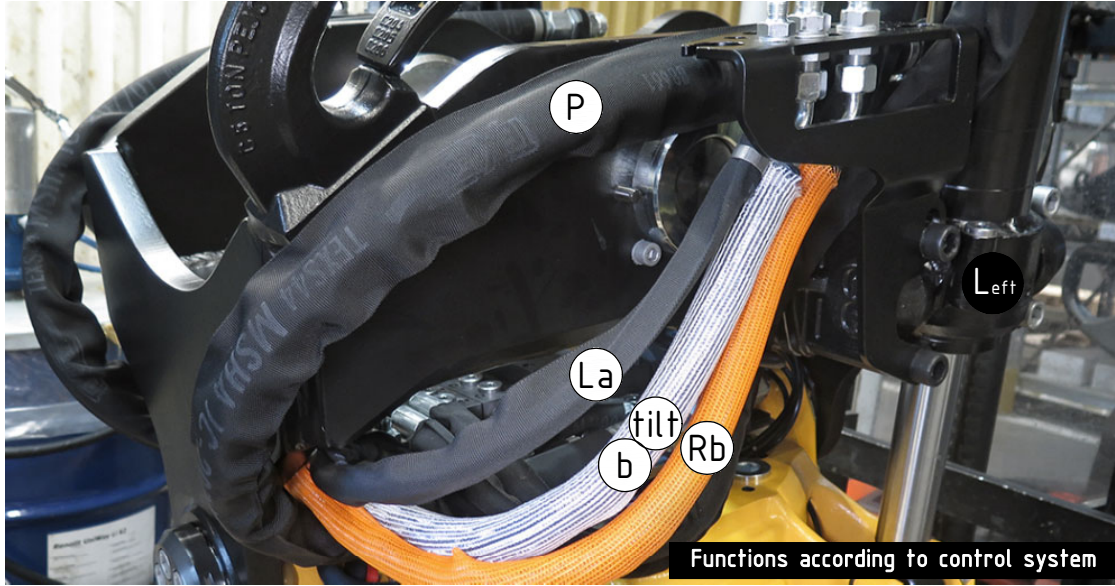

Feed Left:

Photo needed: option Feed Left

Functions according to control system

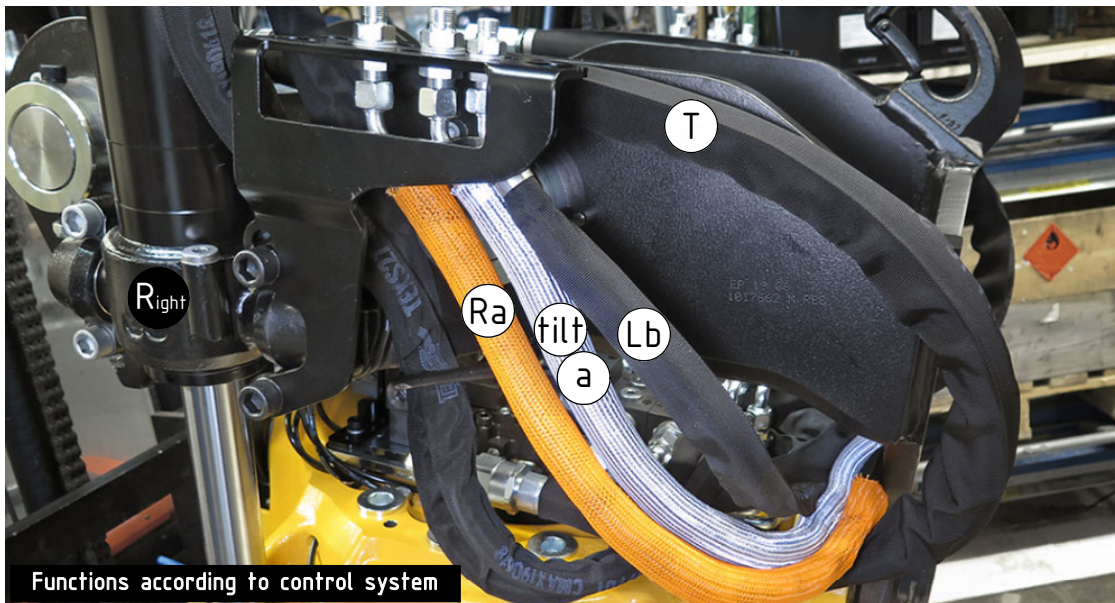

Feed Right:

Photo needed: option Feed Right

Functions according to control system

EC214 QSM - QS60 Top part

FEED
Top EC-Oil
ss5, ss10

POS	DESCRIPTION	PART	QTY	COMMENTS
14	For FEED 1/2" (Std)			See "Std Top part components"
	Attach feed hoses from control system			(a & b represents channels on feed block)

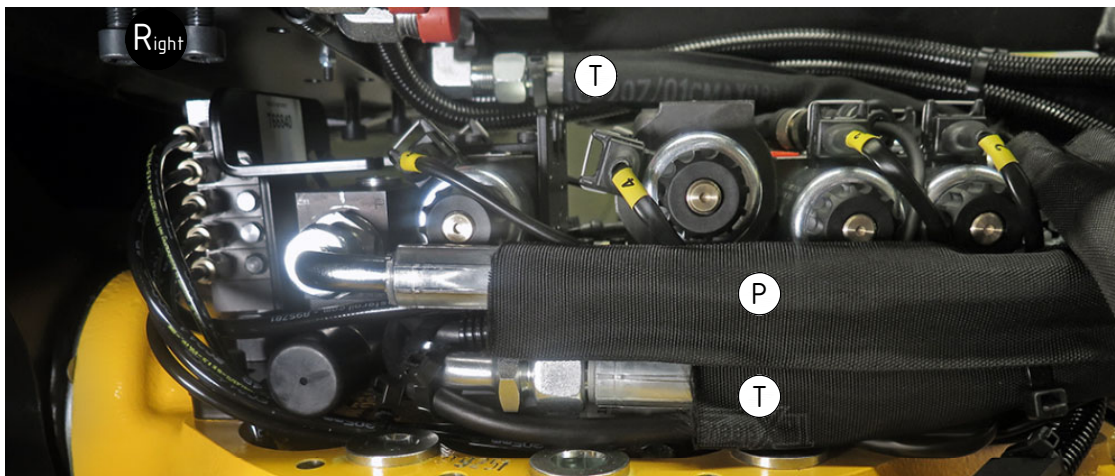
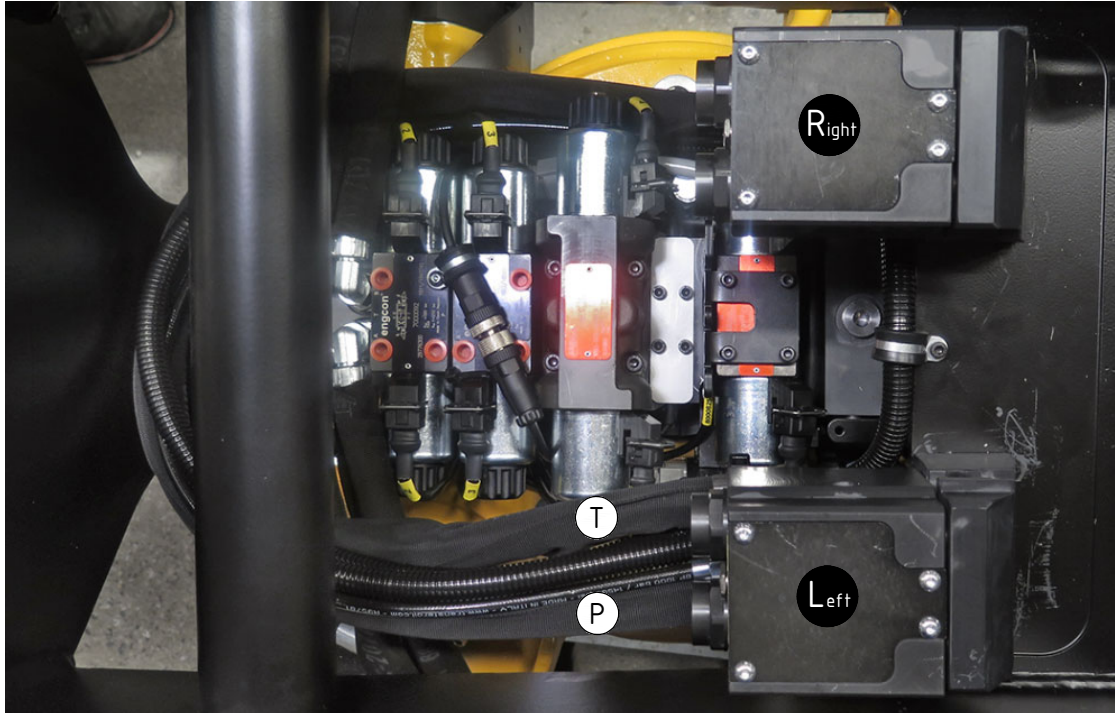

ss9

