

## COVERSHEET

### Planned document changes:

**Briefly:**

---

No planned changes.

### Document changes:

<b>Date:</b>	<b>Change:</b>	<b>Rev. after change:</b>
2023-03-13	Photos added.	B
2020-10-19	Screw lengths corrected. Photos added.	A
2019-09-12	New instruction.	-

# EC219 QSM - QS60 Top part

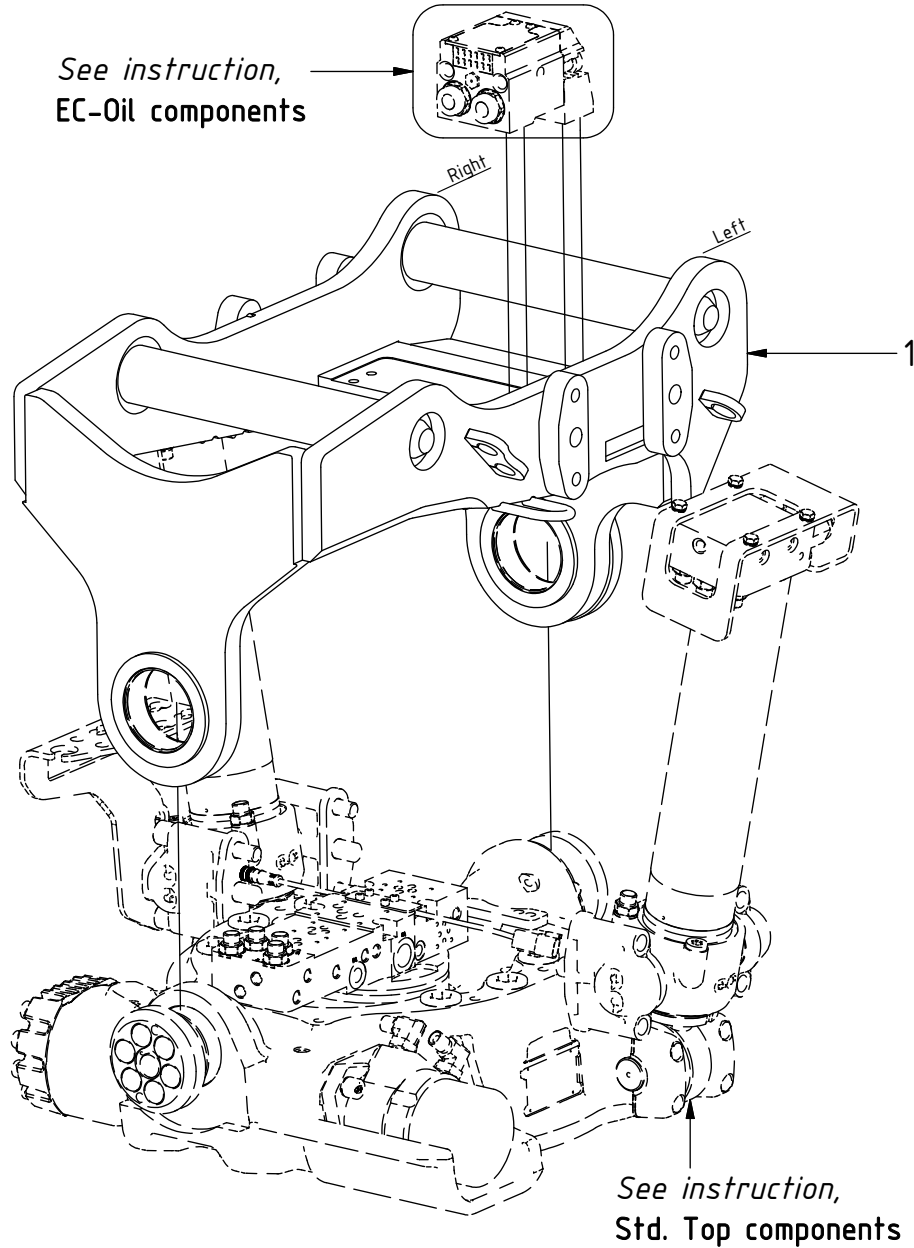

POS	DESCRIPTION	PART	QTY	COMMENTS
1	Top part QS60 EC219S	1064197	1	
2	MC6S M16x100 12.9 ZFSHL	6000156	4	Torque: 333Nm
3	Spacer terminal 28mm	1030616	4	
4	Hose terminal NG10	1027200	2	
5	MC6S M16x140 12.9 ZFSHL	6000152	4	Torque: 333Nm
6	Spacer terminal 20mm	1023777	4	
7	Hose terminal 8-hoses Left V2	1047137	1	
8	Hose terminal 8-hoses Right V2	1047138	1	
9	MC6S M16x130 12.9 ZFSHL	6000154	4	Torque: 333Nm
10	Shim Yoke bracket	1007041	4	For option Shimmed Tilt cylinder
11	MC6S M16x110 12.9 ZFSHL	6000253	4	
12	MC6S M16x150 12.9	610537	4	Torque: 333Nm
33	Screw Cover M16	611302	8	Part of make up

## Option FEED 3/4"

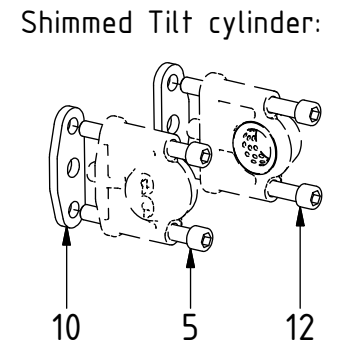
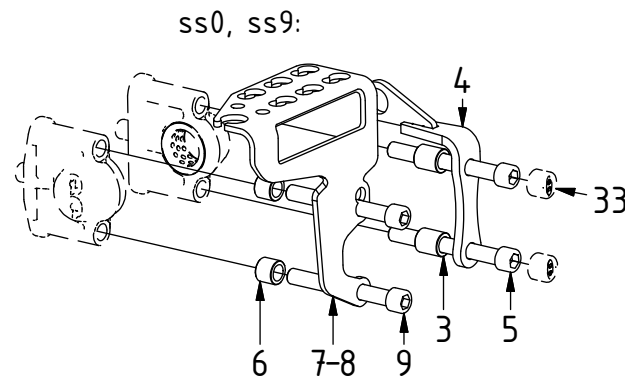
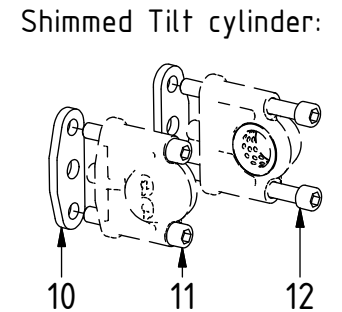
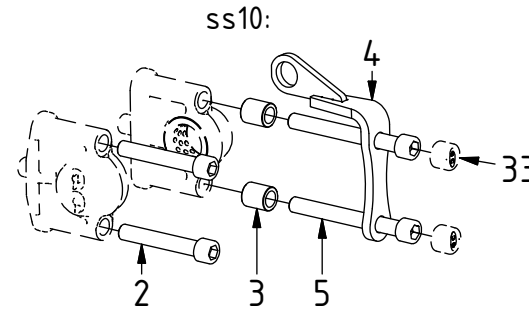

# EC219 QSM - QS60 Top part

**P** = 14

**T** = 14

R, L, tilt, G on p.4

FEED

3/4"

Main Feed

POS	DESCRIPTION	PART	QTY	COMMENTS
13	For FEED 1/2" (Std)			See "Std Top part components"
14	Use washer, adapter, nut: POS.15, 16, 17			QTY depends on config. (2-3)
15	Washer NL 1"	611095	2	
16	Adapter 1260-12-12 (3/4")	712210	2	
17	Counternut 1270-12 (3/4")	712211	2	
18	Hose Bridge Feed Right	7000162	1	
19	Hose Bridge Feed Left	7000161	1	
	Attach feed hoses from control system			(a & b represents channels on feed block)

POS in order of assembly

Standard

Feed Right

Feed Left

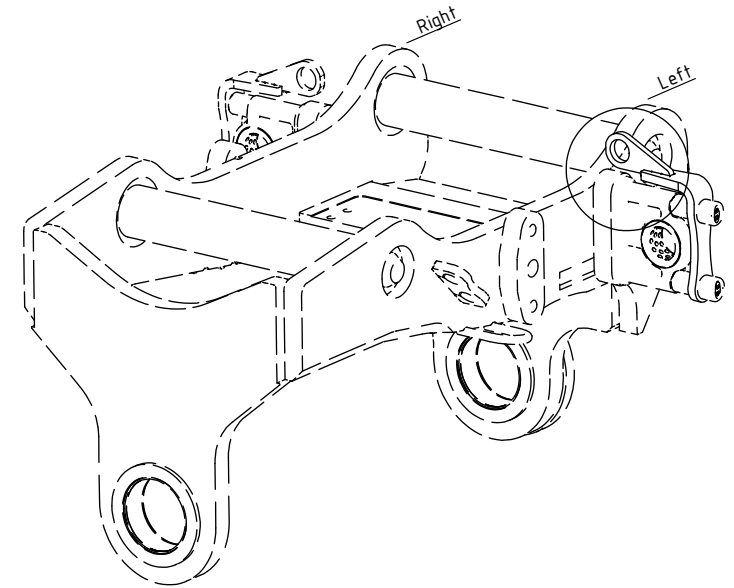
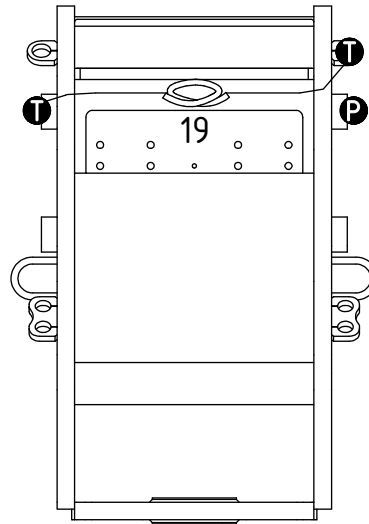
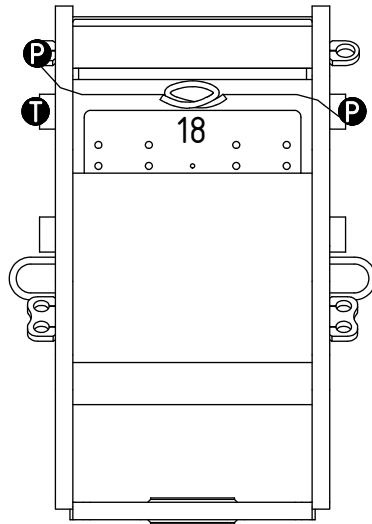
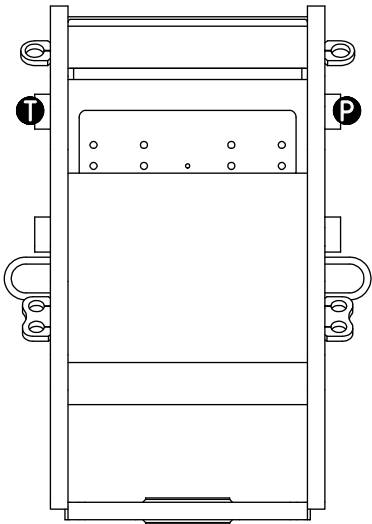

# EC219 QSM - QS60 Top part

**R** = 20

**L** = 24

**filt** = 20

**G** = 20

T, P on p.3

FEED

3/4"

Rotation

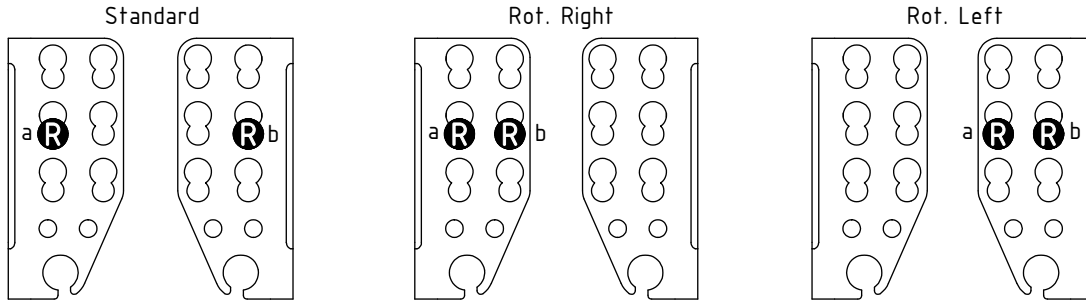

Lock (SQ)

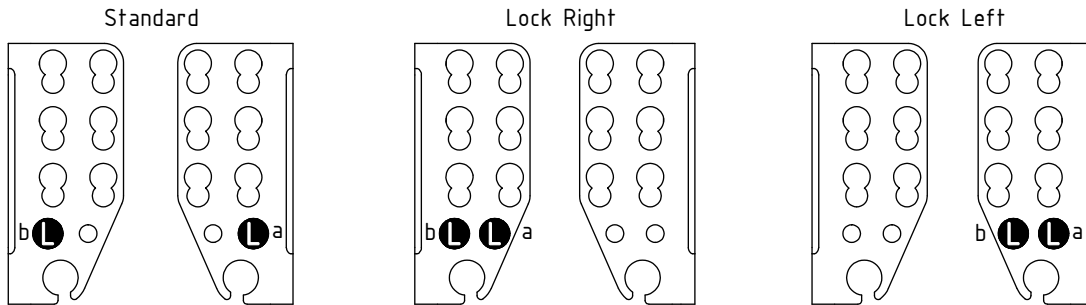

Tilt (ST)

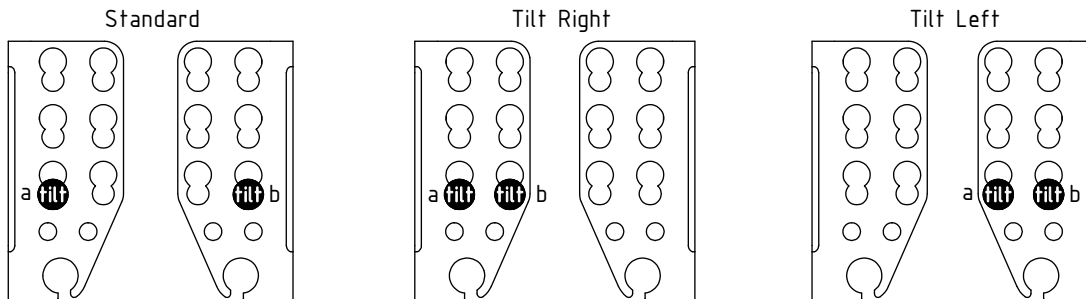

Grab (SG)

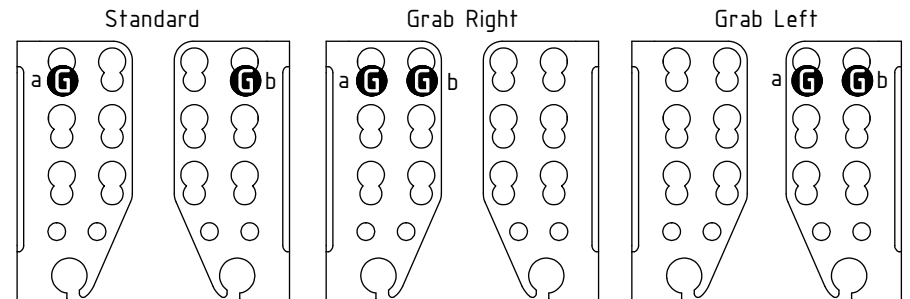

POS	DESCRIPTION	PART	QTY	COMMENTS
13	For FEED 1/2" (Std)			See "Std Top part components"
20	Use washer, adapter, nut: POS.21, 22, 23			QTY depends on config. (2-6)
21	Washer NL 16mm	611044	2	
22	Adapter 1260-06-32 (3/8")	710242	2	
23	Counternut 1270-06 (3/8")	710252	2	
24	Use washer, adapter, nut: POS.25, 26, 27			
25	Washer NL 1/2"	611096	2	
26	Adapter 1260-04-04 (1/4")	710240	2	
27	Counternut 1270-04 (1/4")	710250	2	
Attach feed hoses from control system				(a & b represents channels on feed block)

POS in order of assembly

# EC219 QSM - QS60 Top part

- P** = 29
- T** = 29
- cap** = 30
- R** = 32

## FEED Top EC-Oil

POS	DESCRIPTION	PART	QTY	COMMENTS
29	Adapter 401-08-08 90° (1/2")	710156	6	QTY depends on config. (2-4)
30	Use adapter, cap: POS.29, 31			
31	Protective cap	711627	2	
32	Adapter 401-06-08 90° (3/8"-1/2")	710157	2	
	Attach feed hoses from control system			(a & b represents channels on feed block)

POS in order of assembly

### ss10

2 hyd.

4 hyd.

Left block

Right block

Left block

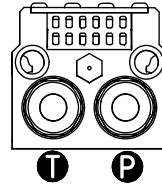
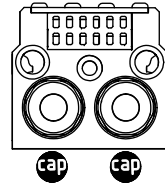
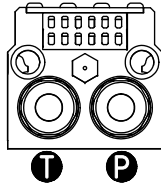

### ss9

4 hyd. (Std)

Right block

Left block

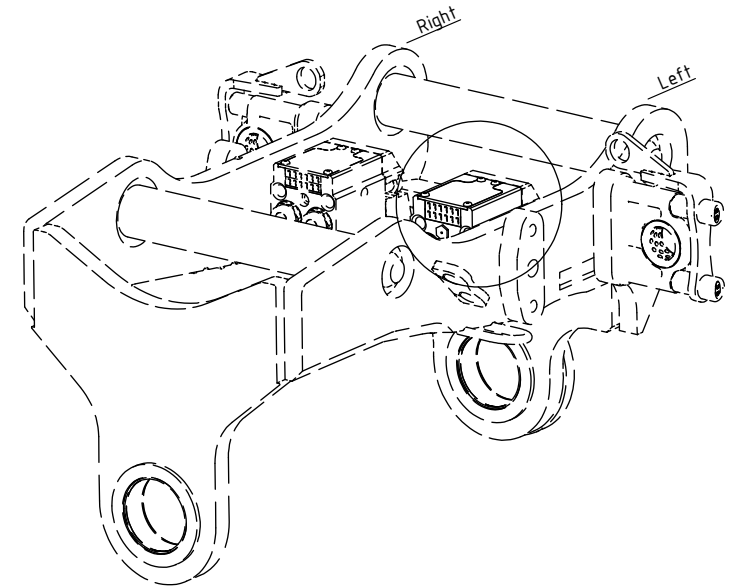
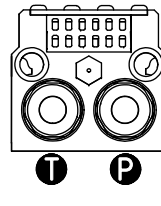
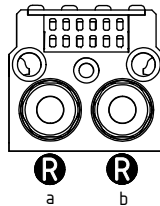

# EC219 QSM - QS60 Top part

FEED  
3/4"

POS	DESCRIPTION	PART	QTY	COMMENTS
13	For FEED 1/2" (Std)			See "Std Top part components"
	Attach feed hoses from control system			(a & b represents channels on feed block)

POS in order of assembly

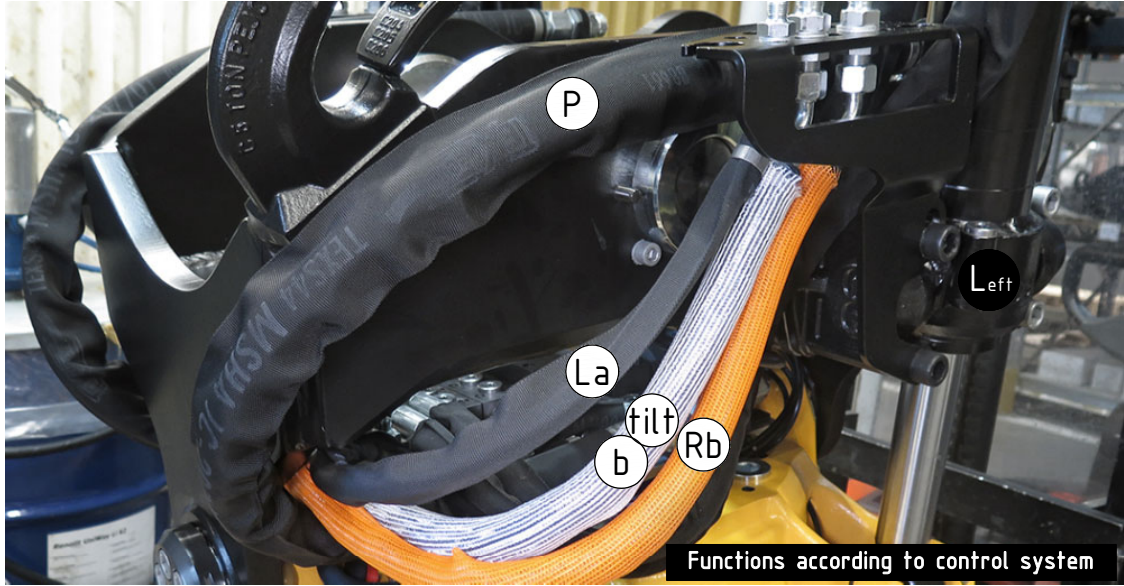

Feed Left:

Photo needed: option Feed Left

Functions according to control system

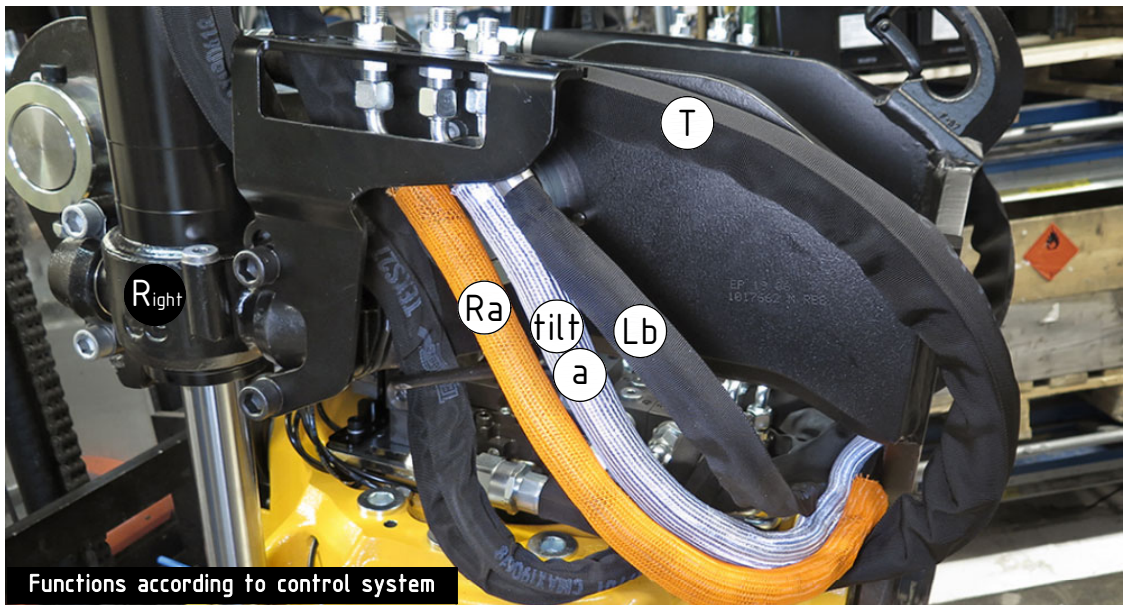

Feed Right:

Photo needed: option Feed Right

Functions according to control system

Dashed lines for overview, mounts on other pages/assemblies. indicates instruction. represents hose.



FEED  
Top EC-Oil  
ss10

POS	DESCRIPTION	PART	QTY	COMMENTS
34	Use cable ties			
	Attach feed hoses from control system			(a & b represents channels on feed block)

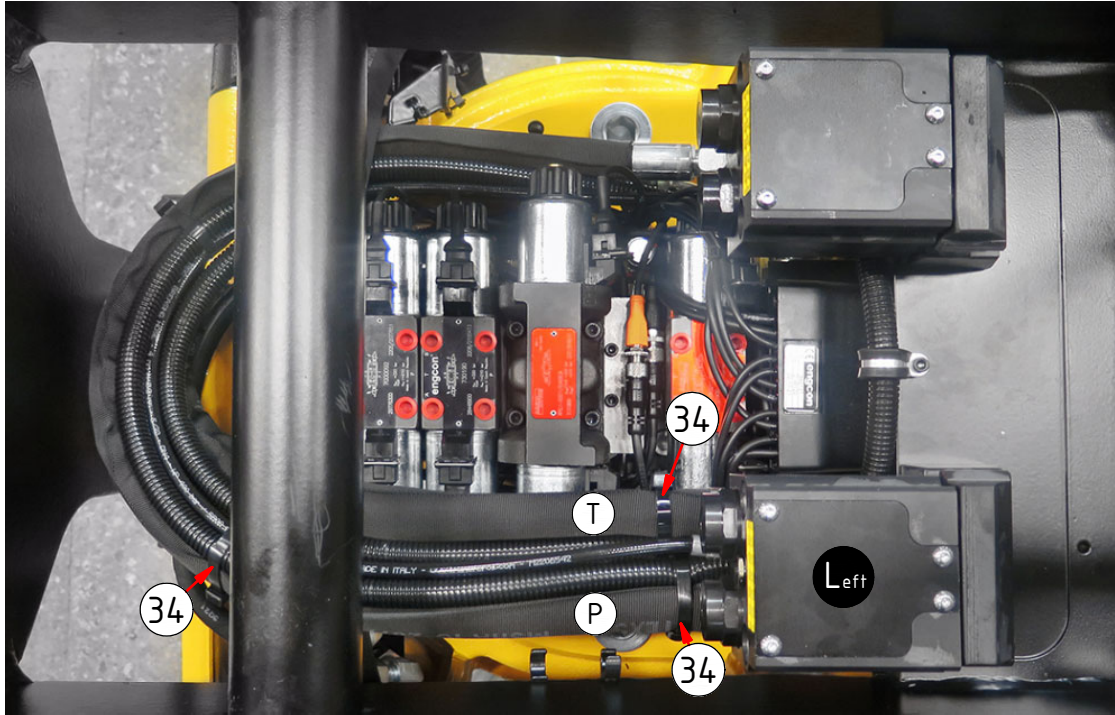

ss9

Photo needed: ss9 from above. T+P and Ra+Rb hoses

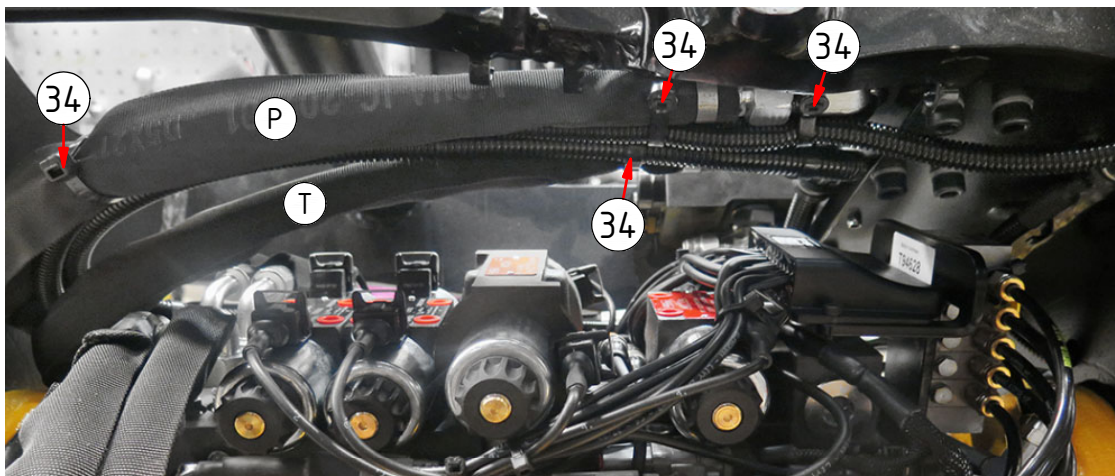

Photo needed: ss9 from the side