

COVERSHEET

Planned document changes:

Briefly:

Replace photos from EC219 to EC214 and from old ECO to ECO W.
Add photos for FEED 1/2".

Document changes:

Date:	Change:	Rev. after change:
2018-11-02	New instruction.	-

EC214 - QS60 Top part

POS	DESCRIPTION	PART	QTY	COMMENTS
1	Top part QS60 EC214	1025866	1	
2	MC6S M16x140	610576	8	Torque: 333Nm
3	Hose terminal Feed ECHF	1027200	2	
4	Spacer terminal 39mm	1005911	8	
5	MC6S M16x90 12.9	610530	4	Only for FEED 1/2" Torque: 333Nm
31	Screw Cover M16	611302	4	

See instruction,
EC-Oil components

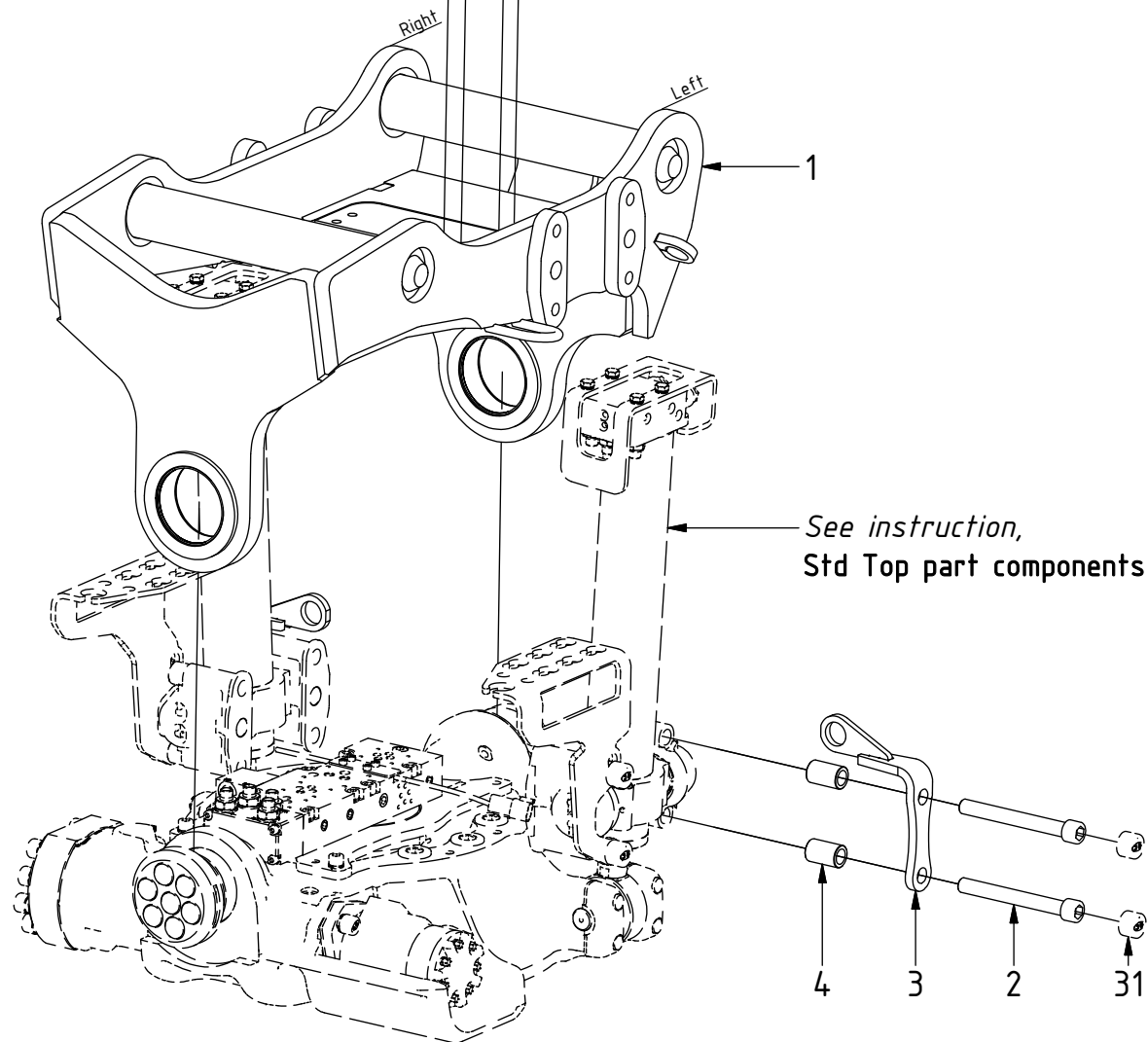
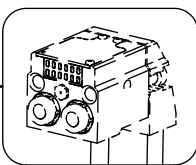

See instruction,
Std Top part components

FEED 1/2":

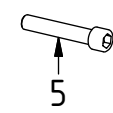

Replaces
POS.2-4

EC214 - QS60 Top part

P = 6
T = 6

FEED:

3/4" (Std)

Main Feed

POS	DESCRIPTION	PART	QTY	COMMENTS
6	Use washer, adapter, nut according to POS.7, 8, 9			
7	Washer NL 1"	611095	2	QTY: 3 for Feed R / Feed L
8	Adapter 1260-12-12 (3/4")	712210	2	QTY: 3 for Feed R / Feed L
9	Check nut 1270-12 (3/4")	712211	2	QTY: 3 for Feed R / Feed L
10	Hose Bridge All Right	743011	1	
11	Hose Bridge All Left	743012	1	
29	Attach feed hoses from control system			(a & b represents channels on feed block)

POS in order of assembly

Standard

Feed Right

Feed Left

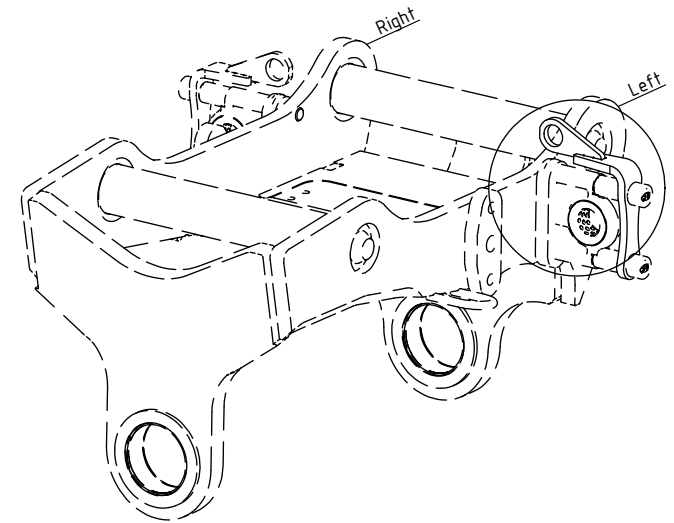
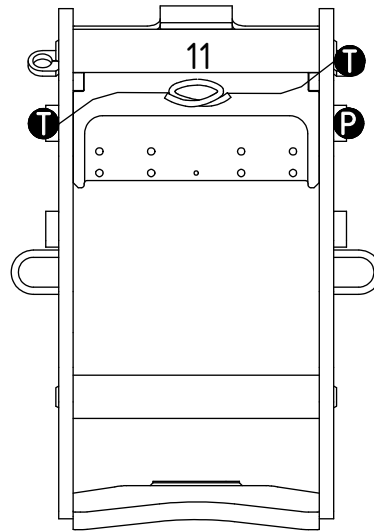
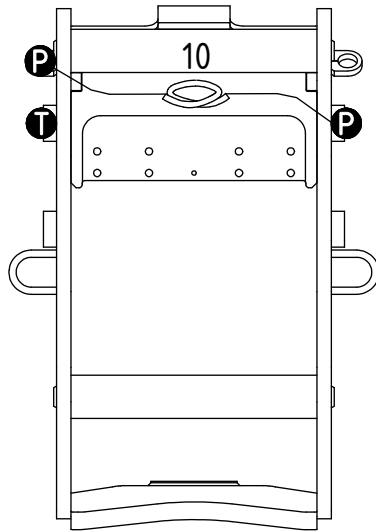
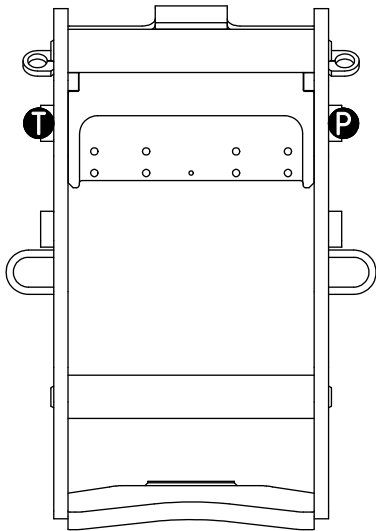

- P** = 12
- T** = 12
- R** = 16
- L** = 20
- filtr** = 16

FEED:

1/2"

Main Feed

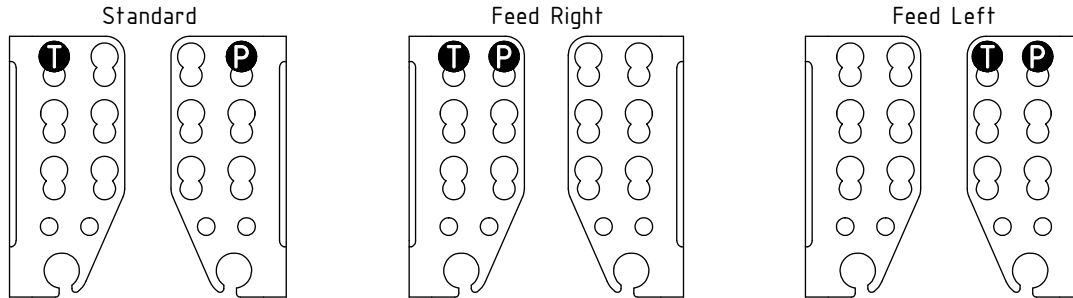

Rotation

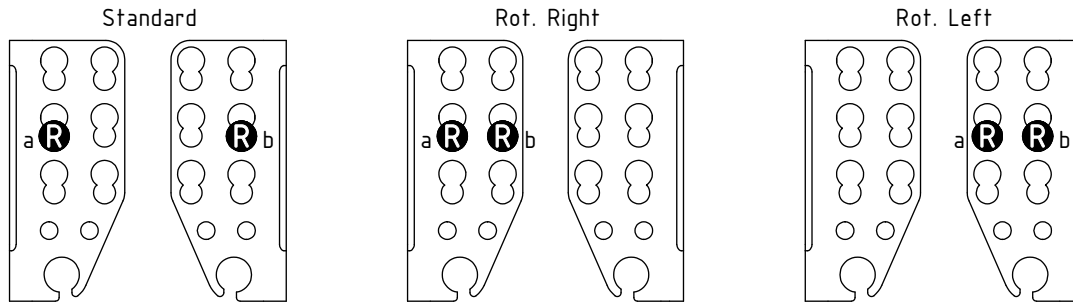

Lock (SQ)

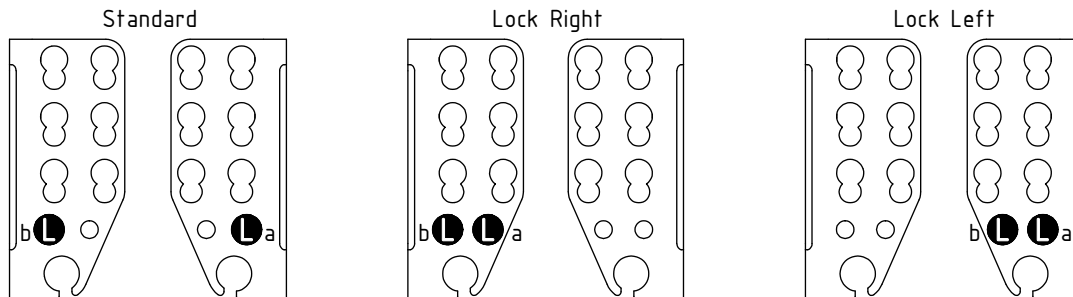

Tilt (ST)

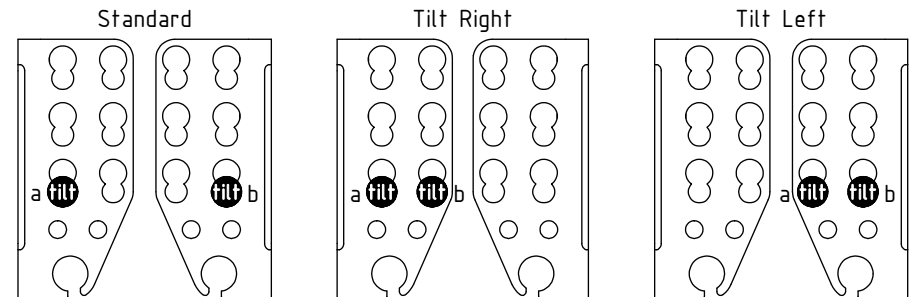

POS	DESCRIPTION	PART	QTY	COMMENTS
12	Use washer, adapter, nut according to POS.13, 14, 15			
13	Washer NL 20mm	611098	2	
14	Adapter 1260-08-08 (1/2")	710244	2	
15	Check nut 1270-08 (1/2")	710254	2	
16	Use washer, adapter, nut according to POS.17, 18, 19			QTY depends on terminal holes (2-4)
17	Washer NL 16mm	611044	2	
18	Adapter 1260-06-32 (3/8")	710242	2	
19	Check nut 1270-06 (3/8")	710252	2	
20	Use washer, adapter, nut according to POS.21, 22, 23			
21	Washer NL 1/2"	611096	2	
22	Adapter 1260-04-04 (1/4")	710240	2	
23	Check nut 1270-04 (1/4")	710250	2	
29	Attach feed hoses from control system			(a & b represents channels on feed block)

POS in order of assembly

EC214 - QS60 Top part

- P** = 25
- T** = 25
- cap** = 26
- R** = 28

FEED:
Top EC-Oil

ss5, ss10

Standard

Option 4 Hyd.
2Bl.Feed

Option 4 Hyd.

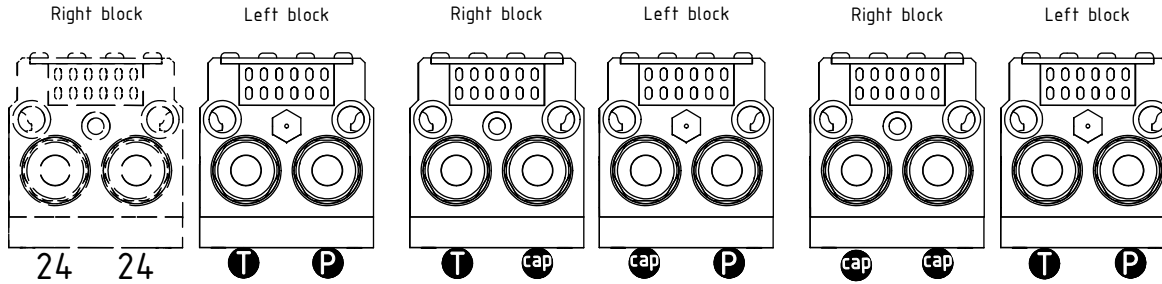

ss9

Standard

2Bl.Feed

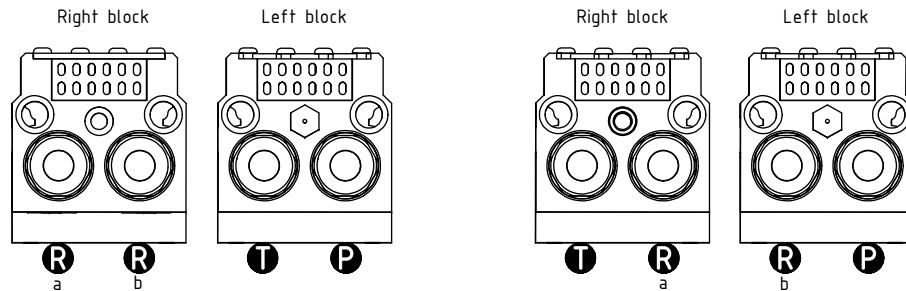

POS	DESCRIPTION	PART	QTY	COMMENTS
24	Plug 70125-08 (1/2")	711500	2	
25	Adapter 401-08-08 (1/2")	710156	2	QTY depends on config. (2-4)
26	Use adapter, cap according to POS.25, 27			
27	Protective cap	711627	2	Not for SX
28	Adapter 401-06-08 (3/8"-1/2")	710157	2	
29	Attach feed hoses from control system			(a & b represents channels on feed block)

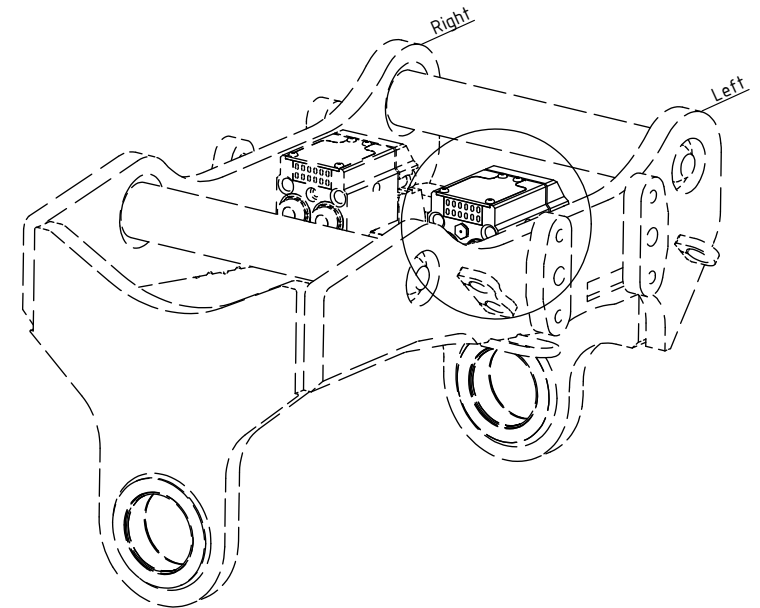

EC214 - QS60 Top part

FEED:
3/4" (Std)

POS	DESCRIPTION	PART	QTY	COMMENTS
10	Hose Bridge All Right	743011	1	
11	Hose Bridge All Left	743012	1	
29	Attach feed hoses from control system			(a & b represents channels on feed block)
30	Cable tie 7,8x360	1021587	3	QTY:2 for EC-Oil

POS in order of assembly

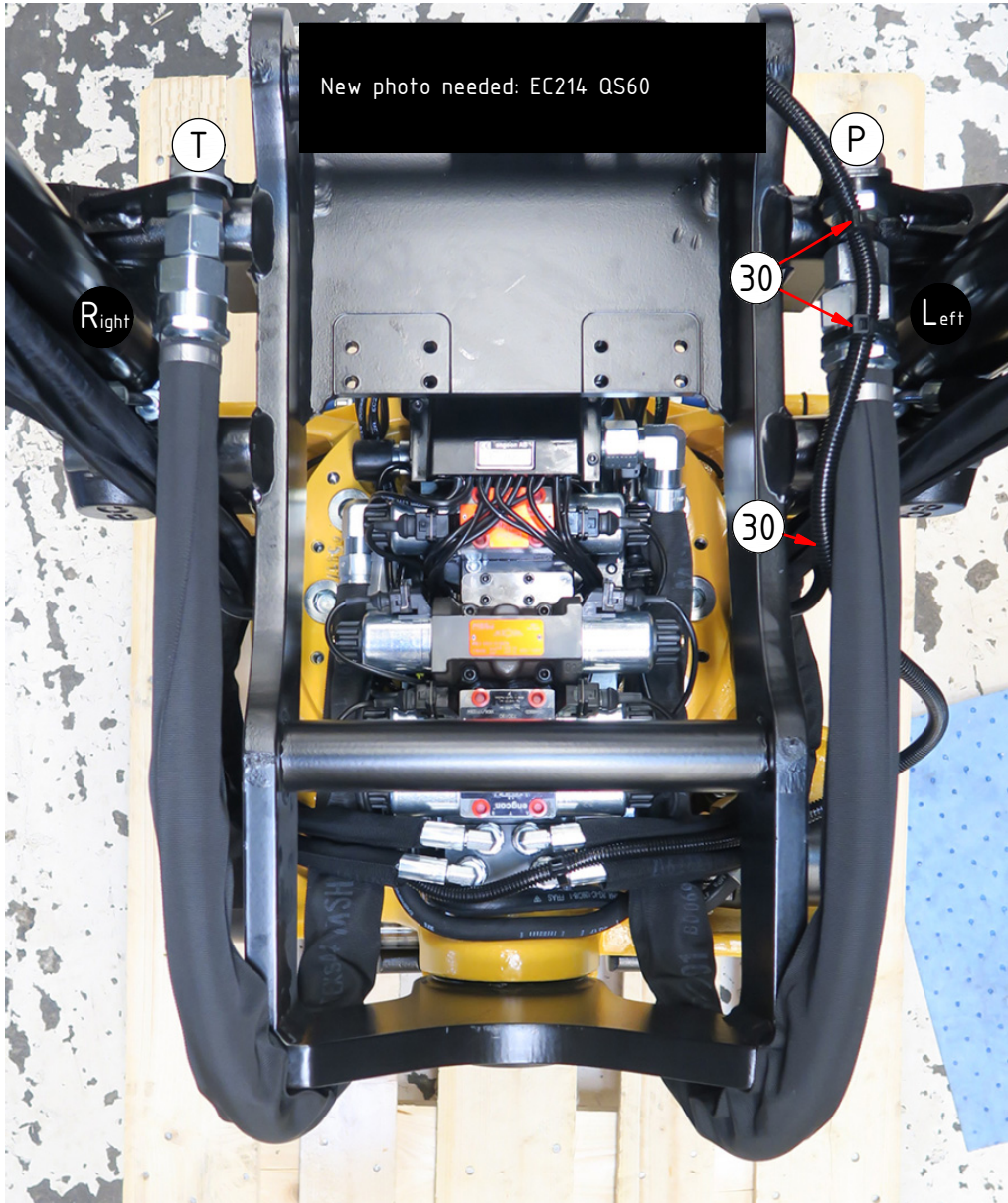

Feed Left:

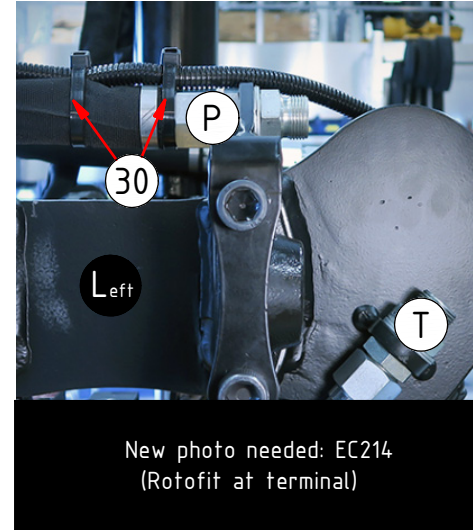

Feed Right:

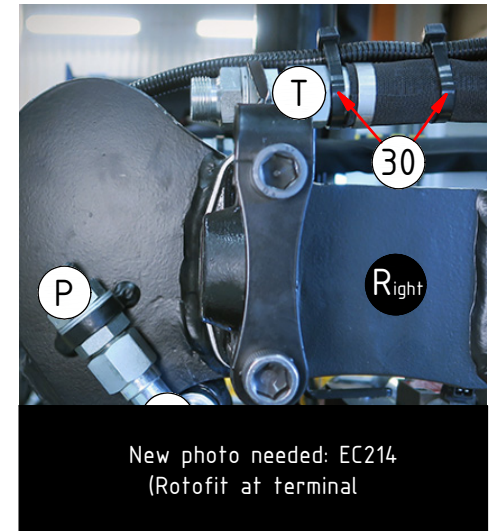
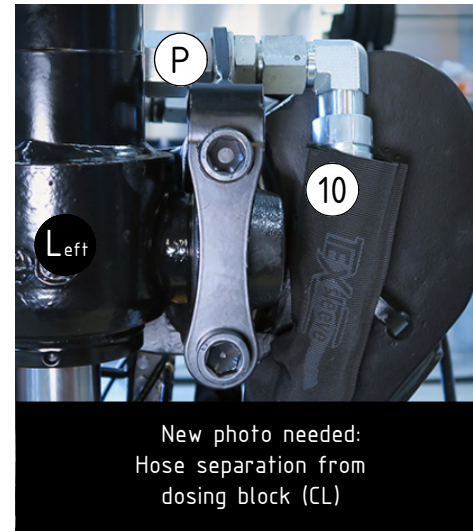

EC214 - QS60 Top part

FEED:

1/2"



POS	DESCRIPTION	PART	QTY	COMMENTS
29	Attach feed hoses from control system			(a & b represents channels on feed block)
30	Cable tie 7,8x360	1021587	3	QTY:2 for EC-Oil

Feed Left:



Feed Right:



EC214 - QS60 Top part

FEED:
 Top EC-Oil
 DC2
 Standard

POS	DESCRIPTION	PART	QTY	COMMENTS
29	Attach feed hoses from control system			(a & b represents channels on feed block)
30	Cable tie 7,8x360	1021587	3	QTY:2 for EC-Oil

2BL.Feed

Photo needed:
 EC-Oil DC2 Standard

Contact Documentation
 when built

Photo needed:
 EC-Oil DC2 2BL.Feed

Contact Documentation
 when built

EC214 - QS60 Top part

FEED:
Top EC-Oil
ss9
Standard

POS	DESCRIPTION	PART	QTY	COMMENTS
29	Attach feed hoses from control system			(a & b represents channels on feed block)
30	Cable tie 7,8x360	1021587	3	QTY:2 for EC-Oil

2BL.Feed

Photo needed:
EC-Oil ss9 Standard

Contact Documentation
when built

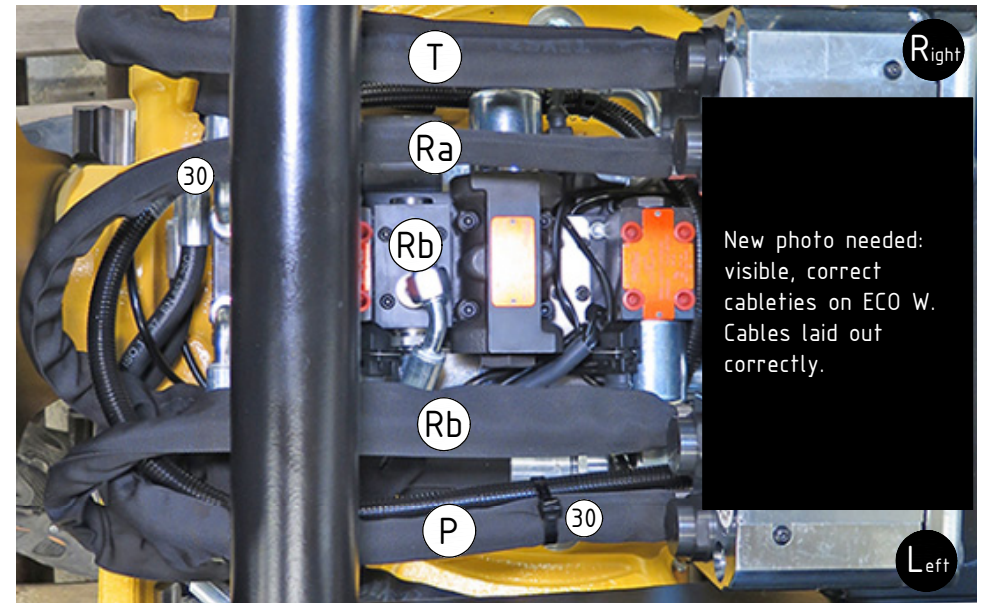

POS in order of assembly

FEED:
 Top EC-Oil
 ss10 (SVAB)
 Standard

POS	DESCRIPTION	PART	QTY	COMMENTS
29	Attach feed hoses from control system			(a & b represents channels on feed block)
30	Cable tie 7,8x360	1021587	3	QTY:2 for EC-Oil

2BL.Feed

Photo needed:
 EC-Oil ss10 Standard

Contact Documentation
 when built

