

# SPARE PARTS

# Tilt cylinder EC233

Drawing No: 1040002

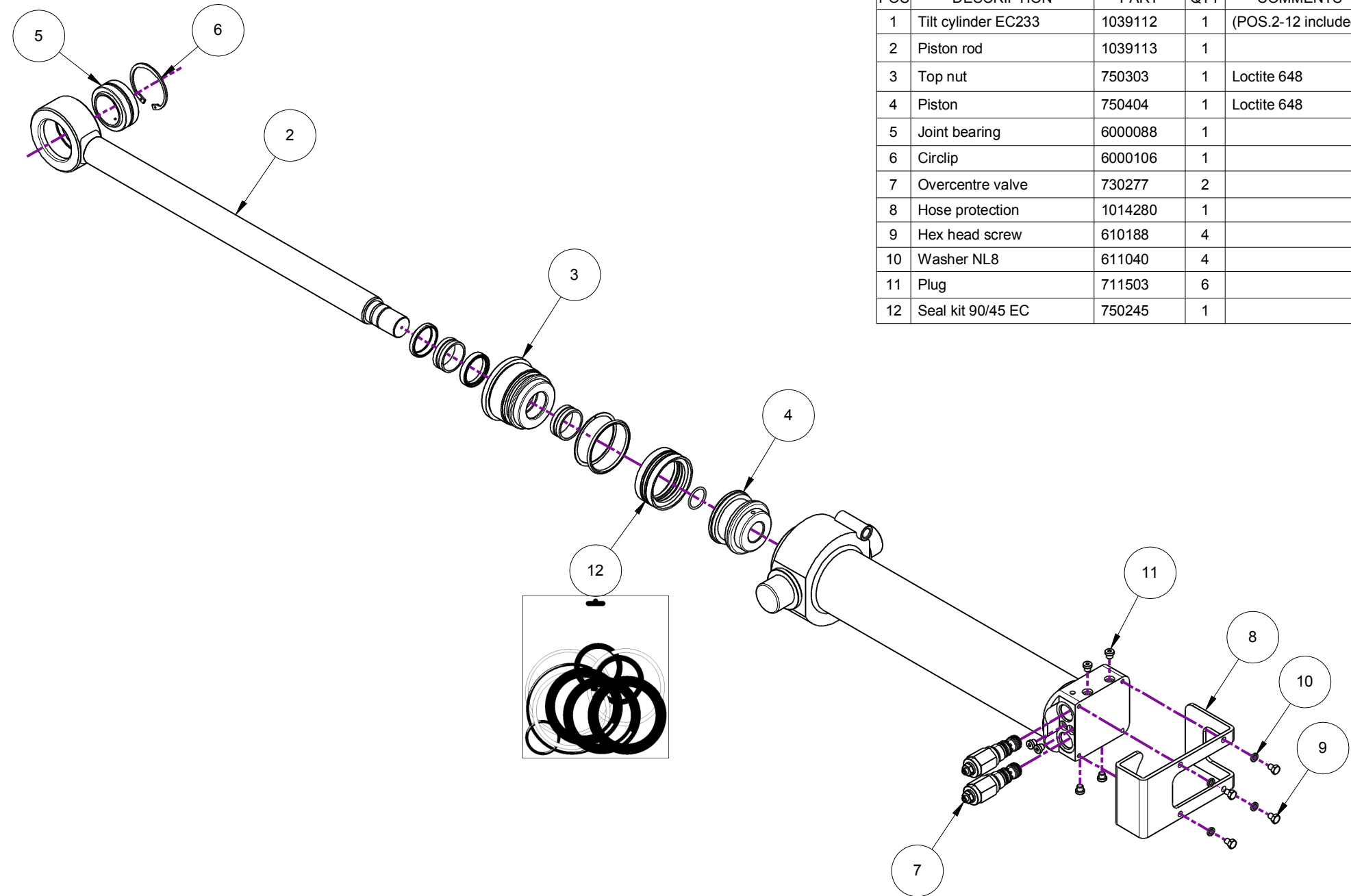

POS	DESCRIPTION	PART	QTY	COMMENTS
1	Tilt cylinder EC233	1039112	1	(POS.2-12 included)
2	Piston rod	1039113	1	
3	Top nut	750303	1	Loctite 648
4	Piston	750404	1	Loctite 648
5	Joint bearing	6000088	1	
6	Circlip	6000106	1	
7	Overcentre valve	730277	2	
8	Hose protection	1014280	1	
9	Hex head screw	610188	4	
10	Washer NL8	611040	4	
11	Plug	711503	6	
12	Seal kit 90/45 EC	750245	1	